

**PHASE I ENVIRONMENTAL SITE ASSESSMENT
PROPOSED NEVADA STATE COLLEGE PROPERTY
PAHRUMP, NEVADA
NYE COUNTY PARCEL 4701101**

PREPARED FOR:

Mr. Charlie Rodewald
Nye County
P.O. Box 153
Tonopah, Nevada 89049

PREPARED BY:

Ninyo & Moore
Geotechnical and Environmental Sciences Consultants
3155 East Patrick Lane, Suite 12
Las Vegas, Nevada 89120

June 21, 2004
Project No. 301437001

June 21, 2004
Project No. 301437001

Mr. Charlie Rodewald
Nye County Grants Administration
P.O. Box 153
Tonopah, Nevada 89049

Subject: Phase I Environmental Site Assessment
Proposed Nevada State College Property
Pahrump, Nevada
Nye County Parcel 4701101

Dear Mr. Rodewald:

In accordance with your request, Ninyo & Moore has performed a Phase I Environmental Site Assessment of the above-referenced site. The attached report presents our methodology, findings, opinions, and conclusions regarding the environmental conditions at the site.

We appreciate the opportunity to be of service to you on this project. Should you have any questions, please contact the undersigned at your convenience.

Sincerely,
NINYO & MOORE



Cynthia J. Bogdan
Project Environmental Scientist



Robert M. Troisi, C.E.M.
Managing Principal of Environmental Sciences

CJB/RMT/ltk

Distribution: (2) Addressee
(2) MaryEllen Giampaoli

TABLE OF CONTENTS

	<u>Page</u>
EXECUTIVE SUMMARY	ES-1
1. INTRODUCTION	1
1.1. Purpose	1
1.2. Involved Parties	1
1.3. Scope of Work	1
1.4. Limitations and Exceptions	2
1.5. User Reliance	3
2. PROPERTY DESCRIPTION	3
2.1. Property Location and Description	3
2.2. Current Property Uses/Operations	4
2.2.1. Site Description	4
2.2.2. Occupants	4
2.2.3. Heating and Cooling Systems	4
2.2.4. Sewage Disposal/Septic Systems	4
2.2.5. Potable Water	5
2.3. Adjacent Properties	5
3. PHYSICAL SETTING	5
3.1. Site Topography	5
3.2. Site Geology	5
3.3. Site Hydrology	6
4. HISTORICAL LAND USE	6
4.1. Historical Aerial Photographs	7
4.2. Fire Insurance Maps	7
4.3. Historical Topographic Maps	7
4.4. Interviews	7
4.5. Previous Reports and Documents	8
5. ENVIRONMENTAL DATABASE SEARCH	8
6. SITE RECONNAISSANCE	11
6.1. Physical Limitations	11
6.2. Use and Storage of Hazardous Substances and Petroleum Products	11
6.3. Storage and Disposal of Hazardous Wastes	11
6.4. Unidentified Substance Containers	11
6.5. Aboveground and Underground Storage Tanks	12
6.6. Evidence of Releases	12
6.7. Polychlorinated Biphenyls (PCBs)	12
6.8. Wastewater Systems	12
6.9. Storm Water Systems	12
6.10. Wells	12

6.11. Additional Issues12

7. FINDINGS, OPINIONS, AND CONCLUSIONS13

7.1. Findings and Opinions.....13

7.2. Conclusions.....13

8. NEVADA CERTIFIED ENVIRONMENTAL MANAGER14

9. SELECTED REFERENCES15

Tables

Table 1 – Aerial Photographs Reviewed7

Table 2 – Aerial Photograph Summary7

Table 3 – Summary of Environmental Database Search8

Figures

- Figure 1 – Site Location Map
- Figure 2 – Site Map

Appendices

- Appendix A – Site Photographs
- Appendix B – Nye County Assessor Parcel Information
- Appendix C – Historical Topographic Map
- Appendix D – Well Log Database
- Appendix E – Environmental Database Search

EXECUTIVE SUMMARY

Ninyo & Moore was retained by Nye County to perform a Phase I Environmental Site Assessment (ESA) of an approximately 280-acre portion of an approximately 320-acre parcel (Nye County Parcel #4701101) selected as the proposed site for a Nevada State College campus. The subject site is located on the northern half of Section 2, Township 21 South, Range 54 East in Pahrump, Nye County, Nevada. Historical research, document review, and site assessment activities were conducted during the week of January 26, 2004.

In summary, the following items were noted:

- The subject site consists of an approximately 280-acre portion of an approximately 320-acre parcel bisected by Carpenter Canyon Road. The subject site is undeveloped except for a Bureau of Land Management Fire Station located in the northwest quadrant of the site.
- Based on a review of historical sources, the portion of parcel #4701101 that comprises the subject site has not previously been developed.
- Review of environmental databases indicated that no facilities in the vicinity of the subject site have handled hazardous materials or waste and/or have been listed as having reported releases of hazardous substances or petroleum products. The subject site was not listed.

This Phase I ESA was performed in conformance with the scope and limitations of the American Society for Testing and Materials Practice E 1527-00. Any exceptions to or deletions from this practice are described in Section 6.1 of this report. This assessment has revealed no evidence of recognized environmental conditions in connection with the property at this time.

1. INTRODUCTION

Ninyo & Moore was retained by Nye County to perform a Phase I Environmental Site Assessment (ESA) of an approximately 280-acre portion of an approximately 320-acre parcel (Nye County Parcel #4701101) selected as the proposed site for a Nevada State College campus. The subject site is located in the northern half of Section 2, Township 21 South, Range 54 East in Pahrump, Nye County, Nevada (hereinafter referred to as the site, subject site, or subject property). The following sections identify the purpose, the involved parties, the scope of work, and the limitations and exceptions associated with the ESA.

1.1. Purpose

In accordance with the American Society for Testing and Materials (ASTM) Standards on Environmental Site Assessments for Commercial Real Estate E 1527-00, the objective of the ESA is to identify recognized environmental conditions, which are defined by ASTM as “the presence or likely presence of any hazardous substance or petroleum products on a property under conditions that indicate an existing release, a past release, or a material threat of a release of any hazardous substances or petroleum products into structures on the property or into the ground, groundwater, or surface water of the property.”

1.2. Involved Parties

Ms. Cynthia Bogdan and Mr. Mark Porterfield of Ninyo & Moore conducted the site reconnaissance on January 27, 2004, and performed regulatory inquiries. Mr. Robert M. Troisi of Ninyo & Moore performed project oversight and quality review.

1.3. Scope of Work

Ninyo & Moore’s scope of work for this Phase I ESA included the following:

- Performance of a site reconnaissance to visually identify areas of possibly contaminated surficial soil or surface water, improperly stored hazardous materials, possible sources

of polychlorinated biphenyls (PCBs), and possible risks of contamination from activities at the site and adjacent properties.

- Review of readily available local regulatory agency files for the site.
- Review of available regulatory agency databases for the site and for properties located within a specified radius of the site. The purpose of this review was to evaluate the possible environmental impact to the site. These databases list locations of known hazardous waste sites, landfills, and leaking underground storage tanks (USTs), permitted facilities that utilize USTs, and facilities that use, store, or dispose of hazardous materials.
- Review of readily available historical documents, including aerial photographs, historical fire insurance rate maps, and city directories, as necessary.
- Preparation of this Phase I ESA report documenting findings and providing opinions and conclusions regarding possible environmental impacts at the site.

1.4. Limitations and Exceptions

The environmental services described in this report have been conducted in general accordance with current regulatory guidelines and the standard of care exercised by environmental consultants performing similar work in the project area. No other warranty, expressed or implied, is made regarding the professional opinions presented in this report. Please note that this study did not include an evaluation of geotechnical conditions or potential geologic hazards. In addition, it should be noted that this Phase I ESA does not include analysis of the following: asbestos-containing material (ACM), methane gas, radon, lead-based paint, lead in drinking water, wetlands, regulatory compliance, cultural and historic resources, industrial hygiene, health and safety, ecological resources, endangered species, indoor air quality, and high voltage power lines.

This document is intended to be used only in its entirety. No portion of the document, by itself, is designed to completely represent any aspect of the project described herein. Ninyo & Moore should be contacted if the reader requires any additional information or has questions regarding the content, interpretations presented, or completeness of this document.

The findings and conclusions are based on an analysis of the observed site conditions and the referenced literature. It should be understood that the conditions of a site could change with time as a result of natural processes or the activities of man at the subject site or nearby sites. In addition, changes to the applicable laws, regulations, codes, and standards of practice may occur due to government action or the broadening of knowledge. The findings of this report may, therefore, be invalidated over time, in part or in whole, by changes over which Ninyo & Moore has no control. Ninyo & Moore cannot warrant or guarantee that not finding indicators of any particular hazardous material means that this particular hazardous material or any other hazardous materials do not exist on the site. Additional research, including invasive testing, can reduce the uncertainty, but no techniques now commonly employed can eliminate the uncertainty altogether.

1.5. User Reliance

This report may be relied upon and is intended exclusively for Nye County (client). Any use or reuse of the findings, opinions, and/or conclusions of this report by parties other than the client is undertaken at said parties' sole risk.

2. PROPERTY DESCRIPTION

2.1. Property Location and Description

The subject property consists of an approximately 280-acre portion of the following parcel.

APN 4701101 – This parcel comprises approximately 320 acres located 0.75 miles northeast of Highway 160, between Jeane Avenue to the south and Gamebird Road to the north. Property usage consists of vacant land as well as a Bureau of Land Management (BLM) Fire Station located in the northwest quarter of the parcel. The subject site is located in Section 2, Township 21 South, Range 54 East, Pahrump, Nye County, Nevada.

The site location is presented on Figure 1. Additional information concerning the site and surrounding properties is presented on Figure 2. Photographs taken during the site reconnaissance are presented in Appendix A. A copy of the Nye County Assessor parcel information is included in Appendix B.

2.2. Current Property Uses/Operations

The following paragraphs present a description of the structures present at the site, any tenants currently occupying the site, the activities being conducted on site, the heating and cooling systems utilized in any site buildings, the sewage disposal system, and the potable water provider for the site.

2.2.1. Site Description

The subject property is composed primarily of undeveloped desert land. Vegetation on the subject site is characteristic of undisturbed land, consisting primarily of brush and scattered small trees. A small dry wash is located adjacent to an unpaved Carpenter Canyon Road that runs through the center of the subject property. The BLM has a fire station located in the northwest quarter of the parcel, which was not part of this ESA.

2.2.2. Occupants

The subject property is unoccupied except for a BLM fire station located in the northwest quarter of the parcel.

2.2.3. Heating and Cooling Systems

The subject property is undeveloped and has no structures.

2.2.4. Sewage Disposal/Septic Systems

The subject property is undeveloped and is not connected to a municipal sewage system or a septic system.

2.2.5. Potable Water

The subject property is undeveloped and is not connected to a drinking water distribution network.

2.3. Adjacent Properties

Gamebird Road borders the subject property to the north, across which is undeveloped land. Approximately 4 miles to the south Jeane Avenue borders the subject property, across which is undeveloped land. Mae Street borders the subject property to the east, across which is undeveloped land. Eberhard Road borders the subject property to the west, across which is undeveloped land. All of the above mentioned roads are unpaved.

3. PHYSICAL SETTING

The following sections include discussions of topographic, geologic, and hydrogeologic conditions in the vicinity of the site, based upon the document review and visual reconnaissance of the site and adjacent areas.

3.1. Site Topography

The United States Geological Survey (USGS) Pahrump, Nevada, 7.5-minute series topographic map, provisional edition 1984, shows the site to be at an elevation of approximately 3,200 feet above mean sea level with drainage of the site generally toward the southwest. A copy of the topographic map is included in Appendix C.

3.2. Site Geology

The Pahrump Valley is a structural basin of late Mesozoic and Tertiary age block faulting origin (beginning about 100 million years ago). Deposits in the Pahrump Valley are mainly Tertiary age (from 67 to 2 million years old) and Quaternary Age (from 2 million years old to the present) unconsolidated sediments derived from the surrounding uplifted mountain ranges, which are composed of sedimentary and igneous rocks. The mountains to the north,

4.1. Historical Aerial Photographs

Historical aerial photographs were available and reviewed for the site and surrounding areas. A listing of the photographs reviewed is presented in Table 1. Table 2 summarizes notable observations from each photograph.

Table 1 – Aerial Photographs Reviewed

Date	Photograph Identification	Scale	Source
1984	P-48 & P-49	1 = 36,000	A
1984	10-9, 10-10 & 10-11	1 = 14,400	A
1994	6-3 & 7-3	1 = 24,000	A
Sources: A – Continental Aerial Photo, Inc. B – Nye County GIS Website			

Table 2 – Aerial Photograph Summary

Year	Aerial Photograph Description
1984	The subject property is composed of undeveloped desert land. Vegetation on the subject site is characteristic of undisturbed land, consisting primarily of brush and scattered small trees. A dry wash bed runs from the east across the parcel. The surrounding land is undeveloped desert.
1994	No significant changes since 1984.

4.2. Fire Insurance Maps

There was no Sanborn fire insurance map coverage for the subject site.

4.3. Historical Topographic Maps

The USGS Pahrump, Nevada, 7.5-minute series topographic map, provisional edition 1984, depicts the site as undeveloped property with undeveloped land to the north, south, east, and west.

4.4. Interviews

Mr. Bill King, the client contact, provided site location information and historical details of the subject property.

4.5. Previous Reports and Documents

The client provided no previous environmental reports or documents for review.

5. ENVIRONMENTAL DATABASE SEARCH

A computerized environmental information database search was performed by *Environmental FirstSearch™* (*FirstSearch™*) on January 14, 2004. The *FirstSearch™* search included federal, state, and local databases. A summary of the environmental databases searched, their corresponding search radii, and number of noted sites of environmental concern, is presented in Table 3. In addition, the complete *FirstSearch™* report and a description of the assumptions and approaches to the database search is provided in Appendix F. The review was conducted to evaluate whether the site or properties within the vicinity of the site have been identified as having experienced significant unauthorized releases of hazardous substances or other events with potentially adverse environmental effects.

Table 3 – Summary of Environmental Database Search

Database Name	Agency	Search Radius (mile)	Sites Listed
National Priority List (NPL)	USEPA	1	0
Sites currently or formerly under review by US EPA (CERCLIS/NFRAP)	USEPA	0.5	0
RCRA Treatment, Storage, and Disposal (TSD) Facilities	USEPA	0.5	0
RCRA Corrective Action w/o TSD (CORRACTS)	USEPA	1	0
RCRA Generators List (GEN)	USEPA	0.25	0
RCRA No Longer Regulated List (NLR)	USEPA	0.12	0
Emergency Response Notification System (ERNS) List	USEPA	0.12	0
State Sites	NDEP	1	0
Permitted as solid waste landfills, incinerators, or transfer stations (SWL)	NDEP	0.5	0
Registered UST and AST Lists	NDEP	0.25	0
Leaking Underground Storage Tank (LUST) Lists	NDEP	0.5	0

The following paragraphs describe the databases that were searched for properties of environmental concern, and include a discussion of the regulatory status of the facilities and potential environmental impact to the subject site (if applicable). The groundwater gradient information provided indicates whether the individual facility is upgradient, downgradient, or crossgradient from the subject site in terms of groundwater flow.

United States Environmental Protection Agency, National Priorities List (NPL)

This list identifies hazardous material sites slated for cleanup under the federally sponsored Superfund program. These sites receive remedial funding under the Comprehensive Environmental Response, Compensation and Liability Act (CERCLA). No facilities were listed within a 1-mile radius of the site.

United States Environmental Protection Agency, CERCLIS List

This list identifies hazardous material sites or environmental incidents recognized and listed on the federal level. Sites identified by the United States Environmental Protection Agency (USEPA), which may have the potential for releasing hazardous substances into the environment, are listed in the Comprehensive Environmental Response, Compensation and Liability Information System (CERCLIS) database. No facilities were listed within a 0.5-mile radius of the site.

United States Environmental Protection Agency, RCRA TSD List

This list identifies USEPA-listed facilities that report storage, treatment, and/or disposal of hazardous waste (i.e., TSD facility) under the USEPA Resource Conservation and Recovery Act (RCRA) program. No facilities were listed within a 0.5-mile radius of the site.

United States Environmental Protection Agency, CORRACTS List

This list identifies RCRA facilities that are undergoing "corrective action." A "corrective action order" is issued pursuant to RCRA when there has been a release of hazardous waste into the environment from a RCRA facility. No facilities were listed within a 1-mile radius of the site.

United States Environmental Protection Agency, RCRA Generator (GEN)

This database identifies USEPA-listed facilities that report generation of reportable quantities of hazardous waste under the RCRA program for the identification and tracking of hazardous waste. The list consists of properties that generate hazardous waste, and is not necessarily indicative of sites where a release of hazardous substances has occurred. No facilities were listed within a 0.25-mile radius of the site.

United States Environmental Protection Agency, RCRA No Longer Regulated (NLR)

This database identifies USEPA-listed facilities that report generation of less than 100 kilograms of hazardous waste under the RCRA program for the identification and tracking of hazardous waste or do not meet other RCRA requirements. No facilities were listed within a 0.125-mile radius of the site.

United States Environmental Protection Agency – Emergency Response Notification System (ERNS)

The ERNS is a national database used to collect information on reported releases of oil and hazardous substances. The database contains information from spill reports made to federal authorities, including the USEPA, the United States Coast Guard, the National Response Center, and the Department of Transportation. The subject site was not listed on this database.

Nevada Department of Conservation and Natural Resources, Corrective Action Cases (State Sites)

The Nevada Department of Conservation and Natural Resources, Bureau of Corrective Actions maintains a list of cleanup evaluations and actions regarding sites with actual or potential contamination that could affect groundwater. No facilities were listed within a 1-mile radius of the site.

Nevada Department of Conservation and Natural Resources, Landfill List

The Nevada Department of Conservation and Natural Resources maintains lists of facilities including active solid waste disposal sites, inactive or closed solid waste disposal sites, and transfer facilities. No facilities were listed within a 0.5-mile radius of the site.

Nevada Department of Conservation and Natural Resources, UST and AST Registration List

Information regarding underground and aboveground storage tanks (ASTs) registered with the Nevada Department of Conservation and Natural Resources is provided on the agency's UST list and AST list. The UST and AST lists consist of properties that have registered tanks, and are not necessarily indicative of sites where a release of hazardous substances has occurred. No facilities were listed within a 0.25-mile radius of the site.

Nevada Department of Conservation and Natural Resources, Leaking Underground Storage Tank (LUST) List

The LUST Information System is maintained by the Nevada Department of Conservation and Natural Resources. It includes sites with tanks under investigation, for potential leaks, confirmed leaks, and those to be closed. No facilities were listed within a 0.5-mile radius of the site.

6. SITE RECONNAISSANCE

On January 27, 2004, Ms. Cynthia Bogdan and Mr. Mark Porterfield of Ninyo & Moore conducted a site reconnaissance of the subject property. The reconnaissance involved a walking tour of the site and visual observations of adjoining properties. Select photographs taken during the site reconnaissance are included in Appendix A.

6.1. Physical Limitations

No physical limitations (e.g., locked rooms, fenced areas) were encountered during the site reconnaissance. At the time of the site reconnaissance, the weather was sunny and clear with a temperature of approximately 50 degrees Fahrenheit.

6.2. Use and Storage of Hazardous Substances and Petroleum Products

No stored hazardous substances or petroleum products were observed.

6.3. Storage and Disposal of Hazardous Wastes

No evidence of hazardous wastes on site was observed or reported during the site reconnaissance.

6.4. Unidentified Substance Containers

There were numerous unidentified substance containers dumped on the subject site that were empty and deeply rusted with holes. Two containers were filled with cement.

6.5. Aboveground and Underground Storage Tanks

No evidence of ASTs or USTs (i.e., fill pipes, vent pipes, and emergency power generators) was observed on the site.

6.6. Evidence of Releases

No evidence of chemical releases, i.e., odors, stressed vegetation, stains, leaks, pools of liquids, and spills, was observed on the site.

6.7. Polychlorinated Biphenyls (PCBs)

No transformers or other sources of PCBs were observed at the site.

6.8. Wastewater Systems

No wastewater systems, such as clarifiers, sumps, pits, grease traps, and floor drains, were observed on the site.

6.9. Storm Water Systems

No storm water systems were observed on the site. However, a small dry wash bed is located adjacent to Carpenter Canyon Road, which runs through the center of the subject property.

6.10. Wells

No water supply or groundwater monitoring wells were observed on the site.

6.11. Additional Issues

Household trash and debris, primarily in the form of broken glass bottles and rusted tin cans, was noted across the subject property with particular concentrations present in the dry wash bed. There were numerous empty rusted 55-gallon drums with holes. Two containers were filled with cement. There were no other issues of environmental concern at the subject site at the time of the site reconnaissance.

7. FINDINGS, OPINIONS, AND CONCLUSIONS

Based upon the results of this Phase I ESA, the following findings and conclusions are provided.

7.1. Findings and Opinions

The following presents a summary of findings associated with the ESA performed for the subject site.

- The subject site consists of an approximately 280-acre portion of an approximately 320-acre parcel bisected by Carpenter Canyon Road. The subject site is undeveloped except for a BLM fire station located in the northwest quadrant of the site.
- Based on a review of historical sources, the portion of parcel #4701101 that comprises the subject site has not previously been developed.
- Review of environmental databases indicated that no sites located in the vicinity of the subject site have handled hazardous materials or waste and/or have been listed as having reported releases of hazardous substances or petroleum products. The subject site was not listed.

7.2. Conclusions

Ninyo & Moore has performed this Phase I ESA in conformance with the scope and limitations of the ASTM Practice E 1527-00. Any exceptions to, or deletions from, this practice are described in Section 6.1 of this report. This assessment has revealed no evidence of recognized environmental conditions in connection with the property at this time.

8. NEVADA CERTIFIED ENVIRONMENTAL MANAGER

In accordance with the Nevada Revised Statutes 459.500, Section 1, a holder of a certificate who is responsible for a service requiring certification shall ensure that each document relating to the service includes the following language:

I, Robert M. Troisi, hereby certify that I am responsible for the services described in this document and for the preparation of this document. The services described in this document have been provided in a manner consistent with the current standards of the profession and to the best of my knowledge comply with all applicable federal, state, and local statutes, regulations, and ordinances.



Robert M. Troisi, C.E.M.
Certified Environmental Manager
No. 1247
Expires: January 5, 2005



Date

9. SELECTED REFERENCES

Aerial Photographs, Las Vegas, Nevada, Continental Aerial Photo, Inc.

Environmental FirstSearch™ Report dated January 14, 2004.

Federal Emergency Management Agency, 1995, Clark County, Nevada and Incorporated Areas,
Online Flood Insurance Rate Map Database.

Nevada Division of Water Resources, 2003, Online Well Log Database.

Southern Nevada Geographic Information System (GIS) Website.

United States Geological Survey, Pahrump, Nevada: 7.5-minute series (topographic), Scale
1:24,000, provisional edition 1984.

FIGURES

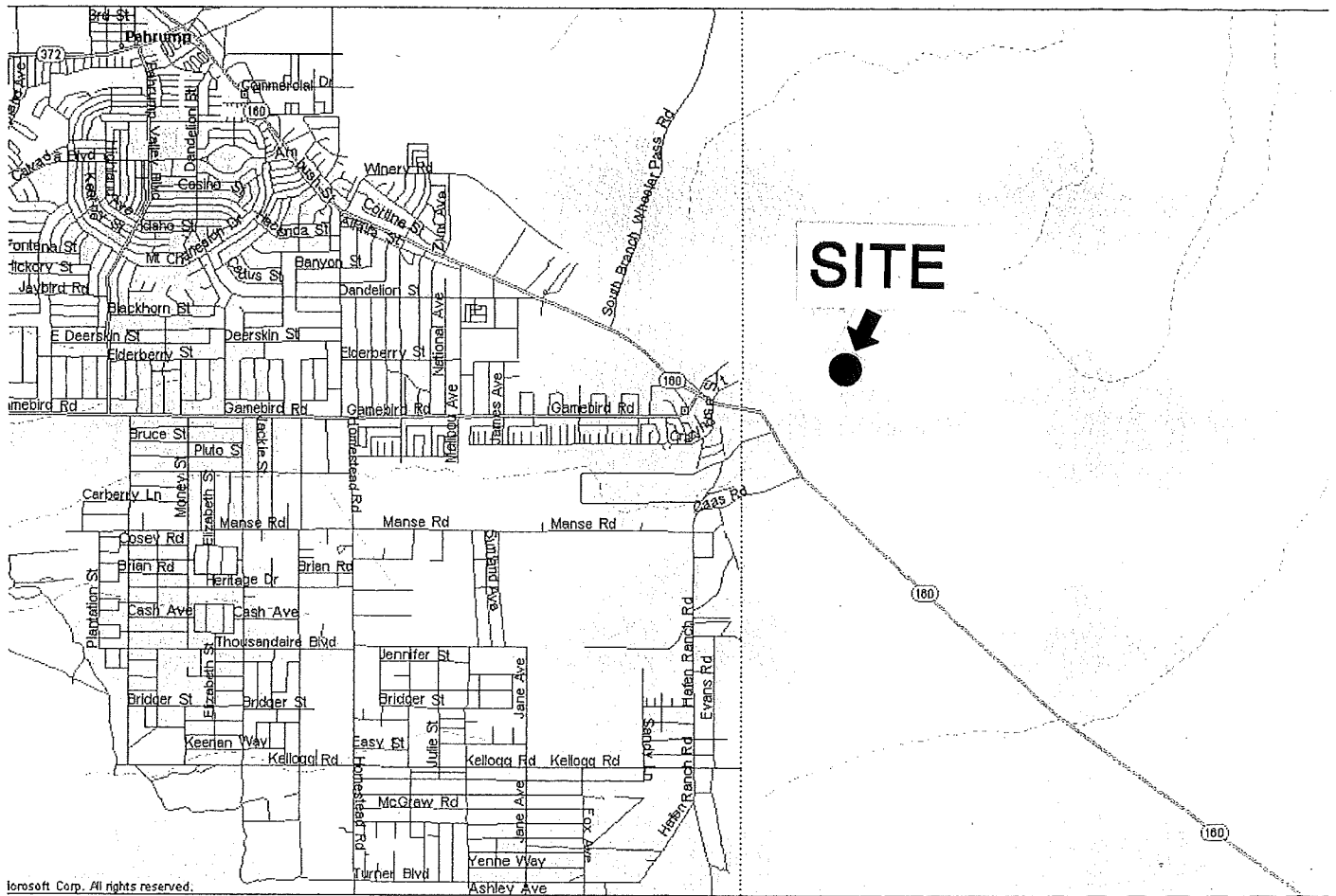

REFERENCE: Microsoft MapPoint 2002.



NOT TO SCALE



SITE LOCATION MAP

PROPOSED NEVADA STATE COLLEGE AT PAHRUMP
NORTH 1/2 OF SECTION 2 TOWNSHIP 21S,
RANGE 54 E

PROJECT NO.	DATE
301437001	06/2004

FIGURE
1

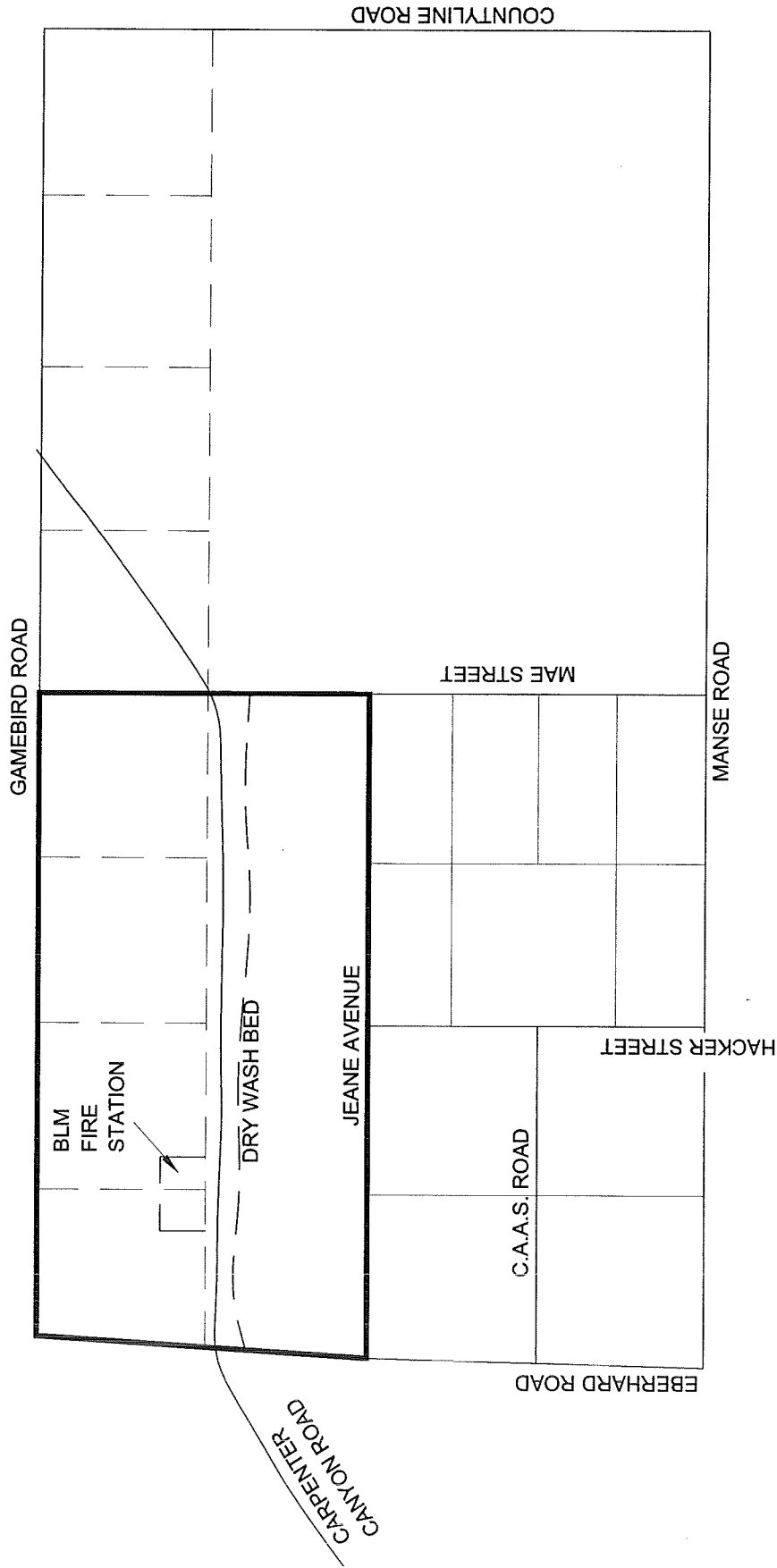

LEGEND

— Site boundary.



NOT TO SCALE

SITE MAP

PROPOSED NEVADA STATE COLLEGE AT PAHRUMP
N 1/2 OF SECTION 2 TOWNSHIP 21S, RANGE 54 E

PROJECT NO.
301437001

DATE
06/2004

FIGURE
2

Ninyo & Moore

APPENDIX A

Site Photographs



Photograph 1: View to the west of debris in the dry wash bed along Carpenter Canyon Road.



Photograph 2: View of two unidentified containers filled with cement in the dry wash bed along Carpenter Canyon Road.



Photograph 3: View to the north of undeveloped land.



Photograph 4: View to the south of undeveloped land.



Photograph 5: View to the west of undeveloped land and Pahrump Valley.

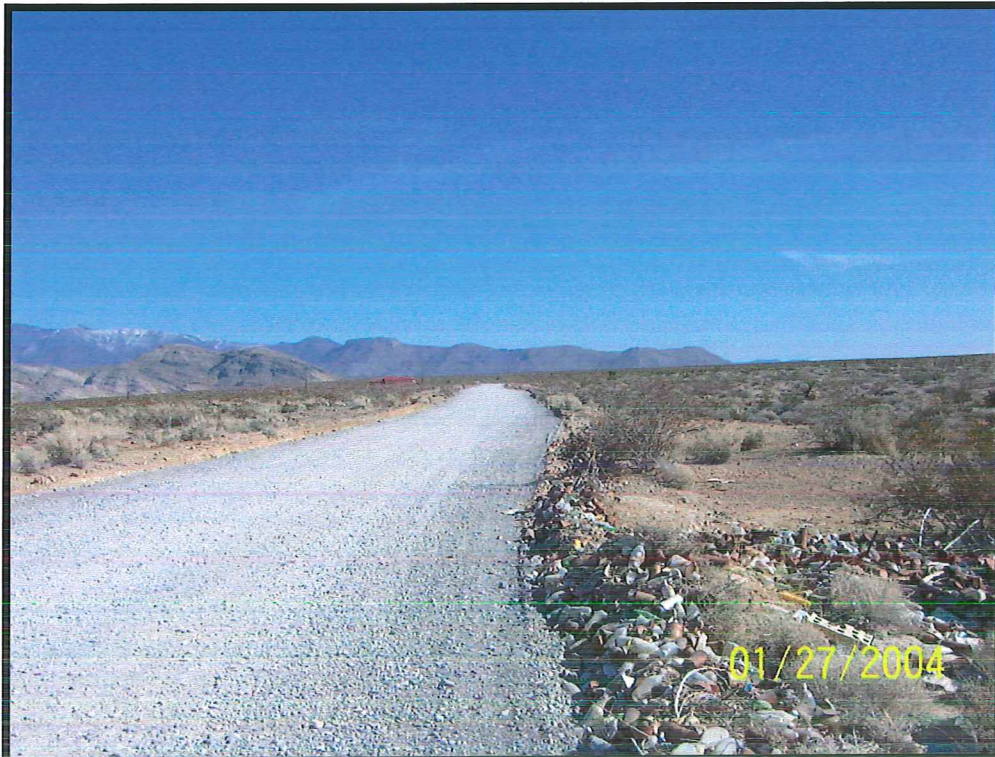

Photograph 6: View to the east of Carpenter Canyon Road and undeveloped land.



Photograph 7: View to the north of unoccupied BLM Fire Station.

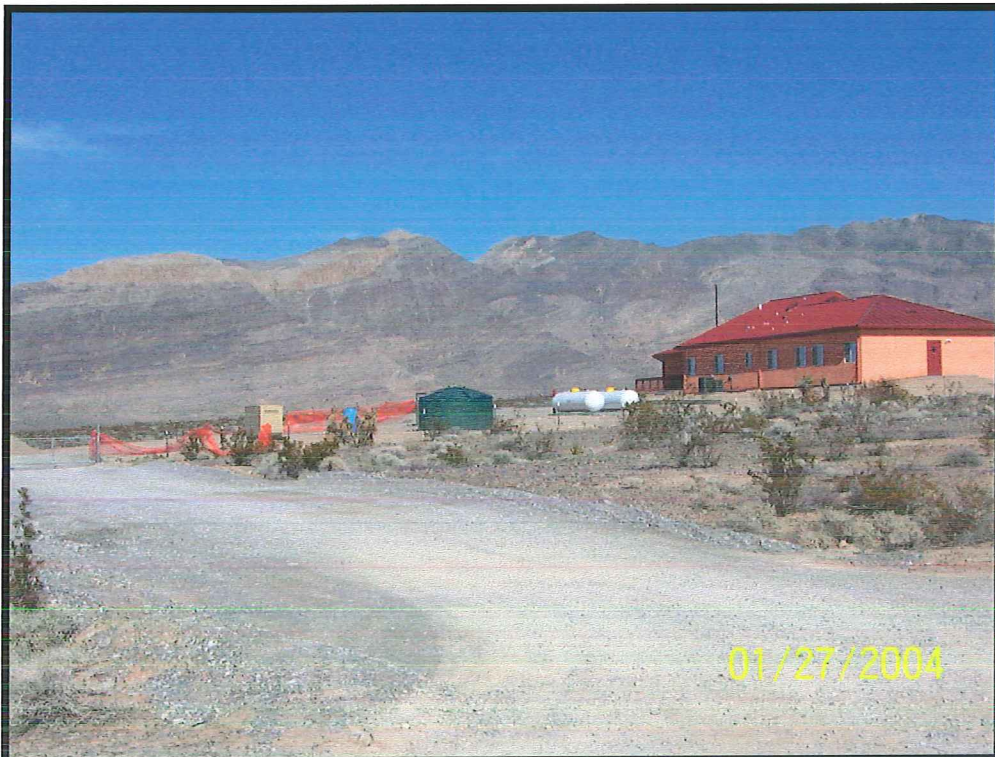

Photograph 8: View to the north of unoccupied BLM Fire Station and utilities (propane cylinders, water tank, and generator).

APPENDIX B

Nye County Tax Assessor Parcel Information

47-01

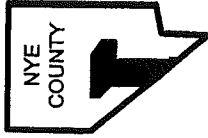

REV. 05-14-02

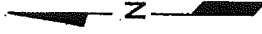

T.21S., R.54E.
SECTIONS 1 & 2

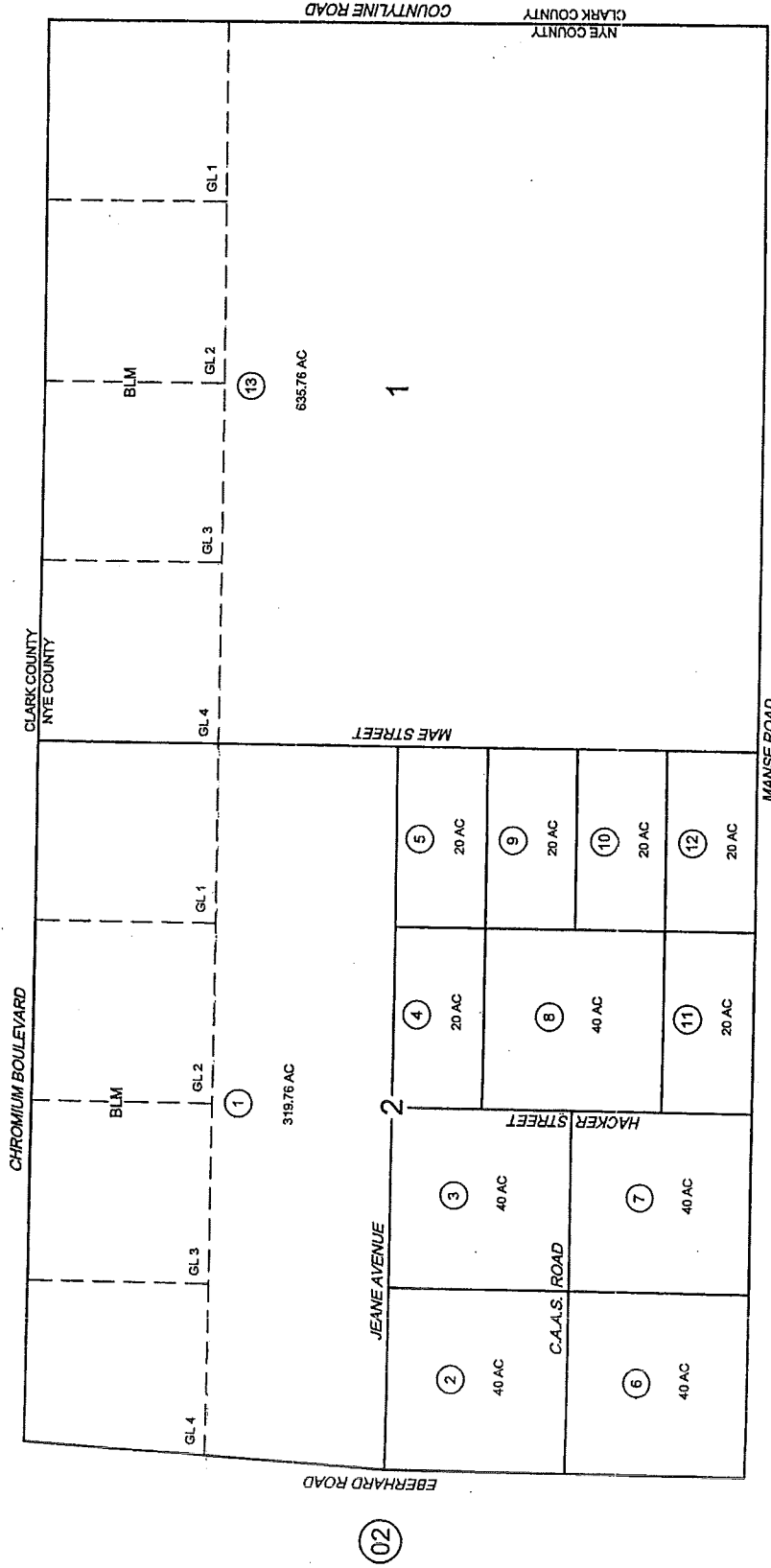

02

04

NOTE: THIS PLAT IS FOR ASSESSMENT USE ONLY AND DOES NOT REPRESENT A SURVEY. NO LIABILITY IS ASSUMED AS TO THE ACCURACY OF THE DATA DELINEATED HEREON.

NEW PAGE
CAD FILE 06-28-07/NG
NYE COUNTY ASSESSOR

APPENDIX C

Historical Topographic Map

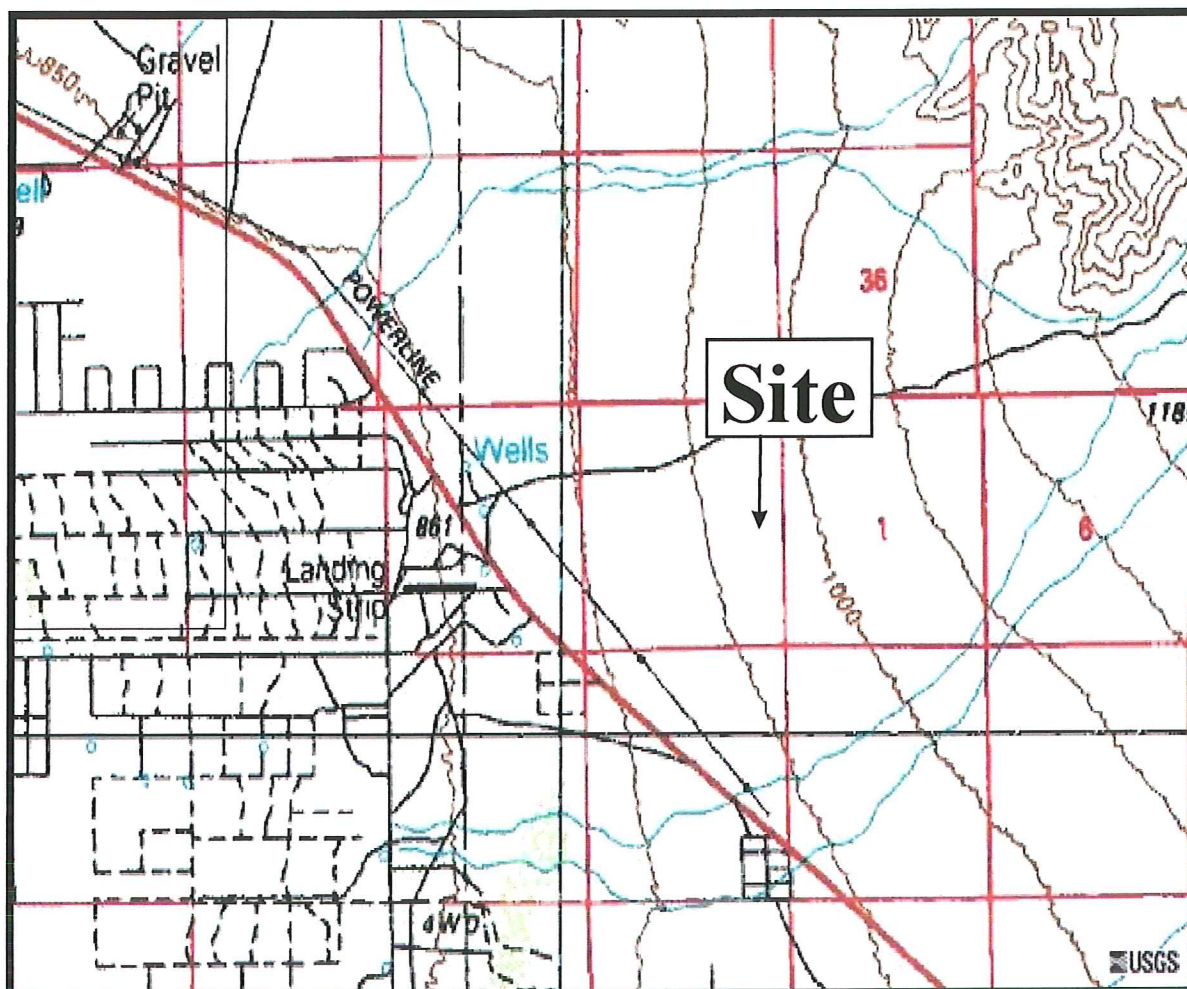

Source: USGS Pahrump, Nevada, 7.5-minute series topographic map, provisional edition 1984.

APPENDIX D

Well Log Database

Nevada Division of Water Resources

Well Log Database

Query Results

Basin	County	Qtr- Qtr	Section	Twp	Rng	Owner	Date Complete	Well Log #	Driller Lic#	Total Depth	Static Water Level	Casing Diameter	APN	Work Type	Proposed Use	App #
162	32023	NE SW	02	21S	54E	HIY, JOHN	9/21/1986	27934	1426	180	38	8.62		N	H	

Code Definitions

Enter Well Log # to view detailed information:

APPENDIX E

Environmental Database Search

TRACK ► INFO SERVICES, LLC

Environmental FirstSearch™ Report

TARGET PROPERTY:

PAHRUMP NV 89124

Job Number: 301437001

PREPARED FOR:

Ninyo and Moore
3155 East Patrick Lane
Las Vegas, NV 89120

01-14-04



Tel: (323) 664-9981

Fax: (323) 664-9982

Environmental FirstSearch Search Summary Report

Target Site:

PAHRUMP NV 89124

FirstSearch Summary

Database	Sel	Updated	Radius	Site	1/8	1/4	1/2	1/2>	ZIP	TOTALS
NPL	Y	09-09-03	1.00	0	0	0	0	0	0	0
CERCLIS	Y	12-08-03	0.50	0	0	0	0	-	0	0
NFRAP	Y	12-08-03	0.12	0	0	-	-	-	0	0
RCRA TSD	Y	09-09-03	0.50	0	0	0	0	-	0	0
RCRA COR	Y	09-09-03	1.00	0	0	0	0	0	0	0
RCRA GEN	Y	09-09-03	0.25	0	0	0	-	-	0	0
RCRA NLR	Y	09-09-03	0.12	0	0	-	-	-	0	0
ERNS	Y	12-31-02	0.12	0	0	-	-	-	0	0
State Sites	Y	04-09-03	1.00	0	0	0	0	0	0	0
SWL	Y	06-27-02	0.50	0	0	0	0	-	0	0
REG UST/AST	Y	12-08-03	0.25	0	0	0	-	-	0	0
Leaking UST	Y	09-30-03	0.50	0	0	0	0	-	0	0
- TOTALS -				0	0	0	0	0	0	0

Notice of Disclaimer

Due to the limitations, constraints, inaccuracies and incompleteness of government information and computer mapping data currently available to TRACK Info Services, certain conventions have been utilized in preparing the locations of all federal, state and local agency sites residing in TRACK Info Services's databases. All EPA NPL and state landfill sites are depicted by a rectangle approximating their location and size. The boundaries of the rectangles represent the eastern and western most longitudes; the northern and southern most latitudes. As such, the mapped areas may exceed the actual areas and do not represent the actual boundaries of these properties. All other sites are depicted by a point representing their approximate address location and make no attempt to represent the actual areas of the associated property. Actual boundaries and locations of individual properties can be found in the files residing at the agency responsible for such information.

Waiver of Liability

Although TRACK Info Services uses its best efforts to research the actual location of each site, TRACK Info Services does not and can not warrant the accuracy of these sites with regard to exact location and size. All authorized users of TRACK Info Services's services proceeding are signifying an understanding of TRACK Info Services's searching and mapping conventions, and agree to waive any and all liability claims associated with search and map results showing incomplete and or inaccurate site locations.

***Environmental FirstSearch
Site Information Report***

Request Date: 01-14-04
Requestor Name: Cynthia Bogdan
Standard: ASTM

Search Type: COORD
Job Number: 301437001
Filtered Report

TARGET ADDRESS:

PAHRUMP NV 89124

Demographics

Sites: 0	Non-Geocoded: 0	Population: NA
Radon: 0.2 PCI/L		

Site Location

	<u>Degrees (Decimal)</u>	<u>Degrees (Min/Sec)</u>	<u>UTMs</u>
Longitude:	-115.88586	-115:53:9	Easting: 600222.187
Latitude:	36.15505	36:9:18	Northing: 4001520.009
			Zone: 11

Comment

Comment: PHASE I ESA

Additional Requests/Services

Adjacent ZIP Codes: 1 Mile(s)	Services:																																		
<table border="1"> <thead> <tr> <th>ZIP Code</th> <th>City Name</th> <th>ST</th> <th>Dist/Dir</th> <th>Sel</th> </tr> </thead> <tbody> <tr> <td>89048</td> <td>PAHRUMP</td> <td>NV</td> <td>0.69 NW Y</td> <td></td> </tr> </tbody> </table>	ZIP Code	City Name	ST	Dist/Dir	Sel	89048	PAHRUMP	NV	0.69 NW Y		<table border="1"> <thead> <tr> <th></th> <th>Requested?</th> <th>Date</th> </tr> </thead> <tbody> <tr> <td>Sanborns</td> <td>No</td> <td></td> </tr> <tr> <td>Aerial Photographs</td> <td>No</td> <td></td> </tr> <tr> <td>Topographical Maps</td> <td>No</td> <td></td> </tr> <tr> <td>City Directories</td> <td>No</td> <td></td> </tr> <tr> <td>Title Search</td> <td>No</td> <td></td> </tr> <tr> <td>Municipal Reports</td> <td>No</td> <td></td> </tr> <tr> <td>Online Topos</td> <td>No</td> <td></td> </tr> </tbody> </table>		Requested?	Date	Sanborns	No		Aerial Photographs	No		Topographical Maps	No		City Directories	No		Title Search	No		Municipal Reports	No		Online Topos	No	
ZIP Code	City Name	ST	Dist/Dir	Sel																															
89048	PAHRUMP	NV	0.69 NW Y																																
	Requested?	Date																																	
Sanborns	No																																		
Aerial Photographs	No																																		
Topographical Maps	No																																		
City Directories	No																																		
Title Search	No																																		
Municipal Reports	No																																		
Online Topos	No																																		



Environmental FirstSearch

1 Mile Radius
ASTM Map: NPL, RCACOR, STATE Sites



, PAHRUMP NV 89124

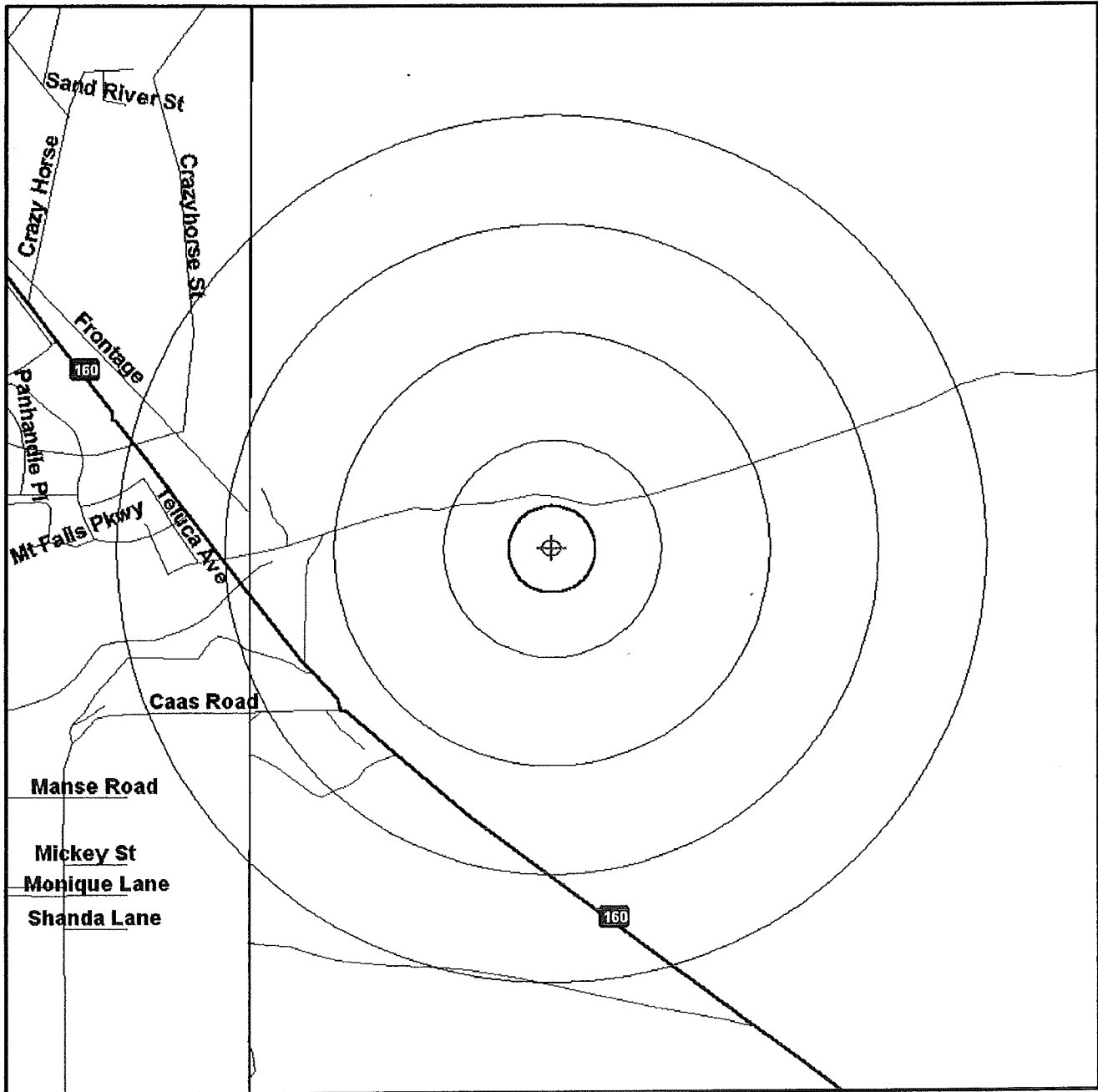

Source: 1999 U.S. Census TIGER Files

Target Site (Latitude: 36.15505 Longitude: -115.88586)

Identified Site, Multiple Sites, Receptor

NPL, Solid Waste Landfill (SWL) or Hazardous Waste

Railroads

Black Rings Represent 1/4 Mile Radii; Red Ring Represents 500 ft. Radius





Environmental FirstSearch

.5 Mile Radius
ASTM Map: CERCLIS, RCRATSD, LUST, SWL



, PAHRUMP NV 89124

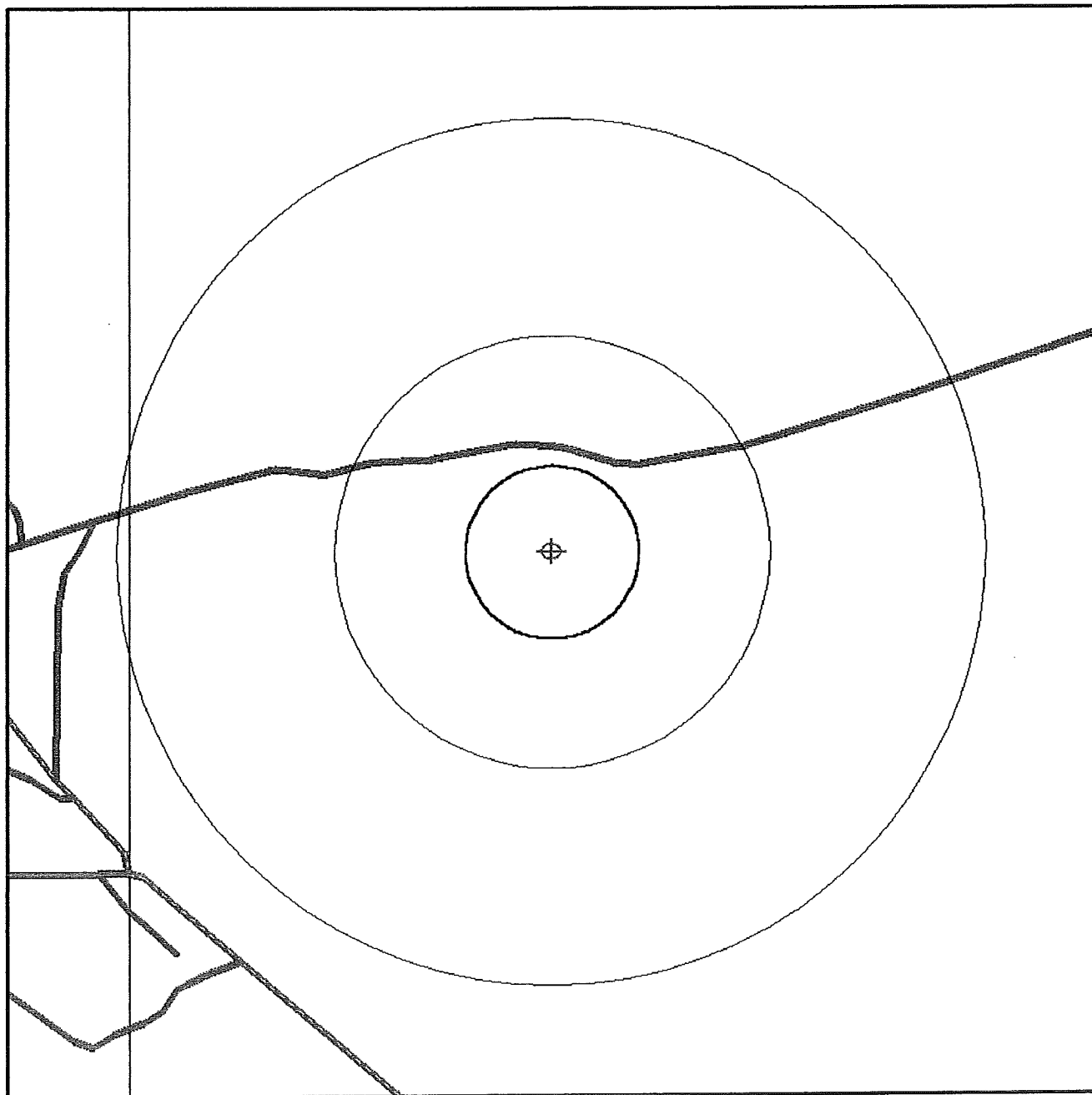

Source: 1999 U.S. Census TIGER Files

Target Site (Latitude: 36.15505 Longitude: -115.88586)

Identified Site, Multiple Sites, Receptor

NPL, Solid Waste Landfill (SWL) or Hazardous Waste

Railroads

Black Rings Represent 1/4 Mile Radii; Red Ring Represents 500 ft. Radius

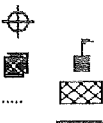



Environmental FirstSearch

.25 Mile Radius

ASTM Map: RCRA GEN, ERNS, UST



, PAHRUMP NV 89124

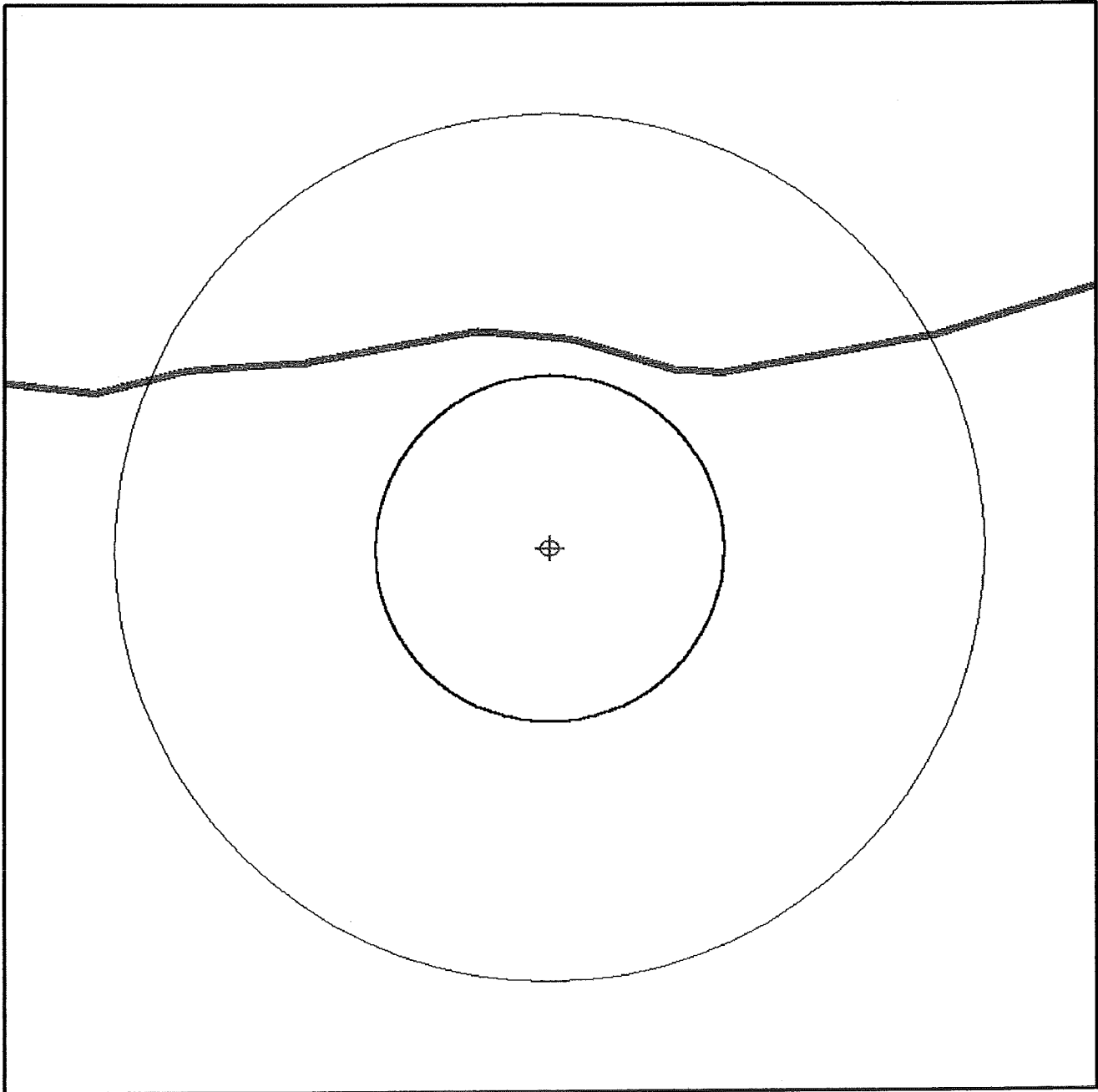

Source: 1999 U.S. Census TIGER Files

- Target Site (Latitude: 36.15505 Longitude: -115.88586)
- Identified Site, Multiple Sites, Receptor
- NPL, Solid Waste Landfill (SWL) or Hazardous Waste
- Railroads

Black Rings Represent 1/4 Mile Radii; Red Ring Represents 500 ft. Radius

*Environmental FirstSearch
Selected Sites Summary Report*

TARGET SITE:

PAHRUMP NV 89124

JOB:

301437001

PHASE I ESA

TOTAL: 0

GEOCODED: 0

NON GEOCODED: 0

SELECTED: 0

ID	DB Type	Site Name/ID/Status	Address	Dist/Dir	Map ID
-----------	----------------	----------------------------	----------------	-----------------	---------------

*Environmental FirstSearch
Site Detail Report*

TARGET SITE:

PAHRUMP NV 89124

JOB:

301437001

PHASE I ESA

No sites were found!

**Environmental FirstSearch
Federal Databases and Sources**

ASTM Databases:

CERCLIS: *Comprehensive Environmental Response Compensation and Liability Information System.* The EPA's database of current and potential Superfund sites currently or previously under investigation. Source: Environmental Protection Agency.

Updated quarterly.

CERCLIS-NFRAP (Archive): *Comprehensive Environmental Response Compensation and Liability Information System Archived Sites.* The Archive designation means that, to the best of EPA's knowledge, assessment at a site has been completed and that EPA has determined no further steps will be taken to list this site on the National Priorities List (NPL). This decision does not necessarily mean that there is no hazard associated with a given site; it only means that, based upon available information, the location is not judged to be a potential NPL site.

Updated quarterly.

ERNS: *Emergency Response Notification System.* The EPA's database of emergency response actions. Source: Environmental Protection Agency. Data since January, 2001, has been received from the National Response Center as the EPA no longer maintains this data.

Updated quarterly.

FINDS: *The Facility Index System.* The EPA's Index of identification numbers associated with a property or facility which the EPA has investigated or has been made aware of in conjunction with various regulatory programs. Each record indicates the EPA office that may have files on the site or facility. Source: Environmental Protection Agency.

Updated semi-annually.

NPL: *National Priority List.* The EPA's list of confirmed or proposed Superfund sites. Source: Environmental Protection Agency.

Updated quarterly.

RCRIS: *Resource Conservation and Recovery Information System.* The EPA's database of registered hazardous waste generators and treatment, storage and disposal facilities. Included are RAATS (RCRA Administrative Action Tracking System) and CMEL (Compliance Monitoring & Enforcement List). Source: Environmental Protection Agency.

RCRA TSD: *Resource Conservation and Recovery Information System Treatment, Storage, and Disposal Facilities.* The EPA's database of RCRIS sites which treat, store, dispose, or incinerate hazardous waste. This information is also reported in the standard RCRIS detailed data.

ASTM Databases (continued):

RCRA COR: *Resource Conservation and Recovery Information System Corrective Action Sites.* The EPA's database of RCRIS sites with reported corrective action. This information is also reported in the standard RCRIS detailed data.

RCRA GEN: *Resource Conservation and Recovery Information System Large and Small Quantity Generators.* The EPA's database of RCRIS sites that create more than 100kg of hazardous waste per month or meet other RCRA requirements. Included are RAATS (RCRA Administrative Action Tracking System) and CMEL (Compliance Monitoring & Enforcement List).

RCRA NLR: *Resource Conservation and Recovery Information System sites No Longer Regulated.* The EPA's database of RCRIS sites that create less than 100kg of hazardous waste per month or do not meet other RCRA requirements.

All RCRA databases are Updated quarterly

**Environmental FirstSearch
Federal Databases and Sources**

Non-ASTM Databases:

HMIRS: Hazardous Materials Incident Response System. This database contains information from the US Department of Transportation regarding materials, packaging, and a description of events for tracked incidents.

Updated quarterly.

NCDB: National Compliance Database. The National Compliance Data Base System (NCDB) tracks regional compliance and enforcement activity and manages the Pesticides and Toxic Substances Compliance and Enforcement program at a national level. The system tracks all compliance monitoring and enforcement activities from the time an inspector conducts and inspection until the time the inspector closes or the case settles the enforcement action. NCDB is the national repository of the 10 regional and Headquarters FIFRA/TSCA Tracking System (FTTS). Data collected in the regional FTTS is transferred to NCDB to support the need for monitoring national performance of regional programs.

Updated quarterly

NPDES: National Pollution Discharge Elimination System. The EPA's database of all permitted facilities receiving and discharging effluents. Source: Environmental Protection Agency.

Updated semi-annually.

NRDB: National Radon Database. The NRDB was created by the EPA to distribute information regarding the EPA/State Residential Radon Surveys and the National Residential Radon Survey. The data is presented by zipcode in Environmental FirstSearch Reports. Source: National Technical Information Service (NTIS)

Updated Periodically

Nuclear: The Nuclear Regulatory Commission's (NRC) list of permitted nuclear facilities.

Updated Periodically

PADS: PCB Activity Database System

The EPA's database PCB handlers (generators, transporters, storers and/or disposers) that are required to notify the EPA, the rules being similar to RCRA. This database indicates the type of handler and registration number. Also included is the PCB Transformer Registration Database.

Updated semi-annually.

Receptors: 1995 TIGER census listing of schools and hospitals that may house individuals deemed sensitive to environmental discharges due to their fragile immune systems.

Updated Periodically

Non-ASTM Databases (continued):

RELEASES: *Air and Surface Water Releases*. A subset of the EPA's ERNS database which have impacted only air or surface water.

Updated semi-annually.

Soils: This database includes the State Soil Geographic (STATSGO) data for the conterminous United States. It contains information regarding soil characteristics such as water capacity, percent clay, organic material, permeability, thickness of layers, hydrological characteristics, quality of drainage, surface, slope, liquid limit, and the annual frequency of flooding. Source: United States Geographical Survey (USGS).

Updated quarterly

TRIS: *Toxic Release Inventory System*. The EPA's database of all facilities that have had or may be prone to toxic material releases. Source: Environmental Protection Agency.

Updated semi-annually.

**Environmental FirstSearch
Nevada Databases and Sources**

CORRECTIVE ACTION CASES (STATE SITES)

Source: The Nevada Department of Conservation and Natural Resources,
Division of Environmental Protection (NDEP), Bureau of Corrective
Actions

Phone: (702) 687-4670

The Bureau of Corrective Actions maintains a list of clean-up evaluations and actions regarding sites with actual or potential contamination that could affect groundwater. This includes various types of sites including those regulated under Nevada State legislation described in detail in the Nevada State web site under legislation section NAC445.226 - NAC445.2739. For access to files or more information regarding specific sites, please call the number listed above.

LEAKING UNDERGROUND STORAGE TANKS (LUST)

Source: The Nevada Department of Conservation and Natural Resources,
Division of Environmental Protection (NDEP), Bureau of Corrective
Actions

Phone: (702) 687-4670

This division maintains an inventory of sites with leaking underground storage tanks. It includes sites with tanks under investigation for potential leaks, confirmed leaks, and those to be closed. For access to files or more information regarding specific sites, please call the number listed above.

UNDERGROUND STORAGE TANKS (UST)

Source: The Nevada Department of Conservation and Natural Resources,
Division of Environmental Protection (NDEP), Bureau of Corrective
Actions

Phone: (702) 687-4670

This division maintains an inventory of underground storage tanks. For access to files or more information regarding specific sites, please call the number listed above.

ABOVE GROUND STORAGE TANKS (AST)

Source: The Nevada Department of Conservation and Natural Resources,
Division of Environmental Protection (NDEP), Bureau of Corrective
Actions

Phone: (702) 687-4670

This division maintains an inventory of sites with above ground storage tanks. For more information regarding specific sites, please call the number listed above.

**Environmental FirstSearch
Nevada Databases and Sources (continued)**

Please Note:

AST sites are listed within the UST area of the First Search reports. They can be identified as AST sites by the site ID number. The site ID number is located in the Site Summary or Site Details section of the report. The site ID notes „AST" before the agency id.

SOLID WASTE LANDFILLS (SWL)

Source: The Nevada Department of Conservation and Natural Resources,
Division of Environmental Protection (NDEP), Office of Solid
Waste

Phone: (702) 687-4670

This division maintains an inventory of various solid waste facilities including open, closed, & permitted landfills, dumps, pesticide sites, and transfer stations. The inventory notes landfill class type and if the site is a private or government facility. For more information regarding specific sites, please call the number listed above.

WASHOE COUNTY LEAKING UNDERGROUND STORAGE TANKS (LUST)

Source: Washoe County Department of Environmental Health

Phone: (702) 328-2434

This department maintains a list of sites with leaking underground storage tanks. It includes sites with tanks under investigation for potential leaks, confirmed leaks, and those to be closed or needing emergency action. For more information regarding specific sites, please call the number listed above.