

**RECEIVED**

APR 01 2005

ENVIRONMENTAL PROTECTION

**HAZARDOUS BUILDING MATERIALS SURVEY  
SILVER STRIKE MOTEL  
201 NORTH MAIN STREET  
TONOPAH, NEVADA**

6-000623

**PREPARED FOR:**

Mr. Charlie Rodewald  
Nye County Grants Administration Office  
P.O. Box 153  
Tonopah, Nevada 89049

**PREPARED BY:**

Ninyo & Moore Geotechnical and Environmental Sciences Consultants  
3155 East Patrick Lane  
Las Vegas, Nevada 89120

March 31, 2003  
Project No. 301218001

March 31, 2003  
Project No. 301218001

Mr. Charlie Rodewald  
Nye County Grants Administration Office  
P.O. Box 153  
Tonopah, Nevada 89049

Subject: Hazardous Building Materials Survey  
Silver Strike Motel  
201 North Main Street  
Tonopah, Nevada 89049

Dear Mr. Rodewald:

In accordance with your authorization to proceed, Ninyo & Moore has performed a Hazardous Building Materials Survey of the Silver Strike Motel buildings located at 201 North Main Street, in Tonopah, Nevada. The attached report presents our methodology, findings, conclusions, and recommendations regarding our survey.

We appreciate the opportunity to be of service to you on this important project. Should you have any questions regarding this report, please contact the undersigned at your convenience.

Sincerely,  
**NINYO & MOORE**

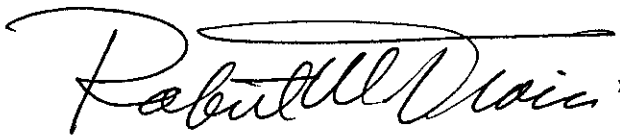

Robert M. Troisi, C.E.M.  
Managing Principal of Environmental Sciences

RMT/ltk

Distribution: (8) Addressee

**TABLE OF CONTENTS**

	<u>Page</u>
1. INTRODUCTION .....	1
2. PURPOSE AND SCOPE OF SERVICES.....	1
3. SITE DESCRIPTION .....	1
4. PHYSICAL LIMITATIONS .....	2
5. SAMPLE COLLECTION .....	3
5.1. Asbestos Survey.....	3
5.2. Paint Survey.....	3
5.3. Hazardous Building Material Survey .....	4
6. LABORATORY ANALYSES AND RESULTS .....	4
6.1. Asbestos.....	4
6.2. Paint.....	4
6.3. Miscellaneous Hazardous Building Materials .....	5
7. FINDINGS AND OPINIONS .....	5
7.1. Asbestos.....	5
7.2. Paint.....	5
7.3. Miscellaneous Hazardous Building Materials .....	6
8. RECOMMENDATIONS.....	6
9. LIMITATIONS.....	7

**Tables**

- Table 1 – Asbestos Survey Results
- Table 2 – Lead-based Paint Survey Results
- Table 3 – Summary of Hazardous Building Materials

**Figures**

- Figure 1 – Site Location Map
- Figure 2 – Site and Vicinity Map
- Figures 3 through 8 – Sample Location Maps

## 1. INTRODUCTION

In accordance with your request and authorization to proceed, Ninyo & Moore has performed a Hazardous Building Materials Survey (HBMS) of the Silver Strike Motel buildings located at 201 North Main Street in Tonopah, Nevada (Figure 1).

This report has been prepared in accordance with generally accepted environmental science and engineering practices. The report is based upon conditions at the subject buildings at the time of the sampling activities, and provides documentation of our findings and recommendations.

## 2. PURPOSE AND SCOPE OF SERVICES

The objective of the surveys was to identify and quantify building materials containing asbestos and/or lead-based paint (LBP), and to quantify potential mercury-containing thermostats/switches, polychlorinated biphenyl (PCB)-containing items (e.g., light ballasts, switches, and transformers), fluorescent light tubes, air conditioning units, and exit signs. Ninyo & Moore performed the services listed below.

- Visual assessment of accessible areas of selected on-site buildings to evaluate the possible presence of asbestos-containing materials (ACMs) and LBPs.
- Collection of 19 paint chip samples of potential LBP content.
- Collection of 70 suspect building material samples and submittal of these samples to an independent laboratory for analysis of asbestos content.
- Visual identification and quantification of air conditioning units, potential mercury-containing thermostats/switches, PCB-containing items, fluorescent light tubes, and exit signs.
- Preparation of this HBMS report, which presents our data and summarizes the assessed materials. This report includes sample location maps, a site description, laboratory testing information, conclusions and recommendations, tables summarizing the building materials assessed, and quantities of identified materials.

## 3. SITE DESCRIPTION

The subject site consists of five buildings and a pool area located at 201 North Main Street in Tonopah, Nevada. The layout of the buildings as they relate to the property boundaries is

presented on Figure 2. Building numbers 1 and 2 are single-story buildings constructed of brick walls and concrete slab floor, with wallboard and plaster interior walls, and stucco exterior siding. Floors are finished with vinyl sheet flooring, vinyl floor tile, and carpet. The walls and ceilings have a variety of finishes consisting of plaster, drywall, and an applied texture coating. The roofs are composed of asphalt shingles, rolled-on roofing, and roofing mastic.

Building 3 is a two-story building constructed on a concrete slab with concrete masonry block walls and wood-framed walls with exterior wood siding. Floors are finished with vinyl sheet flooring, vinyl floor tiles, and carpet. The interior finishes are acoustical ceiling tiles and dry wall.

Building 4 consists of a two-story building with an attached one-story building, which served as the manager's apartment. The buildings are wood-framed walls constructed on a concrete slab with exterior wood siding. The interior finishes consisted of drywall, vinyl floor tile, vinyl sheet flooring, carpet, and acoustical ceiling tiles.

Building 5 is a one-story building with a downstairs garage and basement area. The building is wood frame and concrete masonry block wall construction with exterior wood siding. The interior finishes include drywall, vinyl floor tile, vinyl sheet flooring, and carpet. The roof consists of a roll-on roofing material and mastic.

The pool is located adjacent to Building 1, 2, and 3 and is constructed of concrete materials. A chain link fence and block wall surround the pool area which is partially covered by a small roof that has asphalt shingles.

#### **4. PHYSICAL LIMITATIONS**

At the time of the survey, some limitations were encountered at the site. Ninyo & Moore personnel were not able to access all of the units due to being locked with no keys available or the unit doors were nailed closed. Ninyo & Moore personnel were not able to access the roofs of the two-story structures due to their height.

## 5. SAMPLE COLLECTION

From March 6 through March 8, 2003, Ninyo & Moore personnel conducted a limited asbestos and limited LBP survey at the site. The surveys followed U.S. Environmental Protection Agency (USEPA) guidelines, within the limitations of the scope of this assessment. The survey was performed by a Nevada Certified Asbestos Consultant, and consisted of collecting building materials suspected to contain asbestos from the subject structures, and quantifying miscellaneous hazardous building materials.

### 5.1. Asbestos Survey

A preliminary visual assessment and bulk-sampling survey of suspect ACMs was performed on all of the buildings included in the survey. Representative samples of these suspect ACMs were collected after identification of homogeneous sampling areas (areas in which the materials are uniform in color, texture, construction or application date, and general appearance). Each homogeneous area was observed for material type, location, condition, and friability. Representative samples were collected from each area of proposed demolition, except areas that were inaccessible, or areas of assumed ACM, within the limitations of the survey. Samples were collected using USEPA-recommended sampling procedures. Building materials that were sampled and analyzed for the presence of asbestos are presented in Table 1, and the locations of bulk asbestos samples are shown on Figures 3 through 8.

### 5.2. Paint Survey

Ninyo & Moore assessed the painted surfaces of the subject site to determine possible release to the environment from damaged flaking paint on the buildings and ground, for possible waste characterization, and for contractor worker safety. Representative paint chip samples were collected and sent to a laboratory for chemical analysis for lead content. The survey was conducted in general accordance with accepted environmental science and engineering practices. A total of 19 paint chips were collected and analyzed. The summary of sample results is presented on Table 2 and the locations are presented on Figures 3 through 8.

### **5.3. Hazardous Building Material Survey**

A visual assessment and quantification of potential mercury-containing thermostats/switches, PCB-containing light ballasts, fluorescent light tubes, transformers, air conditioning units, and an exit sign was performed. Hazardous building materials identified at the site are presented in Table 3.

## **6. LABORATORY ANALYSES AND RESULTS**

The following sections describe the laboratory analyses, laboratory results and survey results regarding materials and equipment surveyed, and samples collected during the survey.

### **6.1. Asbestos**

Seventy samples of suspect ACMs were collected and transferred to EMC Laboratories (EMC) for analysis. EMC is a laboratory accredited in the National Voluntary Laboratory Accreditation Program (NVLAP) for bulk asbestos fiber analysis. Because of material layering, of the 70 samples collected, 143 separate analyses were performed. The samples were analyzed for the presence and quantification of asbestos fibers, using polarized light microscopy with dispersion staining (PLM/ds) in general accordance with USEPA Method 600/M4-82-020. The lower limit of reliable detection for asbestos using the PLM method is approximately 1% by volume. Materials in which no asbestos was detected are defined in the laboratory report as no asbestos detected. Materials containing asbestos in amounts less than 1% but greater than 0.1% are defined as containing "trace" amounts. Suspect materials sampled and the analytical results are summarized in Table 1. Copies of the laboratory analytical reports and chain-of-custody records are presented in Appendix H.

### **6.2. Paint**

Nineteen lead-based paint chip samples were collected and sent for analysis by the inspector to EMC Labs, Inc. as per the EPA SW-846 Method 7420 guidelines. A description of the areas

sampled and the results of the analysis are included in Table 2. A copy of the laboratory analytical reports and chain-of-custody record is presented in Appendix H.

### **6.3. Miscellaneous Hazardous Building Materials**

Hazardous building materials visually identified at the site are presented on Table 3 of this report. Positive identification of these materials, via analytical testing, was not performed.

## **7. FINDINGS AND OPINIONS**

The findings of this survey are based on our visual observations; limited analysis of suspect building materials, document review, and paint chips collected from the subject site.

### **7.1. Asbestos**

Based on the analytical results of bulk samples collected during this limited survey, asbestos-containing materials (ACMs) are located in all of the buildings where samples were obtained. We observed certain areas of the buildings were significantly damaged from water intrusion causing roof collapse and other areas were damaged by vandalism. The presence of ACMs in a building does not necessarily mean that the health of the occupants is endangered. If these materials are in good condition and have not been disturbed or deteriorated, exposures are expected to be negligible. However, when ACM deteriorates, is disturbed, or is in damaged condition, such as during renovation operations, asbestos fibers may be released, creating a potential health hazard for building occupants, maintenance personnel, and contractors.

### **7.2. Paint**

Based on the analytical results of paint chips collected during our survey, there were no lead concentrations reported greater than 1.0 mg/cm<sup>2</sup>, 5,000 mg/kg, or 5,000 ppm at the subject site.



### 7.3. Miscellaneous Hazardous Building Materials

The results of our visual assessment and quantification of potential mercury-containing thermostats/switches, PCB-containing items (e.g., light ballasts, switches, and transformers), fluorescent light tubes, air conditioning units, and exit signs are listed on Table 3. Hazardous or potentially hazardous building materials found at the site included, fluorescent light ballasts, freon-containing air conditioning units, fluorescent light tubes, and a lead-acid battery.

## 8. RECOMMENDATIONS

Since ACMs and miscellaneous hazardous or potentially hazardous building materials have been identified at the subject site, the following recommendations and precautions are provided:

- In accordance with Nevada Administrative Code (NAC) 618.951 “*Exemption of Certain Activities from Requirements*,” vinyl asbestos floor tile, exterior roofing materials, exterior siding, drywall joint compound and other non friable materials may stay in place during normal demolition activities. However, if these materials are to be sent through a grinder during demolition, they must be removed completely prior to any grinding activities. To remain eligible for this exemption, the ACM:
  - May not be sanded, power sawed, or drilled.
  - Removed in the largest sections practicable and carefully lowered to the ground.
  - Handled carefully to minimize breakage throughout removal, handling, and transportation to an authorized disposal site.
  - Wetted before removal and during subsequent handling, to the extent practicable.
- The ceiling texture in Building 2 Unit 8, the wall texture of Building 2 Unit 10, the wall texture of Building 3 Unit 19, the wall texture of Building 4 Unit 35, and the exterior bathroom vent pipes of Building 2 were reported to contain asbestos greater than 1%. These ACMs are considered non-exempt and must be removed by a Nevada Asbestos Abatement Contractor prior to demolition.
- Prior to demolition work, a Nevada Asbestos Abatement Consultant should prepare a bid specification document, perform abatement project planning, site and air monitoring, project oversight, and reporting.

- There is a possibility that additional suspect ACM may be found during demolition. Ninyo & Moore recommends that should additional suspect materials, not sampled or assessed in this report, be uncovered during renovation or demolition; (a) samples of suspect materials should be collected for laboratory analysis, and all activities which may impact the materials should cease until laboratory analysis is completed, or; (b) the materials should be assumed to be asbestos-containing and handled as such.
- Prior to building demolition, potential PCB-containing items (e.g., light ballasts), potential freon-containing air conditioning units, and fluorescent light tubes should be removed and properly recycled or disposed by a licensed contractor in compliance with all federal, state and local environmental regulations.

## 9. LIMITATIONS

Ninyo & Moore's opinions and recommendations regarding environmental conditions, as presented in this report, are based on limited sampling and analysis. Further assessment of potential adverse environmental impacts may be accomplished by a more comprehensive assessment. The samples collected and used for testing, and the observations made, are believed to be representative of the area(s) evaluated. However, if additional suspect ACM is encountered during renovation or demolition activities, these materials should be sampled by qualified personnel, and analyzed for asbestos content prior to further disturbance. In addition, please note that quantities of ACMs are approximate. These numbers should be confirmed prior to removal or repair activities.

The environmental services described in this report have been conducted in general accordance with current regulatory guidelines and the standard-of-care exercised by environmental consultants performing similar work in the project area. No other warranty, expressed or implied, is made regarding the professional opinions presented in this report. Variations in site conditions may exist and conditions not observed or described in this report may be encountered during subsequent activities. Please also note that this study did not include an evaluation of geotechnical conditions or potential geologic hazards.

This document is intended to be used only in its entirety. No portion of the document, by itself, is designed to completely represent any aspect of the project described herein. Ninyo & Moore should be contacted if the reader requires any additional information, or has questions regarding content, interpretations presented, or completeness of this document.

The environmental interpretations and opinions contained in this report are based on the results of laboratory tests and analyses intended to detect the presence of ACMs in samples collected from the subject site. The testing and analyses have been conducted by an independent laboratory, which is accredited by the National Voluntary Laboratory Accreditation Program (NVLAP), for bulk asbestos fiber analysis. Ninyo & Moore has no involvement in, or control over, such testing and analysis. Ninyo & Moore, therefore, disclaims responsibility for any inaccuracy in such laboratory results.

Our conclusions, recommendations, and opinions are based on an analysis of the observed site conditions. It should be understood that the conditions of a site could change with time as a result of natural processes or the activities of man at the subject site or nearby sites. In addition, changes to the applicable laws, regulations, codes, and standards of practice may occur due to government action or the broadening of knowledge. The findings of this report may, therefore, be invalidated over time, in part or in whole, by changes over which Ninyo & Moore has no control.

Silver Strike Motel  
201 North Main Street  
Tonopah, Nevada

March 31, 2003  
Project No. 301218001

---

**FIGURES**

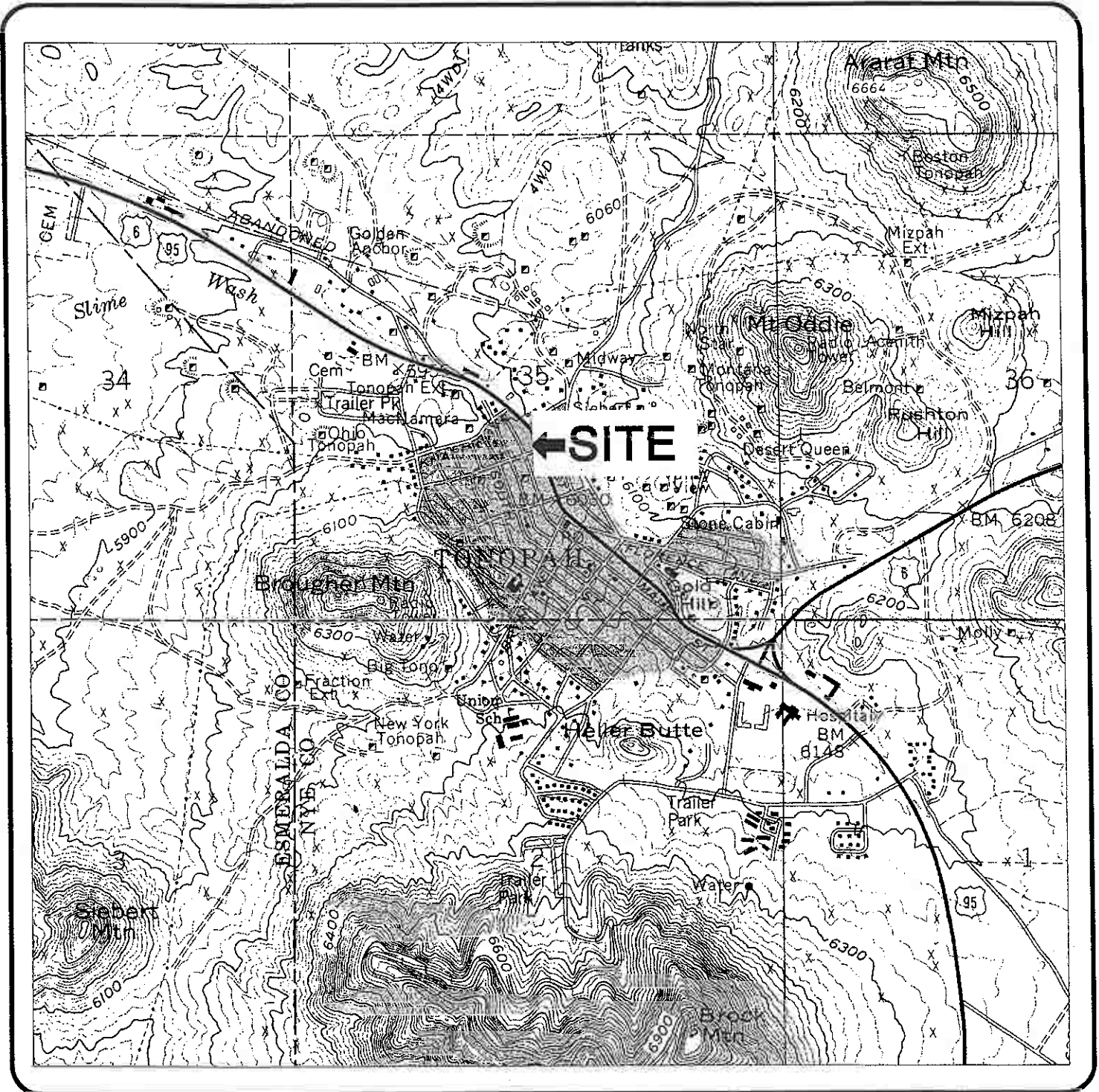

REFERENCE: USGS, TONOPAH QUADRANGLE, NEVADA, 7.5 MINUTE SERIES (Topographic): dated 1982.



**SITE LOCATION MAP**  
 HAZARDOUS BUILDING MATERIALS SURVEY  
 SILVER STRIKE MOTEL  
 201 MAIN STREET  
 TONOPAH, NEVADA

PROJECT NO.	DATE
301218001	03/2003

FIGURE  
 1

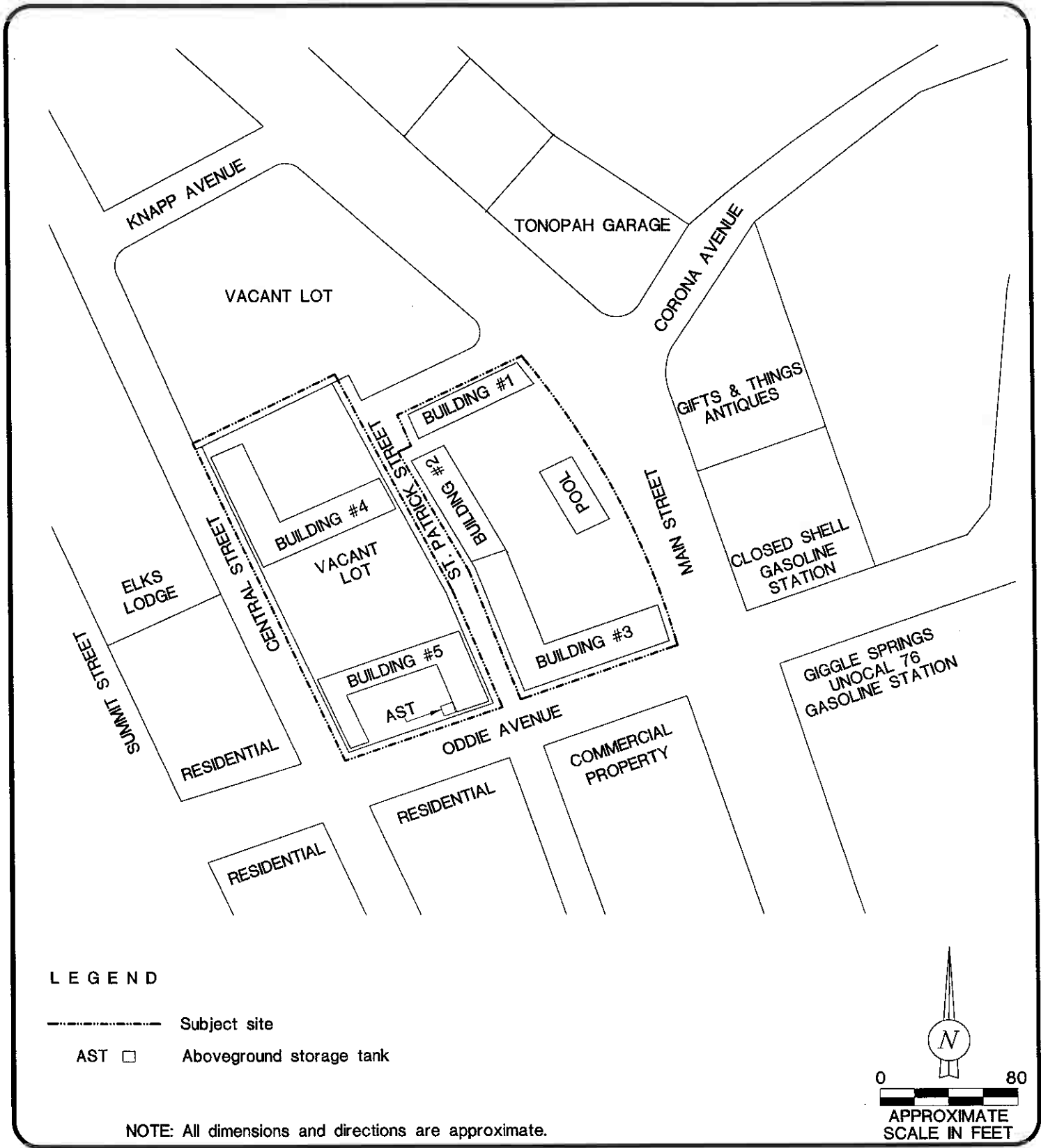

**SITE AND VICINITY MAP**

HAZARDOUS BUILDING MATERIALS SURVEY  
SILVER STRIKE MOTEL  
201 MAIN STREET \TONOPAH, NEVADA

PROJECT NO.	DATE
301218001	03/2003

FIGURE  
**2**

ST. PATRICK STREET

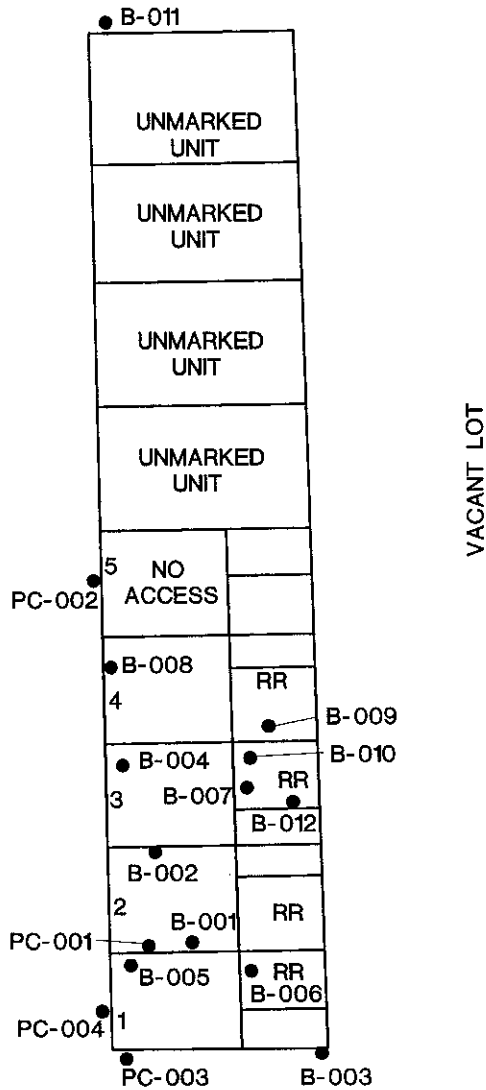

MAIN STREET (Highway 95)

LEGEND

● Sample location

NOTE: All dimensions and directions are approximate.

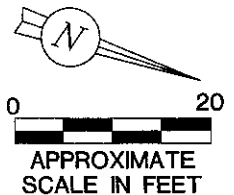

**Ninyo & Moore**

SAMPLE LOCATION MAP  
BUILDING NO. 1

HAZARDOUS BUILDING MATERIALS SURVEY  
SILVER STRIKE MOTEL  
201 MAIN STREET \TONOPAH, NEVADA

PROJECT NO.  
301218001

DATE  
03/2003

FIGURE  
3

ST. PATRICK STREET

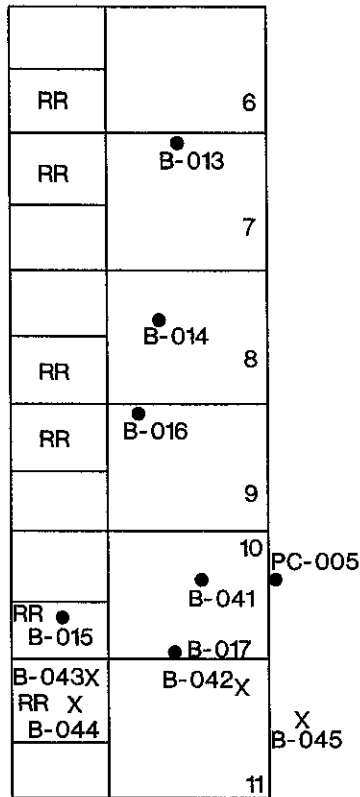

LEGEND

- Sample location
- X Indicates roof sample

NOTE: All dimensions and directions are approximate.

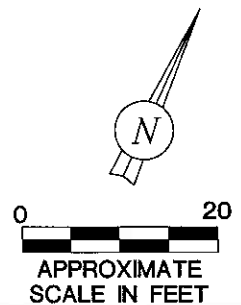

**Ninyo & Moore**

SAMPLE LOCATION MAP  
BUILDING NO. 2

HAZARDOUS BUILDING MATERIALS SURVEY  
SILVER STRIKE MOTEL  
201 MAIN STREET \TONOPAH, NEVADA

PROJECT NO.  
301218001

DATE  
03/2003

FIGURE  
4



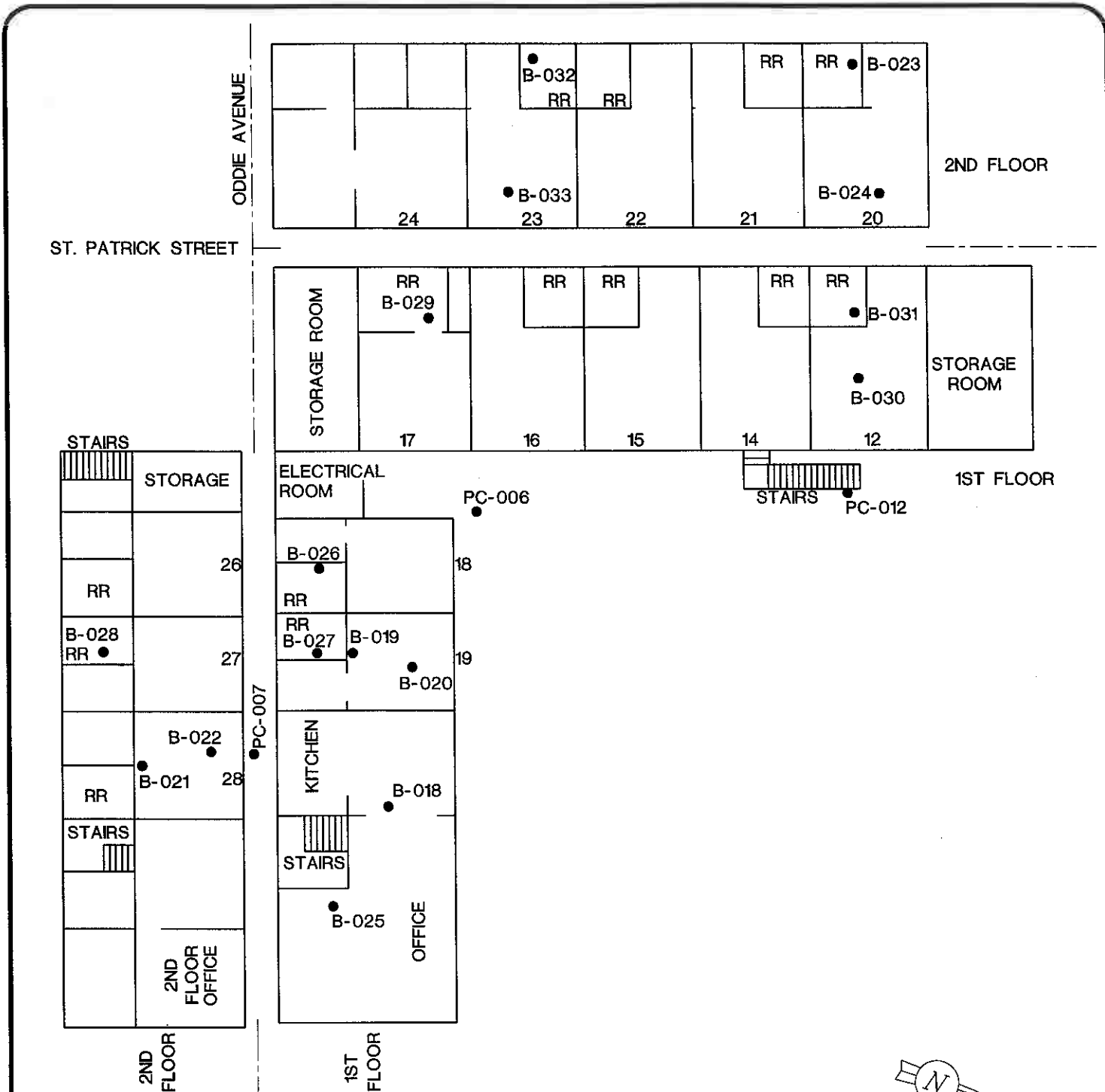

**LEGEND**

● Sample location

NOTE: All dimensions and directions are approximate.

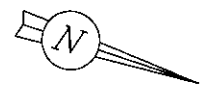

**SAMPLE LOCATION MAP  
BUILDING NO. 3**

HAZARDOUS BUILDING MATERIALS SURVEY  
SILVER STRIKE MOTEL  
201 MAIN STREET \TONOPAH, NEVADA

PROJECT NO. 301218001	DATE 03/2003
--------------------------	-----------------

**FIGURE  
5**

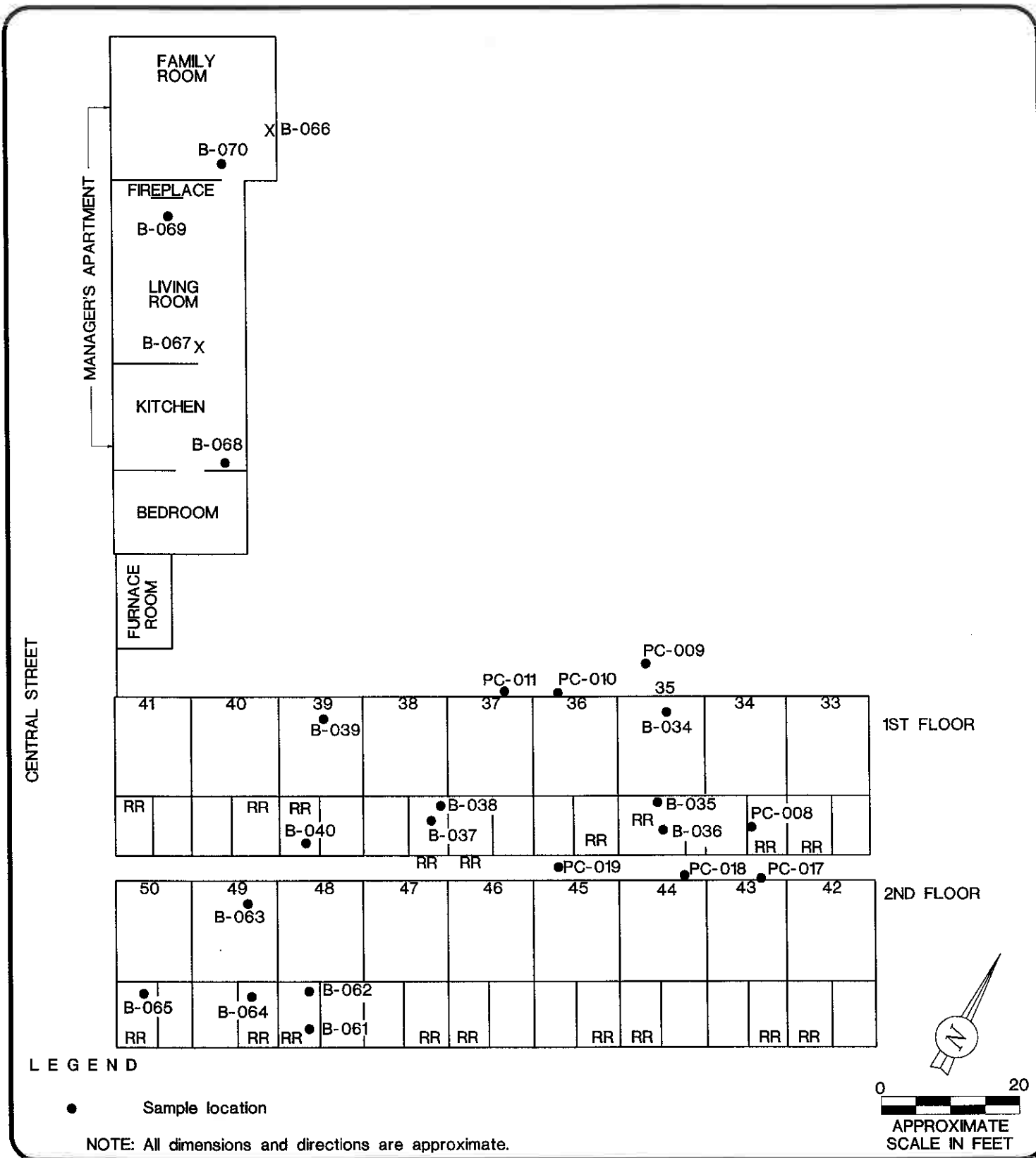

SAMPLE LOCATION MAP  
BUILDING NO. 4

HAZARDOUS BUILDING MATERIALS SURVEY  
SILVER STRIKE MOTEL  
201 MAIN STREET \TONOPAH, NEVADA

PROJECT NO. 301218001	DATE 03/2003
--------------------------	-----------------

FIGURE  
**6**

CENTRAL STREET

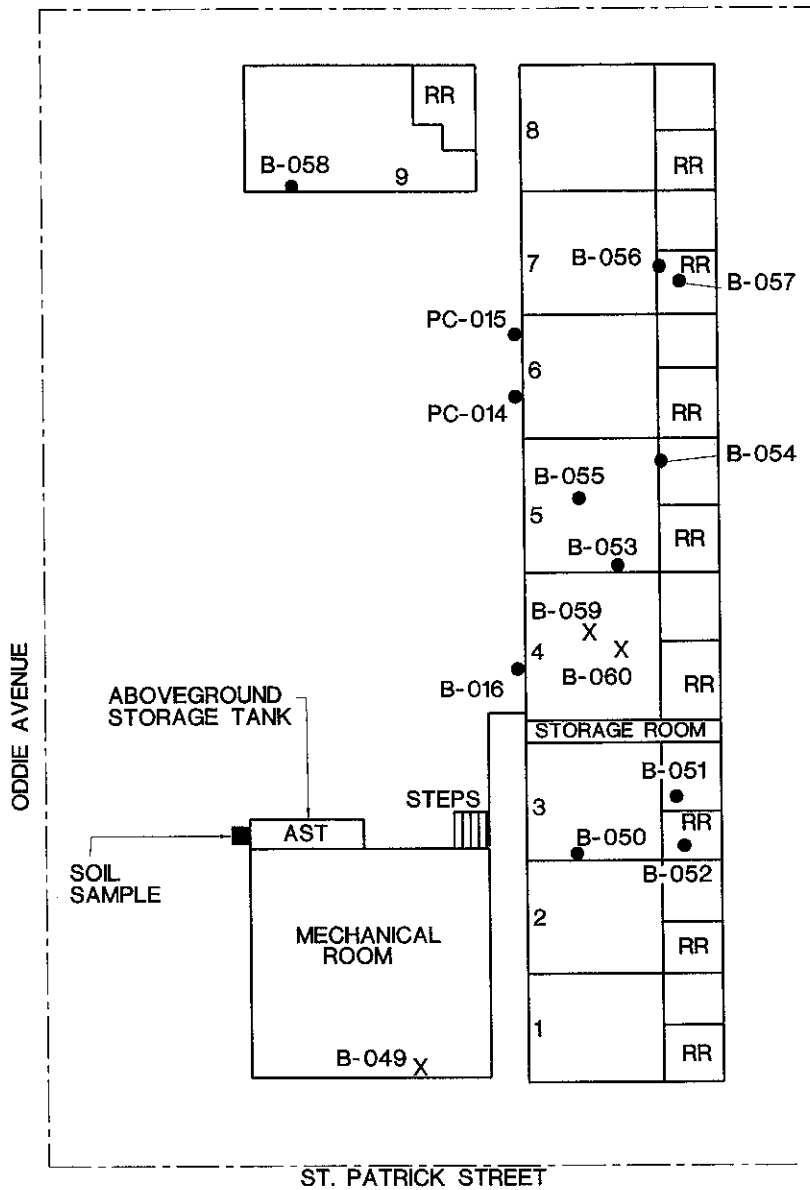

LEGEND

- Sample location
- X Indicates roof sample

NOTE: All dimensions and directions are approximate.

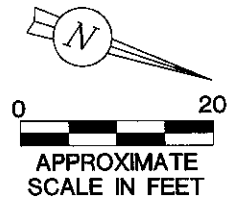

**Ninyo & Moore**

SAMPLE LOCATION MAP  
BUILDING NO. 5

HAZARDOUS BUILDING MATERIALS SURVEY  
SILVER STRIKE MOTEL  
201 MAIN STREET \TONOPAH, NEVADA

PROJECT NO.  
301218001

DATE  
03/2003

FIGURE  
7

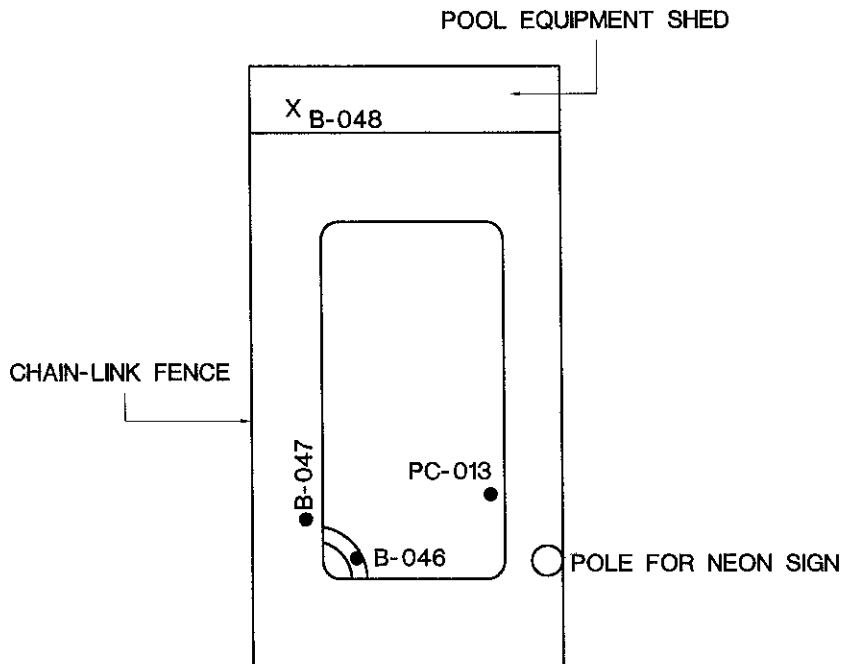

LEGEND

- Sample location
- X Indicates roof sample

NOTE: All dimensions and directions are approximate.

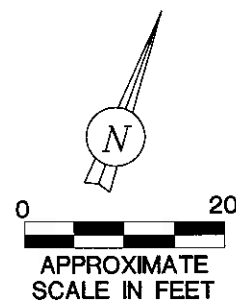

**Ninyo & Moore**

SAMPLE LOCATION MAP  
POOL

HAZARDOUS BUILDING MATERIALS SURVEY  
SILVER STRIKE MOTEL  
201 MAIN STREET \TONOPAH, NEVADA

PROJECT NO.  
301218001

DATE  
03/2003

FIGURE  
8

Silver Strike Motel  
201 North Main Street  
Tonopah, Nevada

March 31, 2003  
Project No. 301218001

---

TABLES

Table 1 - Asbestos Survey Results

Sample No.	Bldg. No.	Layer	Sample Location	Sample Description	Frangible Y/N	Condition	Asbestos Content
B-001	1	1	Unit 2 - Wall System	Wall Plaster, Beige	Y	Good	ND
	1	2	Unit 2 - Wall System	Wall Texture, White	Y	Good	ND
	1	3	Unit 2 - Wall System	Wallboard, Tan	Y	Good	ND
B-002	1	1	Unit 2 - Wall System	Wall Plaster, Beige	N	Good	ND
	1	2	Unit 2 - Wall System	Wall Texture, White	N	Good	ND
	1	3	Unit 2 - Wall System	Joint Compound, Beige	N	Good	2% Chrysotile
B-003	1	1	NE Corner, Exterior Wall	Exterior Stucco, Beige	N	Good	ND
	1	1	Unit 3, Bedroom	9"x9" Floor Tile, Red, Brown	N	Good	10% Chrysotile
B-004	1	2	Unit 3, Bedroom	Mastic, Black	N	Good	10% Chrysotile
	1	1	Unit 1, Bedroom	9"x9" Floor Tile, Gray	N	Good	10% Chrysotile
B-005	1	2	Unit 1, Bedroom	Mastic, Black	N	Good	10% Chrysotile
	1	1	Unit 1, Bathroom	Vinyl Sheet Flooring, Tan	Y	Good	20% Chrysotile
B-006	1	2	Unit 1, Bathroom	Mastic, Tan	Y	Good	2% Chrysotile
	1	1	Unit 3, Bathroom	Vinyl Sheet Flooring, Brown	Y	Good	ND
B-007	1	2	Unit 3, Bathroom	Mastic, Tan	Y	Good	ND
	1	1	Unit 4, Wall System	Wall Plaster, Beige	Y	Good	ND
B-008	1	2	Unit 4, Wall System	Wall Texture, White	Y	Good	ND
	1	3	Unit 4, Wall System	Wallboard, Tan	Y	Good	ND
	1	1	Unit 4, Shower Stall	Shower Wall, White, Brown	N	Good	ND
B-009	1	2	Unit 4, Shower Stall	Mastic, Red	N	Good	ND
	1	1	Unit 3, Bathroom	Ceramic Tile, Red/White	N	Good	ND
B-010	1	2	Unit 3, Bathroom	Grout, Off-White	N	Good	ND
	1	3	Unit 3, Bathroom	Mastic, Tan/Black	N	Good	10% Chrysotile

Table 1 - Asbestos Survey Results

Sample No.	Bldg No.	Layer	Sample Location	Sample Description	Feasible Y/N	Condition	Asbestos Content
B-011	1	1	SW Corner, Exterior Wall	Exterior Stucco Scratch Coat, Beige	N	Good	ND
	1	2	SW Corner, Exterior Wall	Exterior Stucco Finish Coat, White/Pink	N	Good	ND
	1	3	SW Corner, Exterior Wall	Concrete Bricks, Beige, White	N	Good	ND
B-012	1	1	Unit 3, Bathroom	Wall Plaster, Beige	N	Good	ND
	1	2	Unit 3, Bathroom	Wall Texture, White	N	Good	ND
B-013	2	1	Unit 7, Wall System	Wall Plaster, Beige	Y	Good	ND
	2	2	Unit 7, Wall System	Wall Texture, White	Y	Good	ND
	2	3	Unit 7, Wall System	Wallboard, Tan	Y	Good	ND
B-014	2	1	Unit 8, Ceiling	Drywall, Brown/Off-White	Y	Good	ND
	2	2	Unit 8, Ceiling	Texture, White	Y	Good	2% Chrysotile
B-015	2	1	Unit 10, Bathroom	Ceramic Tile, Gray/White	N	Good	ND
	2	2	Unit 10, Bathroom	Grout, Gray	N	Good	ND
	2	3	Unit 10, Bathroom	Grout, Beige	N	Good	ND
B-016	2	1	Unit 9, Bedroom	Drywall, Brown/Off-White	N	Good	ND
	2	2	Unit 9, Bedroom	Joint Compound, White	N	Good	ND
B-017	2	1	Unit 10, Bedroom	Wall Plaster, Beige	Y	Good	ND
	3	1	Bldg. 3 Office - Kitchen Area	Vinyl Sheet Flooring, Brown, Tan	Y	Good	20% Chrysotile
B-018	3	2	Bldg. 3 Office - Kitchen Area	Mastic, Tan	Y	Good	2% Chrysotile
	3	1	Unit 19, Bedroom	Drywall, Brown/Off-White	N	Damaged	ND
B-019	3	2	Unit 19, Bedroom	Joint Compound, White	N	Damaged	2% Chrysotile
	3	3	Unit 19, Bedroom	Texture, White	N	Damaged	3% Chrysotile
B-020	3	1	Unit 19, Bedroom	Ceiling Tile, White/Tan	Y	Damaged	ND
	3	1	Unit 28, Bedroom	Drywall, Brown/Off-White	N	Damaged	ND
B-021	3	2	Unit 28, Bedroom	Joint Compound, White	N	Damaged	2% Chrysotile

Table 1 - Asbestos Survey Results

Sample No.	Bldg. No.	Layer	Sample Location	Sample Description	Frivable Y/N	Condition	Asbestos Content
B-022	3	1	Unit 28, Bedroom	Ceiling Tile, White/Tan	Y	Damaged	ND
B-023	3	1	Unit 20, Restroom	Vinyl Sheet Flooring, Tan/White	Y	Good	20% Chrysotile
	3	2	Unit 20, Restroom	Mastic, Tan	Y	Good	2% Chrysotile
B-024	3	1	Unit 20, Bedroom	Ceiling Tile, White/Tan	Y	Damaged	ND
B-025	3	1	Office, Main Office	9"x9" Vinyl Floor Tile, Brown	N	Good	3% Chrysotile
	3	2	Office, Main Office	Mastic, Black	N	Good	10% Chrysotile
B-026	3	1	Unit 18, Restroom	12"x12" Vinyl Floor Tile, White, Gray	N	Good	ND
	3	2	Unit 18, Restroom	Mastic, White, Silver	N	Good	ND
B-027	3	1	Unit 19, Restroom	Vinyl Floor Tile, White, Gray	N	Good	15% Chrysotile
	3	2	Unit 19, Restroom	Mastic, Black, Brown	N	Good	2% Chrysotile
B-028	3	1	Unit 27, Restroom	Vinyl Floor Tile, White, Gold	Y	Good	5% Chrysotile
	3	2	Unit 27, Restroom	Mastic, Yellow	Y	Good	ND
B-029	3	3	Unit 27, Restroom	Vinyl Sheet Flooring, Beige	Y	Good	15% Chrysotile
	3	4	Unit 27, Restroom	Mastic, Brown	Y	Good	2% Chrysotile
B-030	3	1	Unit 17, Restroom	Vinyl Sheet Flooring, Brown	Y	Good	ND
	3	2	Unit 17, Restroom	Mastic, Yellow	Y	Good	ND
B-031	3	3	Unit 17, Restroom	Leveling Compound, White	Y	Good	3% Chrysotile
	3	1	Unit 12, Bedroom	Textured Ceiling Tile, White, Yellow	Y	Damaged	ND
B-031	3	1	Unit 12, Bedroom	Vinyl Sheet Flooring, Brown	Y	Good	ND
	3	2	Unit 12, Bedroom	Mastic, Brown	Y	Good	ND
B-031	3	3	Unit 12, Bedroom	Vinyl Sheet Flooring, Gray, Black	Y	Good	15% Chrysotile
	3	4	Unit 12, Bedroom	Mastic, Brown	Y	Good	2% Chrysotile



Table 1 - Asbestos Survey Results

Sample No.	Bldg. No.	Layer	Sample Location	Sample Description	Feasible Y/N	Condition	Asbestos Content
B-032	3	1	Unit 23, Restroom	Vinyl Sheet Flooring, White/Lt. Green	Y	Good	15% Chrysotile
	3	2	Unit 23, Restroom	Mastic, Brown	Y	Good	2% Chrysotile
	3	3	Unit 23, Restroom	Felt, Black	Y	Good	ND
B-033	3	1	Unit 23, Bedroom	Ceiling Tile, White/Yellow	Y	Damaged	ND
	4	1	Unit 35, Bedroom	28"x16" Ceiling Tile, White/Yellow	Y	Damaged	ND
B-035	4	1	Unit 35, Restroom	Drywall, White, Brown	N	Damaged	ND
	4	2	Unit 35, Restroom	Joint Compound, White	N	Damaged	2% Chrysotile
	4	3	Unit 35, Restroom	Texture, White	N	Damaged	2% Chrysotile
B-036	4	1	Unit 35, Restroom Ceiling	12"x12" Vinyl Floor Tile, Gray	N	Good	ND
	4	2	Unit 35, Restroom Ceiling	Mastic, Yellow	N	Good	ND
	4	3	Unit 35, Restroom Ceiling	Backing, Brown	N	Good	ND
B-037	4	1	Unit 38, Restroom	Drywall, White, Brown	N	Damaged	ND
	4	2	Unit 38, Restroom	Joint Compound, White	N	Damaged	ND
	4	3	Unit 38, Restroom	Texture, White	N	Damaged	ND
B-038	4	1	Unit 38, Restroom	12"x12" Vinyl Floor Tile, Gray	N	Good	ND
	4	2	Unit 38, Restroom	Mastic, Yellow	N	Good	ND
B-039	4	1	Unit 39, Bedroom Ceiling	12"x12" Textured Ceiling Tile, White/Yellow	Y	Damaged	ND
	4	1	Unit 39, Restroom Ceiling	Joint Compound, White	Y	Damaged	ND
B-040	4	2	Unit 39, Restroom Ceiling	Texture, White	Y	Damaged	ND
	2	1	Unit 10, Bedroom Ceiling	Drywall, White, Brown	Y	Damaged	ND
B-041	2	2	Unit 10, Bedroom Ceiling	Joint Compound, White	Y	Damaged	3% Chrysotile
	2	3	Unit 10, Bedroom Ceiling	Texture/Paint, White	Y	Damaged	2% Chrysotile

Table 1 - Asbestos Survey Results

Sample No.	Bldg No.	Layer	Sample Location	Sample Description	Friable Y/N	Condition	Asbestos Content
B-042	2	1	Roof	Roof Material, White, Black	N	Good	30% Chrysotile
	2	2	Roof	Roof Mastic, Black	N	Good	ND
	2	3	Roof	Roof Mastic, Black	N	Good	ND
B-043	2	1	Roof	Roof Mastic, Gray, Black	N	Good	ND
B-044	2	1	Roof	Vent Pipe, Beige, White	N	Good	20% Chrysotile
B-045	2	1	Roof Awning	Asphalt Shingle, White, Black	N	Good	2% Crocidolite
B-046	P	1	Pool	Pool Wall Material, White/Beige	N	Good	ND
B-047	P	1	Pool	Pool Concrete Edging, White/Tan	N	Good	ND
B-048	P	1	Pool House Roof	Asphalt Shingle, White, Black	N	Good	ND
	P	2	Pool House Roof	Felt, Black	N	Good	ND
B-049	5	1	Mechanical Room Roof	Rolled Roofing, Black/Orange/Beige	N	Good	ND
	5	2	Mechanical Room Roof	Rolled Roofing, Silver/Black	N	Good	ND
	5	3	Mechanical Room Roof	Rolled Roofing, Black	N	Good	5% Chrysotile
B-050	5	1	Unit 3, Bedroom Wall	Drywall, White, Brown	N	Good	ND
	5	2	Unit 3, Bedroom Wall	Joint Compound, White	N	Good	ND
B-051	5	1	Unit 3, Utility Room	12"x12" Vinyl Floor Tile, White, Gray	N	Good	ND
	5	2	Unit 3, Utility Room	Mastic, Yellow	N	Good	ND
B-052	5	1	Unit 3, Restroom Shower Wall	Ceramic Tile, White/Red	N	Good	ND
	5	2	Unit 3, Restroom Shower Wall	Mortar, Gray	N	Good	<1% Chrysotile
B-053	5	1	Unit 5, Bedroom Wall	Drywall, White, Brown	N	Good	ND
	5	2	Unit 5, Bedroom Wall	Joint Compound, White	N	Good	3% Chrysotile
B-054	5	1	Unit 5, Utility Room	12"x12" Vinyl Floor Tile, White, Gray	N	Good	ND
	5	2	Unit 5, Utility Room	Mastic, Yellow	N	Good	ND

Table 1 - Asbestos Survey Results

Sample No.	Bldg. No.	Layer	Sample Location	Sample Description	Releasable Y/N	Condition	Asbestos Content
B-055	5	1	Unit 5, Bedroom Ceiling	Drywall, White, Brown	N	Good	ND
	5	2	Unit 5, Bedroom Ceiling	Joint Compound, White	N	Good	3% Chrysotile
B-056	5	1	Unit 7, Restroom Wall	Drywall, White, Brown	N	Good	ND
	5	2	Unit 7, Restroom Wall	Joint Compound, White	N	Good	3% Chrysotile
B-057	5	1	Unit 7, Restroom	12"x12" Vinyl Floor Tile, White, Gray	N	Good	ND
	5	2	Unit 7, Restroom	Mastic, Yellow	N	Good	ND
B-058	5	1	Unit 9, Bedroom Wall	Drywall, White, Brown	N	Good	ND
	5	2	Unit 9, Bedroom Wall	Joint Compound, White	N	Good	3% Chrysotile
B-059	5	1	Roof	Rolled Roofing, Black/Orange/Beige	N	Good	ND
	5	2	Roof	Rolled Roofing, Black/Gray	N	Good	15% Chrysotile
	5	3	Roof	Rolled Roofing, Black	N	Good	ND
B-060	5	1	Roof	Roofing Mastic, Black	N	Good	10% Chrysotile
	4	1	Unit 48, Restroom	Drywall, White, Brown	N	Damaged	ND
B-061	4	2	Unit 48, Restroom	Joint Compound, White	N	Damaged	ND
	4	1	Unit 48, Restroom	12"x12" Vinyl Floor Tile, White/Gray	N	Good	ND
B-062	4	2	Unit 48, Restroom	Mastic, Tan	N	Good	ND
	4	1	Unit 49, Bedroom	28"x16" Ceiling Tile, White/Tan	Y	Damaged	ND
B-064	4	1	Unit 49, Bedroom	Drywall, Brown/Off-White	N	Damaged	ND
	4	2	Unit 49, Bedroom	Joint Compound, White	N	Damaged	ND
B-065	4	1	Unit 50, Restroom	Drywall, Brown/Off-White	N	Damaged	ND
	4	2	Unit 50, Restroom	Joint Compound, White	N	Damaged	ND
B-066	4	1	Managers Apartment, Roof	Asphalt Shingle Roof, Beige, Black	N	Good	ND
	4	2	Managers Apartment, Roof	Asphalt Shingle Roof, Felt, Black	N	Good	ND
B-067	4	1	Managers Apartment, Roof	Roofing Mastic, Black	N	Good	ND

Table 1 - Asbestos Survey Results

Sample No.	Bldg. No.	Layer	Sample Location	Sample Description	Friable Y/N	Condition	Asbestos Content
B-068	4	1	Managers Apartment, Entrance	Drywall, Brown/Off-White	N	Damaged	ND
	4	2	Managers Apartment, Entrance	Joint Compound, White	N	Damaged	3% Chrysotile
B-069	4	1	Managers Apartment, Living Room	Ceiling Tile, White/Tan, Grooved	Y	Damaged	ND
B-070	4	1	Managers Apartment, Family Room	Vinyl Sheet Flooring, Tan	Y	Good	20% Chrysotile
	4	2	Managers Apartment, Family Room	Mastic, Tan	Y	Good	3% Chrysotile

**NOTES:**  
 SF=Square Feet  
 EA=Each  
 ND=None Detected  
 N/A=Not Applicable  
 LF=Linear Feet

**TABLE 2**  
**SUMMARY OF PAINT CHIP ANALYTICAL RESULTS**

Field Sample No.	Building & Location	Component	Color	Total Lead PPM
PC-001	Bldg. 1, Unit 2	Plaster	Tan	1487
PC-002	Bldg. 1, Unit 5	Wood	Blue	2662
PC-003	Bldg. 1, SE Corner	Stucco	Pink	BRL *
PC-004	Bldg. 1, Unit 1 - Exterior	Wood	Dark Gray	131
PC-005	Bldg. 2, Unit 10 - Exterior	Wood	Light Blue	BRL
PC-006	Bldg. 3, Exterior Under Balcony	Wood	White	BRL
PC-007	Bldg. 3, 2nd Floor-Exterior Balcony Ceiling	Wood	White	119
PC-008	Bldg. 4, Unit 34 Restroom	Drywall	White	BRL
PC-009	Bldg. 4, Unit 35 - Exterior	Wood	Blue	788
PC-010	Bldg. 4, unit 36 - Exterior	Wood	Pink	193
PC-011	Bldg. 4, Unit 37 - Exterior	Wood	White	BRL
PC-012	Bldg. 3, Stair Railing(2)	Metal	White	BRL
PC-013	Pool, Siding - SE Corner	Concrete	Blue	558
PC-014	Bldg. 5, Unit 6	Wood	Pink	994
PC-015	Bldg. 5, Unit 6	Wood	Blue	405
PC-016	Bldg. 5, Unit 4	Wood	Dark Blue	279
PC-017	Bldg. 4, Unit 43	Wood	Pink	195
PC-018	Bldg. 4, Unit 44	Wood	Blue	BRL
PC-019	Bldg. 4, Unit 45	Wood	White	1124

**NOTES:**

Total Lead analyzed by EPA Test Method 8270.

ND = Not detected at the reported detection limit.

PPM = Parts Per Million also known as mg/kg (milligrams per kilogram)

BRL = Below reportable limits

\* = Excessive substrate may bias sample results

Silver Strike Motel  
 201 N. Main Street  
 Tonopah, Nevada

March 31, 2003  
 Project No. 301218001

Table 3 - Summary of Hazardous Building Materials

Material Location	Transformers	Number of Light Ballast	Number of Thermostats/ Switches	Number of A/C Units	Number of Fluorescent light tubes	Number of Exit Signs	Miscellaneous
Building 1	0	18	0	0	18	0	0
Building 2	0	0	0	1	0	0	0
Building 3	0	2	0	10	15	0	1-Refrigerator
Building 4	0	8	0	14	8	0	1-Lead-acid Battery
Building 5	0	0	0	7	0	0	

NOTES:  
 A/C = Air  
 Conditioning

Nye County Grants Administrative Office  
Silver Strike Motel, Tonopah, Nevada

March 31, 2003  
Project No. 301218001

---

**APPENDIX H**  
**Asbestos and Lead-based Paint Laboratory Reports**  
**And Chain of Custody Records**

# EMC LABS, INC.

9830 S. 51st Street, Suite B109, Phoenix, AZ 85044  
 Phone: 800-362-3373 or 480-940-5294 - Fax: (480) 893-1726

Laboratory Report  
**0009557**

## Bulk Asbestos Analysis by Polarized Light Microscopy

NVLAP#101926-0

Client:	NINYO & MOORE	Job# / P.O. #:	301218001
Address:	3155 E. PATRICK LANE, STE 12	Date Received:	03/12/2003
	LAS VEGAS NV 89120	Date Analyzed:	03/12/2003
Collected:	03/06/2003	Date Reported:	03/12/2003
Project Name/	TONOPAH/PINK MOTEL	EPA Method:	EPA 600/M4-82-020
Address:	201 MAIN STREET	Submitted By:	ROBERT TROISI
		Collected By:	Customer

Lab ID Client ID	Sample Location	Layer Name / Sample Description	Asbestos Detected	Asbestos Type (%)	Non-Asbestos Constituents
0009557-001 B-01	BLDG 1-UNIT 2 WALL SYSTEM	LAYER# 1 Wall Plaster, Beige	No		Quartz Gypsum Mica Binder/Filler 100%
		LAYER# 2 Wall Texture, White	No		Cellulose Fiber <1% Carbonates Gypsum Mica Binder/Filler 99%
		LAYER# 3 Wallboard, Tan	No		Cellulose Fiber 95% Binder/Filler 5%
0009557-002 B-02	BLDG 1-UNIT 2 WALL SYSTEM	LAYER# 1 Wall Plaster, Beige	No		Quartz Gypsum Mica Binder/Filler 100%
		LAYER# 2 Wall Texture, White	No		Cellulose Fiber <1% Carbonates Gypsum Mica Binder/Filler 99%
		LAYER# 3 Joint Compound, Beige	Yes	Chrysotile 2%	Carbonates Mica Quartz Binder/Filler 98%
0009557-003 B-03	NE CORNER BLDG #1 EXT. WALL	Exterior Stucco, Beige	No		Quartz Gypsum Carbonates Mica Binder/Filler 100%



# EMC LABS, INC.

9830 S. 51st Street, Suite B109, Phoenix, AZ 85044  
 Phone: 800-362-3373 or 480-940-5294 - Fax: (480) 893-1726

Laboratory Report  
**0009557**

## Bulk Asbestos Analysis by Polarized Light Microscopy

NVLAP#101926-0

Client: NINYO & MOORE	Job# / P.O. #: 301218001
Address: 3155 E. PATRICK LANE, STE 12	Date Received: 03/12/2003
LAS VEGAS NV 89120	Date Analyzed: 03/12/2003
Collected: 03/06/2003	Date Reported: 03/12/2003
Project Name/ TONOPAH/PINK MOTEL	EPA Method: EPA 600/M4-82-020
Address: 201 MAIN STREET	Submitted By: ROBERT TROISI
	Collected By: Customer

Lab ID Client ID	Sample Location	Layer Name / Sample Description	Asbestos Detected	Asbestos Type (%)	Non-Asbestos Constituents
0009557-004 B-04	BLDG 1 UNIT 3 BEDRM	LAYER# 1 9x9 Floor Tile, Red/ Brown	Yes	Chrysotile 10%	Carbonates Gypsum Mica Quartz Binder/Filler 90%
		LAYER# 2 Mastic, Black	Yes	Chrysotile 10%	Carbonates Binder/Filler 90%
0009557-005 B-05	BLDG 1 UNIT 1 BEDRM	LAYER# 1 9x9 Floor Tile, Gray	Yes	Chrysotile 10%	Carbonates Gypsum Quartz Mica Binder/Filler 90%
		LAYER# 2 Mastic, Black	Yes	Chrysotile 10%	Cellulose Fiber 1% Carbonates Binder/Filler 89%
0009557-006 B-06	BLDG 1 UNIT 1 BATHRM	LAYER# 1 Vinyl Sheet Flooring, Tan	Yes	Chrysotile 20%	Cellulose Fiber 2% Gypsum Carbonates Binder/Filler 78%
		LAYER# 2 Mastic, Tan Note: Difficult to separate adjacent layers	Yes	Chrysotile 2%	Gypsum Binder/Filler 98%

# EMC LABS, INC.

9830 S. 51st Street, Suite B109, Phoenix, AZ 85044  
 Phone: 800-362-3373 or 480-940-5294 - Fax: (480) 893-1726

Laboratory Report  
**0009557**

## Bulk Asbestos Analysis by Polarized Light Microscopy

NVLAP#101926-0

Client:	NINYO & MOORE	Job# / P.O. #:	301218001
Address:	3155 E. PATRICK LANE, STE 12	Date Received:	03/12/2003
	LAS VEGAS NV 89120	Date Analyzed:	03/12/2003
Collected:	03/06/2003	Date Reported:	03/12/2003
Project Name/	TONOPAHA/PINK MOTEL	EPA Method:	EPA 600/M4-82-020
Address:	201 MAIN STREET	Submitted By:	ROBERT TROISI
		Collected By:	Customer

Lab ID Client ID	Sample Location	Layer Name / Sample Description	Asbestos Detected	Asbestos Type (%)	Non-Asbestos Constituents
0009557-007 B-07	BLDG 1 UNIT 3 BATHRM	LAYER# 1 Vinyl Sheet Flooring, Brown	No		Cellulose Fiber 20% Fibrous Glass 2%
		LAYER# 2 Mastic, Tan	No		Gypsum Perlite Quartz Binder/Filler 78% Cellulose Fiber 2% Gypsum Binder/Filler 98%
0009557-008 B-08	BLDG 1 UNIT 4 WALL SYSTEM	LAYER# 1 Wall Plaster, Beige	No		Quartz Gypsum Mica Binder/Filler 100%
		LAYER# 2 Wall Texture, White	No		Gypsum Carbonates Mica Quartz Binder/Filler 100%
		LAYER# 3 Wallboard, Tan	No		Cellulose Fiber 95% Binder/Filler 5%
0009557-009 B-09	BLDG 1 UNIT 4 SHOWER STALL	LAYER# 1 Shower Wall, White, Brown	No		Cellulose Fiber 80%
		LAYER# 2 Mastic, Red	No		Gypsum Binder/Filler 20% Cellulose Fiber 2% Gypsum Binder/Filler 98%

# EMC LABS, INC.

9830 S. 51st Street, Suite B109, Phoenix, AZ 85044  
 Phone: 800-362-3373 or 480-940-5294 - Fax: (480) 893-1726

Laboratory Report  
**0009557**

## Bulk Asbestos Analysis by Polarized Light Microscopy

NVLAP#101926-0

Client:	NINYO & MOORE	Job# / P.O. #:	301218001
Address:	3155 E. PATRICK LANE, STE 12	Date Received:	03/12/2003
	LAS VEGAS NV 89120	Date Analyzed:	03/12/2003
Collected:	03/06/2003	Date Reported:	03/12/2003
Project Name/	TONOPAH/PINK MOTEL	EPA Method:	EPA 600/M4-82-020
Address:	201 MAIN STREET	Submitted By:	ROBERT TROISI
		Collected By:	Customer

Lab ID Client ID	Sample Location	Layer Name / Sample Description	Asbestos Detected	Asbestos Type (%)	Non-Asbestos Constituents
0009557-010 B-010	BLDG 1 UNIT 3 BATHRM	LAYER# 1 Ceramic Tile, Red/ White	No		Gypsum Quartz Binder/Filler 100%
		LAYER# 2 Grout, Off White	No		Carbonates Gypsum Binder/Filler 100%
		LAYER# 3 Mastic, Tan/ Black	Yes	Chrysotile 10%	Gypsum Carbonates Binder/Filler 90%
0009557-011 B-011	SW CORNER BLDG 1 EXT. WALL	LAYER# 1 Ext. Stucco-Scratch Coat, Beige	No		Quartz Gypsum Mica Binder/Filler 100%
		LAYER# 2 Ext. Stucco-Finish Coat, White/ Pink	No		Quartz Gypsum Mica Binder/Filler 100%
		LAYER# 3 Concrete Bricks, Beige, White	No		Carbonates Perlite Quartz Binder/Filler 100%

# EMC LABS, INC.

9830 S. 51st Street, Suite B109, Phoenix, AZ 85044  
 Phone: 800-362-3373 or 480-940-5294 - Fax: (480) 893-1726

Laboratory Report  
**0009557**

## Bulk Asbestos Analysis by Polarized Light Microscopy

NVLAP#101926-0

Client:	NINYO & MOORE	Job# / P.O. #:	301218001
Address:	3155 E. PATRICK LANE, STE 12	Date Received:	03/12/2003
	LAS VEGAS NV 89120	Date Analyzed:	03/12/2003
Collected:	03/06/2003	Date Reported:	03/12/2003
Project Name/	TONOPAHO/PINK MOTEL	EPA Method:	EPA 600/M4-82-020
Address:	201 MAIN STREET	Submitted By:	ROBERT TROISI
		Collected By:	Customer

Lab ID Client ID	Sample Location	Layer Name / Sample Description	Asbestos Detected	Asbestos Type (%)	Non-Asbestos Constituents
0009557-012 B-012	BLDG 1 UNIT 3 BATHRM	LAYER# 1 Wall Plaster, Beige Note: No Joint Compound Present	No		Quartz Gypsum Mica Binder/Filler 100%
		LAYER# 2 Wall Texture, White	No		Cellulose Fiber <1% Gypsum Carbonates Mica Quartz Binder/Filler 99%
0009557-013 B-013	BLDG 2 UNIT 7 WALL SYSTEM	LAYER# 1 Wall Plaster, Beige	No		Quartz Gypsum Mica Binder/Filler 100%
		LAYER# 2 Wall Texture, White	No		Quartz Gypsum Mica Binder/Filler 100%
		LAYER# 3 Wallboard, Tan	No		Cellulose Fiber 10% Gypsum Carbonates Mica Quartz Binder/Filler 90%

# EMC LABS, INC.

9830 S. 51st Street, Suite B109, Phoenix, AZ 85044  
 Phone: 800-362-3373 or 480-940-5294 - Fax: (480) 893-1726

Laboratory Report  
**0009557**

## Bulk Asbestos Analysis by Polarized Light Microscopy

NVLAP#101926-0

Client:	NINYO & MOORE	Job# / P.O. #:	301218001
Address:	3155 E. PATRICK LANE, STE 12	Date Received:	03/12/2003
	LAS VEGAS NV 89120	Date Analyzed:	03/12/2003
Collected:	03/06/2003	Date Reported:	03/12/2003
Project Name/	TONOPAHA/PINK MOTEL	EPA Method:	EPA 600/M4-82-020
Address:	201 MAIN STREET	Submitted By:	ROBERT TROISI
		Collected By:	Customer

Lab ID Client ID	Sample Location	Layer Name / Sample Description	Asbestos Detected	Asbestos Type (%)	Non-Asbestos Constituents
0009557-014 B-014	BLDG 2 UNIT 8 CEILING	LAYER# 1 Drywall, Brown/ Off White	No		Cellulose Fiber 10%
		LAYER# 2 Texture, White	Yes	Chrysotile 2%	Gypsum Carbonates Mica Quartz Binder/Filler 90%
0009557-015 B-015	BLDG 2 UNIT 10 BATHRM	LAYER# 1 Ceramic Tile, Gray/ White	No		Gypsum Quartz Binder/Filler 100%
		LAYER# 2 Grout, Gray	No		Quartz Gypsum Carbonates Mica Binder/Filler 100%
		LAYER# 3 Grout, Beige	No		Quartz Gypsum Carbonates Mica Binder/Filler 100%

# EMC LABS, INC.

9830 S. 51st Street, Suite B109, Phoenix, AZ 85044  
 Phone: 800-362-3373 or 480-940-5294 - Fax: (480) 893-1726

Laboratory Report  
**0009557**

## Bulk Asbestos Analysis by Polarized Light Microscopy

NVLAP#101926-0

Client:	NINYO & MOORE	Job# / P.O. #:	301218001
Address:	3155 E. PATRICK LANE, STE 12	Date Received:	03/12/2003
	LAS VEGAS NV 89120	Date Analyzed:	03/12/2003
Collected:	03/06/2003	Date Reported:	03/12/2003
Project Name/	TONOPAHA/PINK MOTEL	EPA Method:	EPA 600/M4-82-020
Address:	201 MAIN STREET	Submitted By:	ROBERT TROISI
		Collected By:	Customer

Lab ID Client ID	Sample Location	Layer Name / Sample Description	Asbestos Detected	Asbestos Type (%)	Non-Asbestos Constituents
0009557-016 B-016	BLDG 2 UNIT 9 BEDRM	LAYER# 1 Drywall, Brown/ Off White	No		Cellulose Fiber 10%
		LAYER# 2 Joint Compound, White	No		Gypsum Carbonates Mica Quartz Binder/Filler 90%
0009557-017 B-017	BLDG 2 UNIT 10 BEDRM	Wall Plaster, Beige	No		Carbonates Gypsum Mica Binder/Filler 100%
					Quartz Gypsum Carbonates Mica Binder/Filler 100%
0009557-018 B-018	BLDG 3 OFFICE KITCHEN AREA	LAYER# 1 Vinyl Sheet Flooring, Brown, Tan	Yes	Chrysotile 20%	Cellulose Fiber 2%
		LAYER# 2 Mastic, Tan	Yes	Chrysotile 2%	Gypsum Binder/Filler 78%
					Cellulose Fiber 1%
					Gypsum Binder/Filler 97%

# EMC LABS, INC.

9830 S. 51st Street, Suite B109, Phoenix, AZ 85044  
 Phone: 800-362-3373 or 480-940-5294 - Fax: (480) 893-1726

Laboratory Report  
**0009557**

## Bulk Asbestos Analysis by Polarized Light Microscopy

NVLAP#101926-0

Client: NINYO & MOORE	Job# / P.O. #: 301218001
Address: 3155 E. PATRICK LANE, STE 12	Date Received: 03/12/2003
LAS VEGAS NV 89120	Date Analyzed: 03/12/2003
Collected: 03/06/2003	Date Reported: 03/12/2003
Project Name/ TONOPAH/PINK MOTEL	EPA Method: EPA 600/M4-82-020
Address: 201 MAIN STREET	Submitted By: ROBERT TROISI
	Collected By: Customer

Lab ID Client ID	Sample Location	Layer Name / Sample Description	Asbestos Detected	Asbestos Type (%)	Non-Asbestos Constituents
0009557-019 B-019	BLDG 3 UNIT 19 BEDRM	LAYER# 1 Drywall, Brown/ Off White	No		Cellulose Fiber 10%
		LAYER# 2 Joint Compound, White	Yes	Chrysotile 2%	Gypsum Carbonates Mica Quartz Binder/Filler 90%
		LAYER# 3 Texture, White	Yes	Chrysotile 3%	Cellulose Fiber <1% Carbonates Mica Quartz Binder/Filler 97%
0009557-020 B-020	BLDG 3 UNIT 19 BEDRM	Ceiling Tile, White/ Tan	No		Cellulose Fiber 95%
					Binder/Filler 5%
0009557-021 B-021	BLDG 3 UNIT 28 BEDRM	LAYER# 1 Drywall, Brown/ Off White	No		Cellulose Fiber 10%
		LAYER# 2 Joint Compound, White Note: Very small amount of sample- may effect analysis	Yes	Chrysotile 2%	Gypsum Carbonates Mica Binder/Filler 90%
0009557-022 B-022	BLDG 3 UNIT 28 BEDRM	Ceiling Tile, White/ Tan	No		Cellulose Fiber 95%
					Carbonates Binder/Filler 5%

# EMC LABS, INC.

9830 S. 51st Street, Suite B109, Phoenix, AZ 85044  
Phone: 800-362-3373 or 480-940-5294 - Fax: (480) 893-1726

Laboratory Report  
**0009557**

## Bulk Asbestos Analysis by Polarized Light Microscopy

NVLAP#101926-0

Client:	NINYO & MOORE	Job# / P.O. #:	301218001
Address:	3155 E. PATRICK LANE, STE 12 LAS VEGAS NV 89120	Date Received:	03/12/2003
Collected:	03/06/2003	Date Analyzed:	03/12/2003
Project Name/	TONOPAHO/PINK MOTEL	Date Reported:	03/12/2003
Address:	201 MAIN STREET	EPA Method:	EPA 600/M4-82-020
		Submitted By:	ROBERT TROISI
		Collected By:	Customer

Lab ID Client ID	Sample Location	Layer Name / Sample Description	Asbestos Detected	Asbestos Type (%)	Non-Asbestos Constituents
0009557-023 B-023	BLDG 3 UNIT 20 RESTRM	LAYER# 1 Vinyl Sheet Flooring, Tan/ White	Yes	Chrysotile 20%	Gypsum Binder/Filler 80%
		LAYER# 2 Mastic, Tan Note: Difficult to separate adjacent layers	Yes	Chrysotile 2%	Cellulose Fiber 1% Gypsum Binder/Filler 97%
0009557-024 B-024	BLDG 3 UNIT 20 BEDRM	Ceiling Tile, White/ Tan	No		Cellulose Fiber 90%
					Carbonates Binder/Filler 10%
0009557-025 B-025	BLDG 3 OFFICE MAIN OFFICE	LAYER# 1 9x9 Vinyl Floor Tile, Brown	Yes	Chrysotile 3%	Carbonates Gypsum Quartz Mica Binder/Filler 97%
		LAYER# 2 Mastic, Black	Yes	Chrysotile 10%	Carbonates Binder/Filler 90%
0009557-026 B-026	BLDG 3 UNIT 18 RESTRM	LAYER# 1 12x12 Vinyl Floor Tile, White, Gray	No		Carbonates Quartz Binder/Filler 100%
		LAYER# 2 Mastic, White, Silver	No		Carbonates Gypsum Quartz Binder/Filler 100%



# EMC LABS, INC.

9830 S. 51st Street, Suite B109, Phoenix, AZ 85044  
 Phone: 800-362-3373 or 480-940-5294 - Fax: (480) 893-1726

Laboratory Report  
**0009557**

## Bulk Asbestos Analysis by Polarized Light Microscopy

NVLAP#101926-0

Client:	NINYO & MOORE	Job# / P.O. #:	301218001
Address:	3155 E. PATRICK LANE, STE 12	Date Received:	03/12/2003
	LAS VEGAS NV 89120	Date Analyzed:	03/12/2003
Collected:	03/06/2003	Date Reported:	03/12/2003
Project Name/	TONOPAH/PINK MOTEL	EPA Method:	EPA 600/M4-82-020
Address:	201 MAIN STREET	Submitted By:	ROBERT TROISI
		Collected By:	Customer

Lab ID Client ID	Sample Location	Layer Name / Sample Description	Asbestos Detected	Asbestos Type (%)	Non-Asbestos Constituents
0009557-027 B-027	BLDG 3 UNIT 19 RESTRM	LAYER# 1 Vinyl Floor Tile, White, Gray	Yes	Chrysotile 15%	Carbonates Gypsum Binder/Filler 85%
		LAYER# 2 Mastic, Black, Brown Note: Difficult to separate adjacent layers	Yes	Chrysotile 2%	Carbonates Gypsum Binder/Filler 98%
0009557-028 B-028	BLDG 3 UNIT 27 RESTRM	LAYER# 1 Vinyl Floor Tile, White/ Gold	Yes	Chrysotile 5%	Carbonates Quartz Binder/Filler 95%
		LAYER# 2 Mastic, Yellow	No		Gypsum Binder/Filler 100%
		LAYER# 3 Vinyl Sheet Flooring, Beige	Yes	Chrysotile 15%	Carbonates Gypsum Binder/Filler 85%
		LAYER# 4 Mastic, Brown	Yes	Chrysotile 2%	Cellulose Fiber Gypsum Binder/Filler 97%

# EMC LABS, INC.

9830 S. 51st Street, Suite B109, Phoenix, AZ 85044  
Phone: 800-362-3373 or 480-940-5294 - Fax: (480) 893-1726

Laboratory Report  
**0009557**

## Bulk Asbestos Analysis by Polarized Light Microscopy

NVLAP#101926-0

Client: NINYO & MOORE	Job# / P.O. #: 301218001
Address: 3155 E. PATRICK LANE, STE 12	Date Received: 03/12/2003
LAS VEGAS NV 89120	Date Analyzed: 03/12/2003
Collected: 03/06/2003	Date Reported: 03/12/2003
Project Name/ TONOPAH/PINK MOTEL	EPA Method: EPA 600/M4-82-020
Address: 201 MAIN STREET	Submitted By: ROBERT TROISI
	Collected By: Customer

Lab ID Client ID	Sample Location	Layer Name / Sample Description	Asbestos Detected	Asbestos Type (%)	Non-Asbestos Constituents
0009557-029 B-029	BLDG 3 UNIT 17 RESTRM	LAYER# 1 Vinyl Sheet Flooring, Brown	No		Cellulose Fiber 20% Fibrous Glass 2%
		LAYER# 2 Mastic, Yellow Note: Difficult to separate adjacent layers	No		Gypsum Quartz Binder/Filler 78% Cellulose Fiber 2%
		LAYER# 3 Leveling Compound, White	Yes	Chrysotile 3%	Gypsum Binder/Filler 98%
0009557-030 B-030	BLDG 3 UNIT 12 BEDRM	Texture Ceiling Tile, White/ Yellow	No		Carbonates Mica Quartz Binder/Filler 97%
					Cellulose Fiber 95% Binder/Filler 5%
0009557-031 B-031	BLDG 3 UNIT 12 RESTRM	LAYER# 1 Vinyl Sheet Flooring, Brown	No		Cellulose Fiber 15% Fibrous Glass 2%
		LAYER# 2 Mastic, Brown	No		Gypsum Quartz Binder/Filler 83% Cellulose Fiber 2%
		LAYER# 3 Vinyl Sheet Flooring, Gray, Black	Yes	Chrysotile 15%	Gypsum Binder/Filler 98%
		LAYER# 4 Mastic, Brown	Yes	Chrysotile 2%	Gypsum Carbonates Binder/Filler 85% Cellulose Fiber <1% Gypsum Quartz Binder/Filler 97%

# EMC LABS, INC.

9830 S. 51st Street, Suite B109, Phoenix, AZ 85044  
 Phone: 800-362-3373 or 480-940-5294 - Fax: (480) 893-1726

Laboratory Report  
**0009557**

## Bulk Asbestos Analysis by Polarized Light Microscopy

NVLAP#101926-0

Client:	NINYO & MOORE	Job# / P.O. #:	301218001
Address:	3155 E. PATRICK LANE, STE 12 LAS VEGAS NV 89120	Date Received:	03/12/2003
Collected:	03/06/2003	Date Analyzed:	03/12/2003
Project Name/	TONOPA/PINK MOTEL	Date Reported:	03/12/2003
Address:	201 MAIN STREET	EPA Method:	EPA 600/M4-82-020
		Submitted By:	ROBERT TROISI
		Collected By:	Customer

Lab ID Client ID	Sample Location	Layer Name / Sample Description	Asbestos Detected	Asbestos Type (%)	Non-Asbestos Constituents
0009557-032 B-032	BLDG 3 UNIT 23 RESTRM	LAYER# 1 Vinyl Sheet Flooring, White/ Lt. Green	Yes	Chrysotile 15%	Gypsum Binder/Filler 85%
		LAYER# 2 Mastic, Brown	Yes	Chrysotile 2%	Gypsum Binder/Filler 98%
		LAYER# 3 Felt, Black	No		Cellulose Fiber 30% Carbonates Binder/Filler 70%
0009557-033 B-033	BLDG 3 UNIT 23 BEDRM	Ceiling Tile, White/ Yellow	No		Cellulose Fiber 95% Binder/Filler 5%
0009557-034 B-034	BLDG 4 UNIT 35 BEDRM	28x16 Ceiling Tile, White/ Yellow	No		Cellulose Fiber 95% Binder/Filler 5%
0009557-035 B-035	BLDG 4 UNIT 35 RESTRM	LAYER# 1 Drywall, White, Brown	No		Cellulose Fiber 10% Gypsum Carbonates Mica Quartz Binder/Filler 90%
		LAYER# 2 Joint Compound, White	Yes	Chrysotile 2%	Carbonates Mica Quartz Binder/Filler 98%
		LAYER# 3 Texture, White	Yes	Chrysotile 2%	Carbonates Mica Quartz Binder/Filler 98%

# EMC LABS, INC.

9830 S. 51st Street, Suite B109, Phoenix, AZ 85044  
 Phone: 800-362-3373 or 480-940-5294 - Fax: (480) 893-1726

Laboratory Report  
**0009557**

## Bulk Asbestos Analysis by Polarized Light Microscopy

NVLAP#101926-0

Client:	NINYO & MOORE	Job# / P.O. #:	301218001
Address:	3155 E. PATRICK LANE, STE 12 LAS VEGAS NV 89120	Date Received:	03/12/2003
Collected:	03/06/2003	Date Analyzed:	03/12/2003
Project Name/	TONOPAH/PINK MOTEL	Date Reported:	03/12/2003
Address:	201 MAIN STREET	EPA Method:	EPA 600/M4-82-020
		Submitted By:	ROBERT TROISI
		Collected By:	Customer

Lab ID Client ID	Sample Location	Layer Name / Sample Description	Asbestos Detected	Asbestos Type (%)	Non-Asbestos Constituents
0009557-036 B-036	BLDG 4 UNIT 35 RESTRM CEILNG	LAYER# 1 12x12 Vinyl Floor Tile, Gray	No		Carbonates Quartz Binder/Filler 100%
		LAYER# 2 Mastic, Yellow	No		Gypsum Binder/Filler 100%
		LAYER# 3 Backing, Brown	No		Cellulose Fiber 65% Fibrous Glass 5% Gypsum Quartz Binder/Filler 30%
0009557-037 B-037	BLDG 4 UNIT 38 RESTRM	LAYER# 1 Drywall, White, Brown	No		Cellulose Fiber 10% Fibrous Glass 2% Gypsum Carbonates Mica Quartz Binder/Filler 88%
		LAYER# 2 Joint Compound, White	No		Carbonates Quartz Binder/Filler 100%
		LAYER# 3 Texture, White	No		Carbonates Quartz Binder/Filler 100%
0009557-038 B-038	BLDG 4 UNIT 38 RESTRM	LAYER# 1 12x12 Vinyl Floor Tile, Gray	No		Carbonates Binder/Filler 100%
		LAYER# 2 Mastic, Yellow	No		Gypsum Carbonates Quartz Binder/Filler 100%

# EMC LABS, INC.

9830 S. 51st Street, Suite B109, Phoenix, AZ 85044  
 Phone: 800-362-3373 or 480-940-5294 - Fax: (480) 893-1726

Laboratory Report  
**0009557**

## Bulk Asbestos Analysis by Polarized Light Microscopy

NVLAP#101926-0

Client:	NINYO & MOORE	Job# / P.O. #:	301218001
Address:	3155 E. PATRICK LANE, STE 12 LAS VEGAS NV 89120	Date Received:	03/12/2003
Collected:	03/06/2003	Date Analyzed:	03/12/2003
Project Name/	TONOPAHA/PINK MOTEL	Date Reported:	03/12/2003
Address:	201 MAIN STREET	EPA Method:	EPA 600/M4-82-020
		Submitted By:	ROBERT TROISI
		Collected By:	Customer

Lab ID Client ID	Sample Location	Layer Name / Sample Description	Asbestos Detected	Asbestos Type (%)	Non-Asbestos Constituents
0009557-039 B-039	BLDG 4 UNIT 39 BEDRM CEILING	12x12 Textured Ceiling Tile, White/ Yellow	No		Cellulose Fiber 95% Binder/Filler 5%
		LAYER# 1 Joint Compound, White	No		Carbonates Mica Quartz Binder/Filler 100%
0009557-040 B-040	BLDG 4 UNIT 39 RESTRM CEILING	LAYER# 2 Texture, White	No		Carbonates Mica Quartz Binder/Filler 100%
		LAYER# 1 Drywall, White, Brown	No		Cellulose Fiber 10% Gypsum Carbonates Mica Quartz Binder/Filler 90%
		LAYER# 2 Joint Compound, White	Yes	Chrysotile 3%	Carbonates Mica Quartz Binder/Filler 97%
0009557-041 B-041	BLDG 2 UNIT 10 BEDRM CEILING	LAYER# 3 Texture/Paint, White	Yes	Chrysotile 2%	Cellulose Fiber <1% Carbonates Mica Quartz Binder/Filler 97%

# EMC LABS, INC.

9830 S. 51st Street, Suite B109, Phoenix, AZ 85044  
Phone: 800-362-3373 or 480-940-5294 - Fax: (480) 893-1726

Laboratory Report  
**0009557**

## Bulk Asbestos Analysis by Polarized Light Microscopy

NVLAP#101926-0

Client:	NINYO & MOORE	Job# / P.O. #:	301218001
Address:	3155 E. PATRICK LANE, STE 12 LAS VEGAS NV 89120	Date Received:	03/12/2003
Collected:	03/06/2003	Date Analyzed:	03/12/2003
Project Name/	TONOPAHA/PINK MOTEL	Date Reported:	03/12/2003
Address:	201 MAIN STREET	EPA Method:	EPA 600/M4-82-020
		Submitted By:	ROBERT TROISI
		Collected By:	Customer

Lab ID Client ID	Sample Location	Layer Name / Sample Description	Asbestos Detected	Asbestos Type (%)	Non-Asbestos Constituents
0009557-042 B-042	BLDG 2 ROOF	LAYER# 1 Roof Material, White, Black	Yes	Chrysotile 30%	Cellulose Fiber 5% Fibrous Glass 3% Carbonates Binder/Filler 62%
		LAYER# 2 Roof Mastic, Black	No		Cellulose Fiber 40% Carbonates Binder/Filler 60%
		LAYER# 3 Roof Mastic, Black	No		Cellulose Fiber 40% Carbonates Binder/Filler 60%
0009557-043 B-043	BLDG 2 ROOF	Roof Mastic, Gray, Black	No		Cellulose Fiber 10% Carbonates Binder/Filler 90%
0009557-044 B-044	BLDG 2 ROOF	Vent Pipe, Beige, White	Yes	Chrysotile 20% Crocidolite 2%	Carbonates Gypsum Quartz Binder/Filler 78%
0009557-045 B-045	BLDG 2 AWNING ROOF	Asphalt Shingle, White, Black	No		Cellulose Fiber 25% Carbonates Quartz Binder/Filler 75%
0009557-046 B-046	POOL STEPS	Pool Wall Material, White/ Beige	No		Carbonates Quartz Binder/Filler 100%
0009557-047 B-047	POOL CONCRETE EDGING	Pool Concrete Edging, White/ Tan	No		Quartz Carbonates Gypsum Mica Binder/Filler 100%

# EMC LABS, INC.

9830 S. 51st Street, Suite B109, Phoenix, AZ 85044  
 Phone: 800-362-3373 or 480-940-5294 - Fax: (480) 893-1726

Laboratory Report  
**0009557**

## Bulk Asbestos Analysis by Polarized Light Microscopy

NVLAP#101926-0

Client:	NINYO & MOORE	Job# / P.O. #:	301218001
Address:	3155 E. PATRICK LANE, STE 12	Date Received:	03/12/2003
	LAS VEGAS NV 89120	Date Analyzed:	03/12/2003
Collected:	03/06/2003	Date Reported:	03/12/2003
Project Name/	TONOPAH/PINK MOTEL	EPA Method:	EPA 600/M4-82-020
Address:	201 MAIN STREET	Submitted By:	ROBERT TROISI
		Collected By:	Customer

Lab ID Client ID	Sample Location	Layer Name / Sample Description	Asbestos Detected	Asbestos Type (%)	Non-Asbestos Constituents
0009557-048 B-048	POOL HOUSE ROOF	LAYER# 1 Asphalt Shingle, White, Black	No		Cellulose Fiber 25%
		LAYER# 2 Felt, Black	No		Carbonates Quartz Binder/Filler 75% Cellulose Fiber 35% Carbonates Binder/Filler 65%
0009557-049 B-049	BLDG 5 MECH RM ROOF	LAYER# 1 Rolled Roofing, Black/Orange/Beige	No		Fibrous Glass 20% Carbonates Quartz Binder/Filler 80%
		LAYER# 2 Rolled Roofing, Silver/Black	No		Carbonates Binder/Filler 100%
		LAYER# 3 Rolled Roofing, Black	Yes	Chrysotile 5%	Cellulose Fiber 30% Carbonates Binder/Filler 65%
0009557-050 B-050	BLDG 5 UNIT 3 BEDRM WALL	LAYER# 1 Drywall, White, Brown	No		Cellulose Fiber 10% Quartz Mica Gypsum Carbonates 90%
		LAYER# 2 Joint Compound, White	No		Quartz Mica Carbonates 100%

# EMC LABS, INC.

Laboratory Report

0009557

9830 S. 51st Street, Suite B109, Phoenix, AZ 85044  
Phone: 800-362-3373 or 480-940-5294 - Fax: (480) 893-1726

## Bulk Asbestos Analysis by Polarized Light Microscopy

NVLAP#101926-0

Client: NINYO & MOORE	Job# / P.O. #: 301218001
Address: 3155 E. PATRICK LANE, STE 12	Date Received: 03/12/2003
LAS VEGAS NV 89120	Date Analyzed: 03/12/2003
Collected: 03/06/2003	Date Reported: 03/12/2003
Project Name/ TONOPAH/PINK MOTEL	EPA Method: EPA 600/M4-82-020
Address: 201 MAIN STREET	Submitted By: ROBERT TROISI
	Collected By: Customer

Lab ID Client ID	Sample Location	Layer Name / Sample Description	Asbestos Detected	Asbestos Type (%)	Non-Asbestos Constituents
0009557-051 B-051	BLDG 5 UNIT 3 UTILITY RM FL	LAYER# 1 12x12 VFT, White/Gray	No		Quartz Carbonates Binder/Filler 100%
		LAYER# 2 Mastic, Yellow	No		Carbonates Binder/Filler 100%
0009557-052 B-052	BLDG 5 UNIT 3 RESTRM SHOWER WALL	LAYER# 1 Ceramic Tile, White/Red	No		Quartz Gypsum Binder/Filler 100%
		LAYER# 2 Mortar, Gray	Yes	Chrysotile <1%	Quartz Mica Carbonates Binder/Filler 99%
0009557-053 B-053	BLDG 5 UNIT 5 BEDRM WALL	LAYER# 1 Drywall, White, Brown	No		Cellulose Fiber 10%
		LAYER# 2 Joint Compound, White	Yes	Chrysotile 3%	Quartz Mica Gypsum Carbonates 90%
					Quartz Mica Carbonates Binder/Filler 97%



# EMC LABS, INC.

Laboratory Report

0009557

9830 S. 51st Street, Suite B109, Phoenix, AZ 85044  
Phone: 800-362-3373 or 480-940-5294 - Fax: (480) 893-1726

## Bulk Asbestos Analysis by Polarized Light Microscopy

NVLAP#101926-0

Client: NINYO & MOORE	Job# / P.O. #: 301218001
Address: 3155 E. PATRICK LANE, STE 12	Date Received: 03/12/2003
LAS VEGAS NV 89120	Date Analyzed: 03/12/2003
Collected: 03/06/2003	Date Reported: 03/12/2003
Project Name/ TONOPAH/PINK MOTEL	EPA Method: EPA 600/M4-82-020
Address: 201 MAIN STREET	Submitted By: ROBERT TROISI
	Collected By: Customer

Lab ID Client ID	Sample Location	Layer Name / Sample Description	Asbestos Detected	Asbestos Type (%)	Non-Asbestos Constituents
0009557-054 B-054	BLDG 5 UNIT 5 UTILITY RM FL	LAYER# 1 12x12 VFT, White/Gray	No		Quartz Carbonates Binder/Filler 100%
		LAYER# 2 Mastic, Yellow	No		Cellulose Fiber 2% Carbonates Binder/Filler 98%
0009557-055 B-055	BLDG 5 UNIT 5 BEDRM CEILING	LAYER# 1 Drywall, White, Brown	No		Cellulose Fiber 10% Quartz Mica Gypsum Carbonates 90%
		LAYER# 2 Joint Compound, White	Yes	Chrysotile 3%	Quartz Mica Carbonates 97%
0009557-056 B-056	BLDG 5 UNIT 7 RESTRM WALL	LAYER# 1 Drywall, White, Brown	No		Cellulose Fiber 10% Quartz Mica Gypsum Carbonates 90%
		LAYER# 2 Joint Compound, White	Yes	Chrysotile 3%	Quartz Mica Carbonates 97%

# EMC LABS, INC.

9830 S. 51st Street, Suite B109, Phoenix, AZ 85044  
 Phone: 800-362-3373 or 480-940-5294 - Fax: (480) 893-1726

Laboratory Report  
**0009557**

## Bulk Asbestos Analysis by Polarized Light Microscopy

NVLAP#101926-0

Client: NINYO & MOORE	Job# / P.O. #: 301218001
Address: 3155 E. PATRICK LANE, STE 12	Date Received: 03/12/2003
LAS VEGAS NV 89120	Date Analyzed: 03/12/2003
Collected: 03/06/2003	Date Reported: 03/12/2003
Project Name/ TONOPAH/PINK MOTEL	EPA Method: EPA 600/M4-82-020
Address: 201 MAIN STREET	Submitted By: ROBERT TROISI
	Collected By: Customer

Lab ID Client ID	Sample Location	Layer Name / Sample Description	Asbestos Detected	Asbestos Type (%)	Non-Asbestos Constituents
0009557-057 B-057	BLDG 5 UNIT 7 RESTRM FL	LAYER# 1 12x12 VFT, White/Gray	No		Quartz Carbonates Binder/Filler 100%
		LAYER# 2 Mastic, Yellow	No		Cellulose Fiber 1% Quartz Carbonates Binder/Filler 99%
0009557-058 B-058	BLDG 5 UNIT 9 BEDRM WALL	LAYER# 1 Drywall, White, Brown	No		Cellulose Fiber 10% Quartz Mica Gypsum Carbonates 90%
		LAYER# 2 Joint Compound, White	Yes	Chrysotile 3%	Quartz Mica Carbonates 97%
0009557-059 B-059	BLDG 5 ROOF	LAYER# 1 Rolled Roofing, Black/Orange/Beige	No		Fibrous Glass 15% Quartz Carbonates Binder/Filler 85%
		LAYER# 2 Rolled Roofing, Black/Gray	Yes	Chrysotile 15%	Carbonates Binder/Filler 85%
		LAYER# 3 Rolled Roofing, Black	No		Cellulose Fiber 60% Carbonates Binder/Filler 40%
0009557-060 B-060	BLDG 5 ROOF	Roofing Mastic, Black	Yes	Chrysotile 10%	Carbonates Binder/Filler 90%

# EMC LABS, INC.

9830 S. 51st Street, Suite B109, Phoenix, AZ 85044  
 Phone: 800-362-3373 or 480-940-5294 - Fax: (480) 893-1726

Laboratory Report  
**0009557**

## Bulk Asbestos Analysis by Polarized Light Microscopy

NVLAP#101926-0

Client: NINYO & MOORE	Job# / P.O. #: 301218001
Address: 3155 E. PATRICK LANE, STE 12	Date Received: 03/12/2003
LAS VEGAS NV 89120	Date Analyzed: 03/12/2003
Collected: 03/06/2003	Date Reported: 03/12/2003
Project Name/ TONOPAH/PINK MOTEL	EPA Method: EPA 600/M4-82-020
Address: 201 MAIN STREET	Submitted By: ROBERT TROISI
	Collected By: Customer

Lab ID Client ID	Sample Location	Layer Name / Sample Description	Asbestos Detected	Asbestos Type (%)	Non-Asbestos Constituents
0009557-061 B-061	BLDG 4 UNIT 48 RESTRM	LAYER# 1 Drywall, White, Brown	No		Cellulose Fiber 10%
		LAYER# 2 Joint Compound, White	No		Quartz Mica Gypsum Carbonates 90%
0009557-062 B-062	BLDG 4 UNIT 48 RESTRM	LAYER# 1 12x12 Vinyl Floor Tile, White/ Gray	No		Carbonates Binder/Filler 100%
		LAYER# 2 Mastic, Tan	No		Quartz Carbonates Binder/Filler 100%
0009557-063 B-063	BLDG 4 UNIT 49 BEDRM	28x16 Ceiling Tile, White/ Tan	No		Cellulose Fiber 90%
					Carbonates Binder/Filler 10%
0009557-064 B-064	BLDG 4 UNIT 49 BEDRM	LAYER# 1 Drywall, Brown/ Off White	No		Cellulose Fiber 10%
		LAYER# 2 Joint Compound, White	No		Quartz Mica Gypsum Carbonates 90%
					Quartz Mica Carbonates 100%

# EMC LABS, INC.

9830 S. 51st Street, Suite B109, Phoenix, AZ 85044  
 Phone: 800-362-3373 or 480-940-5294 - Fax: (480) 893-1726

Laboratory Report  
**0009557**

## Bulk Asbestos Analysis by Polarized Light Microscopy

NVLAP#101926-0

Client:	NINYO & MOORE	Job# / P.O. #:	301218001
Address:	3155 E. PATRICK LANE, STE 12	Date Received:	03/12/2003
	LAS VEGAS NV 89120	Date Analyzed:	03/12/2003
Collected:	03/06/2003	Date Reported:	03/12/2003
Project Name/	TONOPAHA/PINK MOTEL	EPA Method:	EPA 600/M4-82-020
Address:	201 MAIN STREET	Submitted By:	ROBERT TROISI
		Collected By:	Customer

Lab ID Client ID	Sample Location	Layer Name / Sample Description	Asbestos Detected	Asbestos Type (%)	Non-Asbestos Constituents
0009557-065 B-065	BLDG 4 UNIT 50 RESTRM	LAYER# 1 Drywall, Brown/ Off White	No		Cellulose Fiber 10%
		LAYER# 2 Joint Compound, White	No		Quartz Mica Gypsum Carbonates 90%
0009557-066 B-066	BLDG 4 MGRS APT ROOF	LAYER# 1 Asphalt Shingle Roof, Beige, Black	No		Fibrous Glass 15%
		LAYER# 2 Asphalt Shingle Roof/ Felt, Black	No		Quartz Carbonates Binder/Filler 85%
0009557-067 B-067	BLDG 4 MGRS APT ROOF	Roofing Mastic, Black	No		Cellulose Fiber 15%
					Carbonates Binder/Filler 85%
0009557-068 B-068	BLDG 4 MGRS APT ENTRANCE	LAYER# 1 Drywall, Brown/ Off White	No		Cellulose Fiber 10%
		LAYER# 2 Joint Compound, White	Yes	Chrysotile 3%	Quartz Mica Gypsum Carbonates 90%
					Quartz Mica Carbonates Binder/Filler 97%

# EMC LABS, INC.

9830 S. 51st Street, Suite B109, Phoenix, AZ 85044  
 Phone: 800-362-3373 or 480-940-5294 - Fax: (480) 893-1726

Laboratory Report  
**0009557**

## Bulk Asbestos Analysis by Polarized Light Microscopy

NVLAP#101926-0

Client: NINYO & MOORE	Job# / P.O. #: 301218001
Address: 3155 E. PATRICK LANE, STE 12	Date Received: 03/12/2003
LAS VEGAS NV 89120	Date Analyzed: 03/12/2003
Collected: 03/06/2003	Date Reported: 03/12/2003
Project Name/ TONOPAH/PINK MOTEL	EPA Method: EPA 600/M4-82-020
Address: 201 MAIN STREET	Submitted By: ROBERT TROISI
	Collected By: Customer

Lab ID Client ID	Sample Location	Layer Name / Sample Description	Asbestos Detected	Asbestos Type (%)	Non-Asbestos Constituents
0009557-069 B-069	BLDG 4 MGRS APT LIVING RM	Ceiling Tile, White/ Tan/Grooved	No		Cellulose Fiber 90%
					Carbonates Binder/Filler 10%
0009557-070 B-070	BLDG 4 MGRS APT FAMILY RM	LAYER# 1 Vinyl Sheet Flooring, Tan	Yes	Chrysotile 20%	Cellulose Fiber 3%
		LAYER# 2 Mastic, Tan	Yes	Chrysotile 3%	Gypsum Carbonates Binder/Filler 77%
					Cellulose Fiber 2% Carbonates Binder/Filler 95%

*Brad Yanbin Ai*

Analyst - Brad Yanbin Ai

*Kurt Kettler*

Signatory - Lab Director - Kurt Kettler

Distinctly stratified, easily separable layers of samples are analyzed as subsamples of the whole and are reported separately for each discernable layer. All analyses are derived from calibrated visual estimates and measured in weight percent unless otherwise noted. The report applies to the standards or procedures identified and to the sample(s) listed. The test results are not necessarily indicative or representative of the qualities of the lot from which the sample was taken or of apparently identical or similar products, nor do they represent an ongoing quality assurance program unless so noted. These reports are for the exclusive use of the addressed client and that they will not be reproduced wholly or in part for advertising or other purposes over our signature or in connection with our name without special written permission. The report shall not be reproduced except in full, without written approval by our laboratory. The samples not destroyed in testing are retained a maximum of thirty days. The laboratory measurement of uncertainty for the test method is approximately ±1% by weight of Standards and Technology, Voluntary Laboratory Accreditation Program for selected test method for asbestos. The accreditation or any reports generated by this laboratory in no way constitutes or implies product certification, approval, or endorsement by the National Institute of Standards and Technology. The report must not be used by any entity to claim product endorsement by NVLAP or any agency of the U.S. Government. Polarized Light Microscopy may not be consistently reliable in detecting asbestos in floor coverings and similar non-fibrous organically bound materials.

# CHAIN OF CUSTODY

EMC Laboratories  
9830 S. 51<sup>ST</sup> St., Ste B-109  
Phoenix, AZ 85044  
(800) 362-3373 Fax (480) 893-1726

LAB#: 9557  
TAT: Rush  
Rec'd: MAR 12 AM.

COMPANY NAME: NINYO & MOORE  
3155 E. PATRICK LANE, STE 12  
LAS VEGAS, NV 89120  
CONTACT: ROGER GREEN  
Phone/Fax: (702) 433-0330 / (702) 433-0707  
Email: rgreen@ninyoandmoore.com

BILL TO: (If different Location)

**FAXED E-MAILED**  
3/12/03 3/12/03

Now Accepting: VISA - MASTERCARD Price Quoted: \$12<sup>00</sup> / Sample \$ / Layers

COMPLETE ITEMS 1-4: (Failure to complete any items may cause a delay in processing or analyzing your samples)

1. TURNAROUND TIME: [4hr rush] [8hr rush] [1-Day] [2-Day] [3-Day] [5-Day] [6-10 Day]

\*\*\*\*Prior confirmation of turnaround time is required  
\*\*\*\*Additional charges for rush analysis (please call marketing department for pricing details)  
\*\*\*Laboratory analysis may be subject to delay if credit terms are not met

2. TYPE OF ANALYSIS: [Bulk-PLM] [Air-PCM] [Lead] [Point Count]

3. DISPOSAL INSTRUCTIONS: [Dispose of samples at EMC] / [Return samples to me at my expense]  
(If you do not indicate preference, EMC will dispose of samples 60 days from analysis.)

4. Project Name: Tonopah / Pink / Motel - 201 Main St  
P.O. Number: Project Number: 201218001

EMC SAMPLE #	CLIENT SAMPLE #	DATE & TIME SAMPLED	LOCATION/MATERIAL TYPE	Samples Accepted Yes / No	AIR SAMPLE INFO / COMMENTS		
					ON	OFF	FLOW RATE
1	B-001	3/8		Y N			
				Y N			
				Y N			
				Y N			
				Y N			
70	B-070			Y N			
				Y N			
				Y N			
				Y N			
				Y N			
				Y N			
				Y N			
				Y N			

SPECIAL INSTRUCTIONS:

Sample Collector: (Print) \_\_\_\_\_ (Signature) \_\_\_\_\_

Relinquished by: \_\_\_\_\_ Date/Time: \_\_\_\_\_ Received by: Diana Federico Date/Time: 3/12/03

Relinquished by: Diana Federico Date/Time: 3/12/03 Received by: \_\_\_\_\_ Date/Time: 3-12-03

Relinquished by: \_\_\_\_\_ Date/Time \_\_\_\_\_ Received by: \_\_\_\_\_ Date/Time: \_\_\_\_\_

\* In the event of any dispute between the above parties for these services or otherwise, parties agree that jurisdiction and venue will be in Phoenix, Arizona and prevailing party will be entitled to attorney's fees and court costs.

\* 2 extra charges for excessive layers.

# ASBESTOS BULK SAMPLE DATA SHEET

**Ninyo & Moore**  
 3155 East Patrick Lane, Suite 12  
 Las Vegas, Nevada 89120  
 Tel: (702) 433-0330  
 Fax: (702) 433-0707

**Project Name:** TONOPAH/PINK MOTEL  
**Project No.:** 301218001  
**Project Manager:** Robert Trois  
**APN:**  
**Site Address:** 201 MAIN STREET

**Sampled By:** R. Troisi  
**Sampled By:**  
**Sampled By:**  
**Date Sampled:** 3-06-03

**Laboratory:** EMC  
**Tel:**  
**Fax:** RUSH

**CHAIN OF CUSTODY INFORMATION:**

Relinquished By: (signature)	Company	Date	Time (24 hr)	Received By: (signature)	Laboratory		
<i>Robert Trois</i>	Ninyo & Moore	3/11/03	1535	<i>Diana Federico</i>	E. M. C.		
<i>Diana Federico</i>	E. M. C.			<i>Al Yambin</i>	EMC		
LabID	Sample ID	Building Number	Sample Location	Sample Description	Quantity (SF/LF/EA)	Friable (Y/N)	Condition
	B-001	#1	BLDG. #1 UNIT 2 WALL SYSTEM	WALL TEXTURE W/ WALL PLASTER & BOARD		Y	G
	B-002	#1	BLDG. #1 UNIT 2 WALL SYSTEM	JOINT COMPOUND AND WALL PLASTER		N	
	B-003	#1	N.E. CORNER BLDG. #1 EXTERIOR WALL	EXTERIOR STUCCO OVER CONCRETE BRICKS		N	
	B-004	#1	BLDG. #1 UNIT 3 BEDROOM	9"X9" RED BROWN VINYL FLOOR TILE	2,3,4	N	
	B-005	#1	BLDG. #1 UNIT 1 BEDROOM	9"X9" GRAY VINYL FLOOR TILE	1,2	N	
	B-006	#1	BLDG. #1 UNIT 1 BATHROOM	TAN VINYL SHEET FLOORING	1,4	Y	
	B-007	#1	BLDG. #1 UNIT 3 BATHROOM	BROWN VINYL SHEET FLOORING	2,3	Y	
	B-008	#1	BLDG. #1 UNIT 4 WALL SYSTEM	WALL TEXTURE W/ WALL PASTER AND BOARD		Y	
	B-009	#1	BLDG. #1 UNIT 4 SHOWER STAL	SHOWER WALL VENEER W/ MASTIC		N	
	B-010	#1	BLDG. #1 UNIT 3 BATHROOM	CERAMIC TILE W/ MASTIC AROUND TUB		N	
	B-011	#1	S.W. CORNER BLDG. #1 EXTERIOR WALL	EXTERIOR STUCCO OVER CONCRETE BRICKS		N	
	B-012	#1	BLDG. #1 UNIT 3 BATHROOM	JOINT COMPOUND AND WALL PLASTER		N	V

**ASBESTOS BULK SAMPLE DATA SHEET**

**Ninyo & Moore**  
 3155 East Patrick Lane, Suite 12  
 Las Vegas, Nevada 89120  
 Tel: (702) 433-0330  
 Fax: (702) 433-0707

Project Name: TONO PAH / PINK MOTEZ  
 Project No.: 301218001  
 Project Manager: Robert M. Troisi, APN:  
 Site Address: 201 MAIN STREET

Sampled By: R. Troisi / Laboratory: E.M.C.  
 Sampled By:  
 Sampled By:  
 Date Sampled: 3-9-03  
 Tel: **RUSH**  
 Fax:

**CHAIN OF CUSTODY INFORMATION:**

Relinquished By: (signature)		Company	Date	Time (24 hr)	Received By: (signature)	Laboratory		
<i>Robert M. Troisi, Robert Troisi</i>		Ninyo & Moore	3/11/03	1535	Diana Federico	E.M.C.		
<i>Diana Federico, Diana Federico</i>		E.M.C.			<i>Alvan Bin</i>	<i>Emc</i>		
LabID	Sample ID	Building Number	Sample Location		Sample Description	Quantity (SF/LF/EA)	Friable (Y/N)	Condition
	B-013	#2	Bldg. #2 Unit 7 Wall System		Wall texture w/ wall plaster and board		Y	G
	B-014	#2	Bldg. #2 Unit 8 Ceiling		Dry wall and texture		Y	G
	B-015	#2	Bldg. #2 Unit 10 Bathroom		Ceramic tile and mortar		N	G
	B-016	#2	Bldg #2 Unit 9 Bedroom		Dry wall and joint compound		N	G
	B-017	#2	Bldg. #2 Unit 10 Bedroom		Wall texture over wall plaster		Y	G
	B-018	#3	Bldg. #3 Office Kitchen Area		Brown/Tan vinyl sheet flooring		Y	G
	B-019	#3	Bldg. #3 Unit 19 Bedroom		Dry wall, joint compound & texture	SEPARATION WALLS ONLY	N	D
	B-020	#3	Bldg. #3 Unit 19 Bedroom		Ceiling tile solid front		Y	D
	B-021	#3	Bldg. #3 Unit 28 Bedroom		Dry wall, joint compound		N	D
	B-022	#3	Bldg. #3 Unit 28 Bedroom		Ceiling tile		Y	D
	B-023	#3	Bldg #3 Unit 20 Restroom		Tan/white vinyl sheet flooring		Y	G
	B-024	#3	Bldg #3 Unit 20 Bedroom		Ceiling tile with holes		Y	D



# ASBESTOS BULK SAMPLE DATA SHEET

Project Name: <b>TANOPAH/PINK MDR</b> Project No.: <b>301218001</b> Project Manager: <b>Robert Troisi</b> APN: Site Address: <b>201 MAIN STREET</b>	Sampled By: <b>R. Troisi</b> Sampled By: Sampled By: Date Sampled: <b>3-07-03</b>	Laboratory: <b>EMC</b> Tel: Fax:
---	--	--

Relinquished By: (signature)		Company	Date	Time (24 hr)	Received By: (signature)	Laboratory		
<i>Robert Troisi</i>		Ninyo & Moore	3/11/03	1535	Diana Federico, DIANA FEDERICO	E.M.C.		
<i>Diana Federico</i>		E.M.C.			<i>Allen</i> , ALYANBIN	EMC		
LabID	Sample ID	Building Number	Sample Location		Sample Description	Quantity (SF/LF/EA)	Friable (Y/N)	Condition
	B-025	#3	BLOG. #3 OFFICE MAIN OFFICE		9"X9" Brown vinyl floor tile x mastic		N	G
	B-026	#3	BLOG. #3 UNIT 18 RESTROOM		12"X12" White/Gray VINYL FLOOR TILE		N	G
	B-027	#3	BLOG. #3 UNIT 19 RESTROOM		White/Gray VINYL FLOOR TILE		N	G
	B-028	#3	BLOG. #3 UNIT 27 RESTROOM		White/GOLD VINYL FLOOR TILE OVER TAN/GOLD VINYL SHEET FLOORING		Y	G
	B-029	#3	BLOG. #3 UNIT 17 RESTROOM		BROWN SQUARE VINYL SHEET FLOORING		Y	G
	B-030	#3	BLOG. #3 UNIT 12 BED ROOM		White textured CEILING tile		Y	D
	B-031	#3	BLOG. #3 UNIT 12 RESTROOM		BROWN VINYL SHEET FLOORING OVER PALE GREEN VINYL SHEET FLOORING		Y	G
	B-032	#3	BLOG. #3 UNIT 23 RESTROOM		White speckle VINYL SHEET FLOORING		Y	G
	B-033	#3	BLOG. #3 UNIT 23 BED ROOM		White ceiling tile with holes		Y	D
	B-034	#4	BLOG. #4 UNIT 35 BED ROOM		28"X16" white ceiling tile		Y	D
	B-035	#4	BLOG. #4 UNIT 35 RESTROOM		drywall, joint compound		N	D
	B-036	#4	BLOG. #4 UNIT 35 RESTROOM		12"X12" GRAY VINYL floor tile		N	G

CHAIN OF CUSTODY INFORMATION:

# ASBESTOS BULK SAMPLE DATA SHEET

**Project Name:** TD No PAA / PINK METER  
**Project No.:** 301218001  
**Project Manager:** Robert Trevisi  
**APN:**  
**Site Address:** 201 MAIN STREET  
**Sampled By:** R. Trevisi  
**Sampled By:**  
**Sampled By:**  
**Date Sampled:** 3-07-03  
**3-08-03**  
**Laboratory:** EMC  
**Tel:**  
**Fax:**

**CHAIN OF CUSTODY INFORMATION:**

Relinquished By: (signature)	Company	Date	Time (24 hr)	Received By: (signature)	Laboratory		
<i>Robert Trevisi</i>	Ninyo & Moore	3/11/03	1535	<i>Diana Federico</i>	E. M. C.		
<i>Diana Federico</i>	E. M. C.			<i>Robert Trevisi</i>	EMC		
LabID	Sample ID	Building Number	Sample Location	Sample Description	Quantity (SF/LF/EA)	Friable (Y/N)	Condition
	B-037	#4	Bldg. #4 Unit 38 Restroom ceiling	dry wall, joint compound		N	D
	B-038	#4	Bldg. #4 Unit 38 Restroom	12" x 12" gray tile vinyl floor tile		N	G
	B-039	#4	Bldg. #4 Unit 39 Bedroom	12" x 12" white textured ceiling tile		Y	D
	B-040	#4	Bldg. #4 Unit 39 Restroom ceiling	joint compound + texture		Y	D
	B-041	#2	Bldg. #2 Unit 10 Bedroom ceiling	dry wall + texture		Y	D
	B-042	#2	Bldg. #2 Roof	ROLL-ON ROOF		N	G
	B-043	#2	Bldg. #2 Roof	ROOFING MASTIC		N	
	B-044	#2	Bldg. #2 Roof	VENT PIPE		N	
	B-045	#2	Bldg. #2 AWNING ROOF	Asphalt shingle		N	
	B-046	Pool	Pool steps	Pool wall material		N	
	B-047	Pool	Pool concrete edging	Pool edge near steps		N	
	B-048	Pool	Pool house roof	Asphalt shingle		N	V

# ASBESTOS BULK SAMPLE DATA SHEET

**Ninyo & Moore**  
 3155 East Patrick Lane, Suite 12  
 Las Vegas, Nevada 89120  
 Tel: (702) 433-0330  
 Fax: (702) 433-0707

**Project Name:** TONOFAH / PINK MOTEZ  
**Project No.:** 3012/8001  
**Project Manager:** Robert Trevisi  
**APN:**  
**Site Address:** 201 MAIN STREET

**Sampled By:** R. Trevisi  
**Sampled By:**  
**Sampled By:**  
**Date Sampled:** 3/08/03

**Laboratory:** EMC  
**Tel:**  
**Fax:** RUSH

**CHAIN OF CUSTODY INFORMATION:**

Relinquished By: (signature/print)	Company	Date	Time (24 hr)	Received By: (signature/print)	Laboratory		
Robert Trevisi	Ninyo & Moore	3/11/03	1535	Diana Federico	E.M.C.		
Diana Federico	E.M.C.			Ali Yambin	EMC		
LabID	Sample ID	Building Number	Sample Location	Sample Description	Quantity (SF/LF/EA)	Friable (Y/N)	Condition
	B-049	#5	Bldg. #5 MECHANICAL ROOM ROOF	ROLL-ON ROOF		N	G
	B-050	#5	Bldg. #5 UNIT 3 BEDROOM WALL	Dry wall, joint compound		N	G
	B-051	#5	Bldg. #5 UNIT 3 UTILITY ROOM FLOOR	12" x 12" White/gray VINYL FLOOR TILE		N	
	B-052	#5	Bldg. #5 UNIT 3 RESTROOM SHOWER WALL	CERAMIC TILE AND MORTAR		N	
	B-053	#5	Bldg. #5 UNIT 5 BEDROOM WALL	Drywall, joint compound		N	
	B-054	#5	Bldg. #5 UNIT 5 UTILITY ROOM FLOOR	12" x 12" White/gray floor tile		N	
	B-055	#5	Bldg. #5 UNIT 5 BEDROOM CEILING	Dry wall, joint compound		N	
	B-056	#5	Bldg. #5 UNIT 7 RESTROOM WALL	Drywall, joint compound		N	
	B-057	#5	Bldg. #5 UNIT 7 RESTROOM FLOOR	12" x 12" White/gray floor tile		N	
	B-058	#5	Bldg. #5 UNIT 9 BEDROOM WALL	Dry wall, joint compound		N	
	B-059	#5	Bldg. 5 ROOF	ROLL-ON ROOF		N	
	B-060	#5	Bldg. 5 ROOF	ROOFING MASTIC		N	

# ASBESTOS BULK SAMPLE DATA SHEET

**Ninyo & Moore**  
 3155 East Patrick Lane, Suite 12  
 Las Vegas, Nevada 89120  
 Tel: (702) 433-0330  
 Fax: (702) 433-0707

**Project Name:** TANDRAH / PINK MOTEZ  
**Project No.:** 301218001  
**Project Manager:** Robert M. Treasi  
**APN:**  
**Site Address:** 201 MAIN STREET

**Sampled By:** R. Treasi  
**Sampled By:**  
**Sampled By:**  
**Date Sampled:** 03/08/03

**Laboratory:** EMC  
**Tel:**  
**Fax:**

**RUSH**

## CHAIN OF CUSTODY INFORMATION:

LabID	Sample ID	Building Number	Company	Date	Time (24 hr)	Received By: (signature)	Laboratory
			Ninyo & Moore	3/4/03	1535	Diana Federico	E. M. C.
			E. M. C.			Physis - ALYANBIK	Emc
Sample ID	Building Number	Sample Location	Sample Description	Quantity (SF/LF/EA)	Friable (Y/N)	Condition	
B-061	#4	Building #4 Unit 48 Restroom	dry wall and joint compound		N	D	
B-062	#4	Bldg. #4 Unit 48 Restroom	12" x 12" white/grey vinyl floor tile		N	G	
B-063	#4	Bldg. #4 Unit 49 Bedroom	28" x 16" white ceiling tile		Y	D	
B-064	#4	Bldg. #4 Unit 49 Restroom	drywall and joint compound		N	D	
B-065	#4	Bldg. #4 Unit 50 Restroom	drywall and joint compound		N	D	
B-066	#4	Bldg. #4 MGRS APT. ROOF	Asphalt Shingle Roof		N	G	
B-067	#4	Bldg. #4 MGRS APT. ROOF	Roofing mastic		N	G	
B-068	#4	Bldg. #4 mgrs. Apt. ENTRANCE	drywall + joint compound		N	D	
B-069	#4	Bldg. #4 mgrs. Apt. Living Room	White grooved ceiling tile		Y	D	
B-070	#4	Bldg. #4 mgrs. Apt. family Room	STAN BINGL SHEET FLOORING		Y	G	

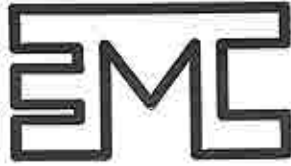

EMC LABS, INC.

9830 South 51<sup>st</sup> Street, Suite B-109 / PHOENIX, ARIZONA 85044 / 480-940-5294 or 800-362-3373 / FAX 480-893-1726  
emclab@emclabs.com

**LEAD (Pb) IN PAINT CHIP SAMPLES**  
EMC SOP METHOD #L01/1 EPA SW-846 METHOD 7420

<b>EMC LAB #:</b> L23335	<b>DATE RECEIVED:</b> 03/13/03
<b>CLIENT:</b> Ninyo & Moore	<b>REPORT DATE:</b> 03/13/03
	<b>DATE OF ANALYSIS:</b> 03/13/03
<b>CLIENT ADDRESS:</b> 3155 E. Patrick Lane., Ste 12 Las Vegas, NV 89120	<b>P.O. NO.:</b>
<b>PROJECT NAME:</b> Tonopah/Pink Motel 201 Main Street	<b>PROJECT NO.:</b> 301218001

EMC # L23335-	SAMPLE DATE /03	CLIENT SAMPLE #	DESCRIPTION	REPORTING LIMIT IN PPM	Pb IN PPM
1	03/12	PC-001	Bldg. 1-Unit 2-Tan/2/Plaster	100	1487
2	03/12	PC-002	Bldg. 1-Unit 5-Blue/2/Wood	100	2662
3	03/12	PC-003	Bldg. 1-SE Corner-Pink/2/Stucco	100	BRL *
4	03/12	PC-004	Bldg. 1-Exterior Unit 1-Dark Gray/2/Wood	100	131
5	03/12	PC-005	Bldg. 2-Exterior Unit 10-Light Blue/2/Wood	100	BRL
6	03/12	PC-006	Bldg. 3-Exterior Under Balcony-White/2/Wood	100	BRL
7	03/12	PC-007	2 <sup>nd</sup> Floor-Bldg. 3-Exterior Balcony Ceiling-White/2/Wood	100	119
8	03/12	PC-008	Bldg. 4-Unit 34-Restroom-White/2/Drywall	100	BRL
9	03/12	PC-009	Bldg. 4-Unit 35-Exterior-Blue/2/Wood	100	788
10	03/12	PC-010	Bldg. 4-Unit 36-Exterior-Pink/2/Wood	100	193

^ = Dilution Factor Changed      Ins. = Insufficient Sample for Analysis      \* = Excessive Substrate May Bias Sample Results      BRL = Below Reportable Limits

This report applies to the standards or procedures identified and to the samples tested only. The test results are not necessarily indicative or representative of the qualities of the lot from which the sample was taken or of apparently identical or similar products, nor do they represent an ongoing quality assurance program unless so noted.

Where it is noted that a sample with excessive substrate was submitted for laboratory analysis, such analysis may be biased. The lead content of such sample may, in actuality, be greater than reported. EMC makes no warranty, express or implied, as to the accuracy of the analysis of samples noted to have been submitted with excessive substrate. Resampling is recommended in such situations to verify original laboratory results.

These reports are for the exclusive use of the addressed client and are rendered upon the condition that they will not be reproduced wholly or in part for advertising or other purposes over our signature or in connection with our name without special written permission. Samples not destroyed in testing are retained a maximum of sixty (60) days.

ANALYST: Mark A. Rodocker  
Mark A. Rodocker

QA COORDINATOR: Kurt Kettler  
Kurt Kettler



9830 South 51<sup>st</sup> Street, Suite B-109 / PHOENIX, ARIZONA 85044 / 480-940-5294 or 800-362-3373 / FAX 480-893-1726  
emclab@emclabs.com

**LEAD (Pb) IN PAINT CHIP SAMPLES**  
EMC SOP METHOD #L01/1 EPA SW-846 METHOD 7420

<b>EMC LAB #:</b> L23335	<b>DATE RECEIVED:</b> 03/13/03
<b>CLIENT:</b> Ninyo & Moore	<b>REPORT DATE:</b> 03/13/03
	<b>DATE OF ANALYSIS:</b> 03/13/03
<b>CLIENT ADDRESS:</b> 3155 E. Patrick Lane., Ste 12 Las Vegas, NV 89120	<b>P.O. NO.:</b>
<b>PROJECT NAME:</b> Tonopah/Pink Motel 201 Main Street	<b>PROJECT NO.:</b> 301218001

EMC # L23335-	SAMPLE DATE /03	CLIENT SAMPLE #	DESCRIPTION	REPORTING LIMIT IN PPM	Pb IN PPM
11	03/12	PC-011	Bldg. 4-Unit 37-Exterior-White/2/Wood	100	BRL
12	03/12	PC-012	Bldg. 3-Stair Railing-White/2/Metal	100	BRL
13	03/12	PC-013	Pool Siding-SE Corner-Blue/2/Concrete	100	558
14	03/12	PC-014	Bldg. 5-Unit 6-Pink/2/Wood	100	994
15	03/12	PC-015	Bldg. 5-Unit 6-Blue/2/Wood	100	405
16	03/12	PC-016	Bldg. 5-Unit 4-Dark Blue/2/Wood	100	279
17	03/12	PC-017	Bldg. 4-Unit 43-Pink/2/Wood	100	195
18	03/12	PC-018	Bldg. 4-Unit 44-Blue/2/Wood	100	BRL
19	03/12	PC-019	Bldg. 4-Unit 45-White/2/Wood	100	1124

^ = Dilution Factor Changed      Ins. = Insufficient Sample for Analysis      \* = Excessive Substrate May Bias Sample Results      BRL = Below Reportable Limits

This report applies to the standards or procedures identified and to the samples tested only. The test results are not necessarily indicative or representative of the qualities of the lot from which the sample was taken or of apparently identical or similar products, nor do they represent an ongoing quality assurance program unless so noted.

Where it is noted that a sample with excessive substrate was submitted for laboratory analysis, such analysis may be biased. The lead content of such sample may, in actuality, be greater than reported. EMC makes no warranty, express or implied, as to the accuracy of the analysis of samples noted to have been submitted with excessive substrate. Resampling is recommended in such situations to verify original laboratory results.

These reports are for the exclusive use of the addressed client and are rendered upon the condition that they will not be reproduced wholly or in part for advertising or other purposes over our signature or in connection with our name without special written permission. Samples not destroyed in testing are retained a maximum of sixty (60) days.

**ANALYST:** Mark A. Rodocker  
Mark A. Rodocker

**QA COORDINATOR:** Kurt Kettler  
Kurt Kettler

# CHAIN OF CUSTODY

EMC Laboratories  
 9830 S. 51<sup>ST</sup> St., Ste B-109  
 Phoenix, AZ 85044  
 (800) 362-3373 Fax (480) 893-1726

LAB#: 223335  
 TAT: Rush  
 Rec'd: MAR 13 AM

COMPANY NAME: NINYO & MOORE  
3155 E. Patrick Lane, Ste 12  
Las Vegas, NV 89120  
 CONTACT: Cynthia Bogdan  
 Phone/Fax: (702) 433-0330 / (702) 433-0707  
 Email: cbogdan@ninyoandmoore.com

BILL TO: \_\_\_\_\_ (If Different Location)

**E-MAILED**  
**SAVED**  
**3/13/03**

Now Accepting: **VISA - MASTERCARD** Price Quoted: \$ \_\_\_\_\_ / Sample \$ \_\_\_\_\_ / Layers

**COMPLETE ITEMS 1-4:** (Failure to complete any items may cause a delay in processing or analyzing your samples)

1. **TURNAROUND TIME:** [4hr rush] [8hr rush] [1-Day] [2-Day] [3-Day] [5-Day] [6-10 Day]

\*\*\*\* Prior confirmation of turnaround time is required  
 \*\*\*\* Additional charges for rush analysis (please call marketing department for pricing details)  
 \*\*\* Laboratory analysis may be subject to delay if credit terms are not met

2. **TYPE OF ANALYSIS:** [Bulk-PLM] [Air-PCM] [Lead] [Point Count] [Fungi: AOC, W-C, Bulk, Swab, Tape]

3. **DISPOSAL INSTRUCTIONS:** [Dispose of samples at EMC] [Return samples to me at my expense]  
 (If you do not indicate preference, EMC will dispose of samples 60 days from analysis.)

4. **Project Name:** Tonopah / Pink Motel 201 Main Street  
**P.O. Number:** \_\_\_\_\_ **Project Number:** 30121800

EMC SAMPLE #	CLIENT SAMPLE #	DATE & TIME SAMPLED	LOCATION/MATERIAL TYPE	Samples Accepted		AIR SAMPLE INFO / COMMENTS		
				Yes	No	ON	OFF	FLOW RATE
	<u>PC-001</u>	<u>3-12-03</u>	<u>Lead</u>	<u>Y</u>	<u>N</u>			
				<u>Y</u>	<u>N</u>			
				<u>Y</u>	<u>N</u>			
				<u>Y</u>	<u>N</u>			
<u>19</u>	<u>PC-019</u>			<u>Y</u>	<u>N</u>			
				<u>Y</u>	<u>N</u>			
				<u>Y</u>	<u>N</u>			
				<u>Y</u>	<u>N</u>			
				<u>Y</u>	<u>N</u>			
				<u>Y</u>	<u>N</u>			
				<u>Y</u>	<u>N</u>			
				<u>Y</u>	<u>N</u>			
				<u>Y</u>	<u>N</u>			

SPECIAL INSTRUCTIONS: \_\_\_\_\_

Sample Collector: (Print) \_\_\_\_\_ (Signature) \_\_\_\_\_  
 Relinquished by: \_\_\_\_\_ Date/Time: \_\_\_\_\_ Received by: Diana Fedunia Date/Time: 3/13/03  
 Relinquished by: Diana Fedunia Date/Time: 3/13/03 Received by: Alor... Date/Time: 03/13/03  
 Relinquished by: Alor... Date/Time: 03/13/03 Received by: \_\_\_\_\_ Date/Time: \_\_\_\_\_

\*\* In the event of any dispute between the above parties for these services or otherwise, parties agree that jurisdiction and venue will be in Phoenix, Arizona and prevailing party will be entitled to attorney's fees and court costs.

# LEAD BASED PAINT BULK SAMPLE DATA SHEET

**Ninyo & Moore**  
 3155 East Patrick Lane, Suite 12  
 Las Vegas, Nevada 89120  
 Tel: (702) 433-0330  
 Fax: (702) 433-0707

**Project Name:** Tomopah / Pink Mated  
**Project No.:** 301218001  
**Project Manager:** Robert M. Troisi  
**APN:**  
**Site Address:** 201 MAIN STREET

**Sampled By:** Robert M. Troisi  
**Sampled By:**  
**Sampled By:**  
**Date Sampled:** 3/06/03 thru 3/08/03

**Laboratory:** EMC  
**Tel:** **RUS64**  
**Fax:**

**CHAIN OF CUSTODY INFORMATION:**

Relinquished By: (sign/print)	Company	Date	Time (24 hr)	Received By: (sign/print)	Laboratory
Robert M. Troisi	Ninyo & Moore	3/12/03	1545	Oliver Trevino	
Oliver Trevino	EMC	3-13-03			

LabID	Sample ID	Building Number	Sample Location	Building Component	Sample Description / # Layers / Substrate	Color	Estimated Surface Area	Condition
1	PC-001	#1	Bldg. #1 Unit 2	walls ceiling	TAN / 2 / PLASTER			INTACT
2	PC-002	#1	Bldg. #1 Unit 5	DOOR	BLUE / 2 / WOOD			PEELING
3	PC-003	#1	Bldg. #1 SE. CORNER	EXTERIOR WALLS	PINK / 2 / STUCCO			PEELING
4	PC-004	#1	Bldg. #1 EXTERIOR UNIT 1	WINDOW SILL	DARK GRAY / 2 / WOOD			peeling
5	PC-005	#2	Bldg. #2 EXTERIOR UNIT 10	WINDOW SILL	LIGHT BLUE / 2 / WOOD			peeling
6	PC-006	#3	Bldg. #3 EXTERIOR UNDER BALCONY	UNDER BALCONY	White / 2 / wood			peeling
7	PC-007	#3	2ND FLOOR BLDG. #3 EXTERIOR BALCONY ceiling	BALCONY CEILING	White / 2 / wood			peeling
8	PC-008	#4	Bldg. #4 UNIT # 34 RESTROOM	INTERIOR WALL	White / 2 / drywall			peeling
9	PC-009	#4	Bldg. #4 UNIT # 35 EXTERIOR	SUPPORT POST	blue / 2 / wood			peeling
10	PC-010	#4	Bldg. #4 UNIT 36 EXTERIOR	EXTERIOR WALL	Pink / 2 / wood			peeling
11	PC-011	#4	Bldg. #4 UNIT # 37 EXTERIOR	EXTERIOR DOOR	White / 2 / wood			peeling
12	PC-012	#3	Bldg. #3 STAIR RAILING	STAIR RAILING	White / 2 / metal			peeling



# LEAD BASED PAINT BULK SAMPLE DATA SHEET

<b>Ninyo &amp; Moore</b> 3155 East Patrick Lane, Suite 12 Las Vegas, Nevada 89120 Tel: (702) 433-0330 Fax: (702) 433-0707	Project Name: <b>Tonopah / Pink Motel</b> Project No.: <b>201218001</b> Project Manager: <b>Robert M. Troisi</b> APN: Site Address: <b>201 MAIN STREET</b>	Sampled By: <b>Robert M. Troisi</b> Sampled By: Sampled By: Date Sampled: <b>03/06/03 thru 03/08/03</b>	Laboratory: <b>EMC</b> Tel: Fax:
---	--	--	--

**RUSH**

Relinquished By (signature)		Company	Date	Time (24-hr)	Received By (signature)		Laboratory	
<i>Robert M. Troisi</i>		Ninyo & Moore	3/2/03	1545	<i>Vanja Tedesco</i>			
<i>Vanja Tedesco</i>		EMC	3/3/03					
LabID	Sample ID	Building Number	Sample Location	Building Component	Sample Description # Layers/Substrate	Color	Estimated Surface Area	Condition
13	PC-013	Pool	Pool Siding	Pool Walls	blue / 2/concrete			Peeling
14	PC-014	#5	S.E. CORNER	EXTERIOR SIDING	pink / 2/wood			
15	PC-015	#5	BLDG. #5 UNIT 6	DOOR	blue / 2/wood			
16	PC-016	#5	BLDG. #5 UNIT 4	DOOR FRAME	dark blue / 2/wood			
17	PC-017	#4	BLDG. #4 UNIT 43	EXTERIOR SIDING	pink / 2/wood			
18	PC-018	#4	BLDG. #4 UNIT 44	DOOR FRAME	blue / 2/wood			
19	PC-019	#4	BLDG. #4 UNIT 45	RAILING	white / 2/wood			↓